

Using Ward Chromebooks



-J.Shields

This is a chromebook.
It is a web-based computer.



When you open the lid, they automatically turn on.

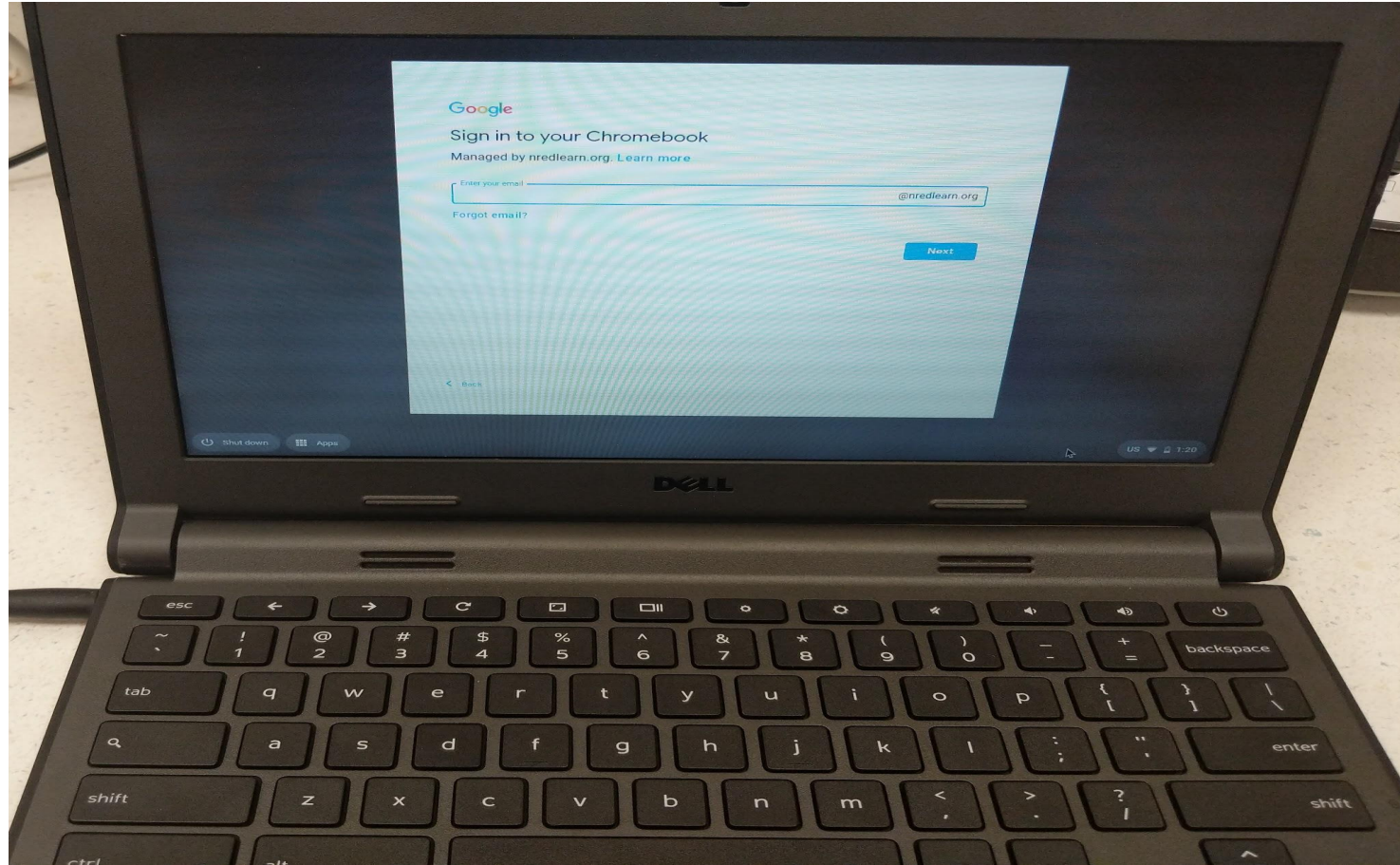

If charged and it does not power on, you may need to press the power button.

Style A: (keyboard button)

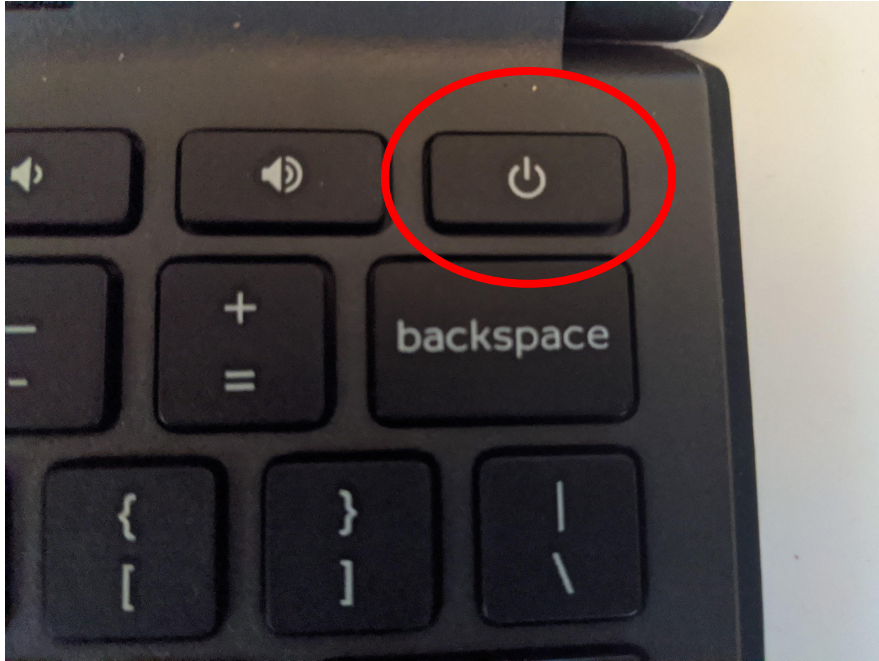

Style B: (on side)

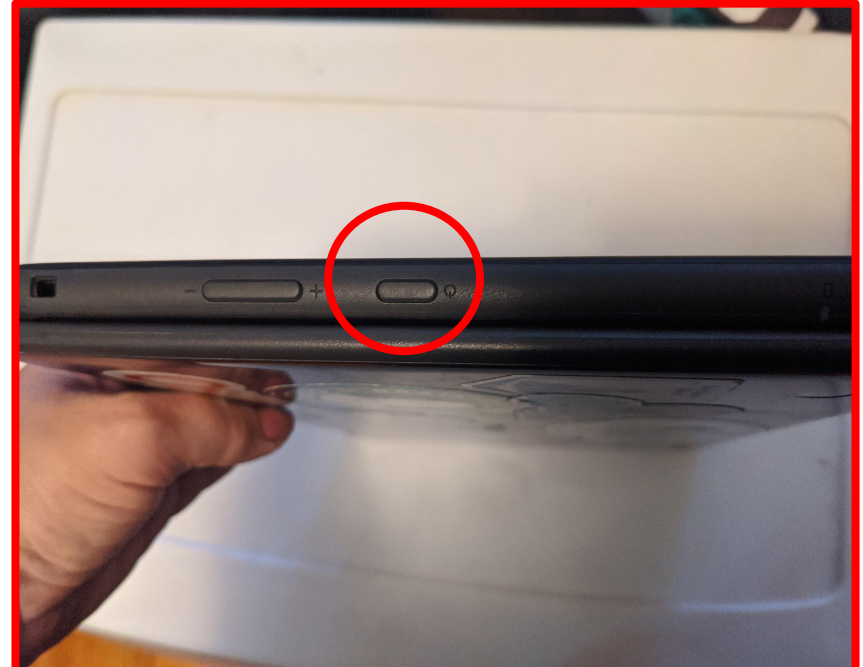

You may need to connect to your home wifi.
Click the wifi icon in the bottom right corner of your
chromebook screen

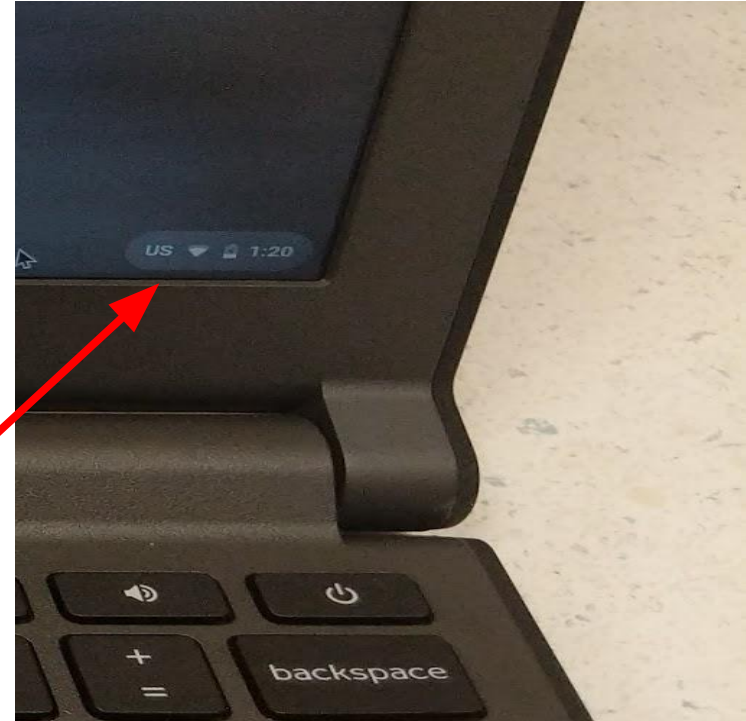
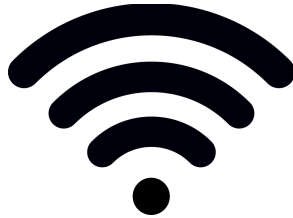
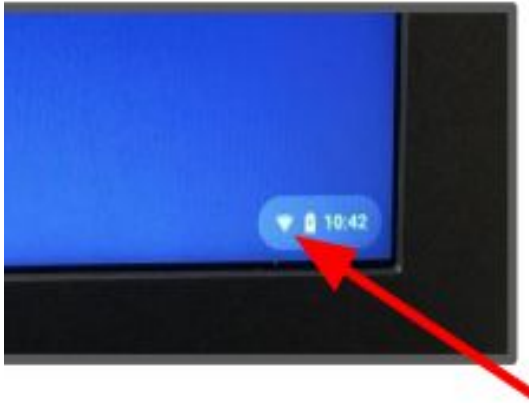

Choose the correct wifi (Wireless Internet) you have access to at home. You may need to type in a password from your wifi settings.

Connecting to a wifi network...

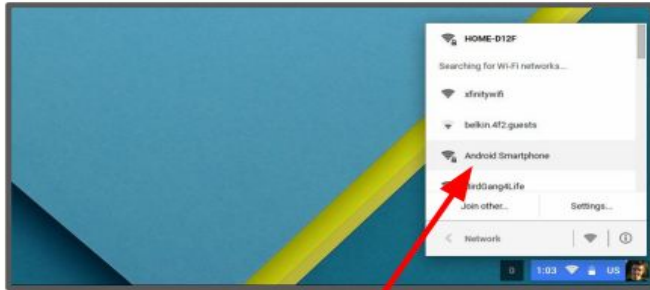

Select a wifi network

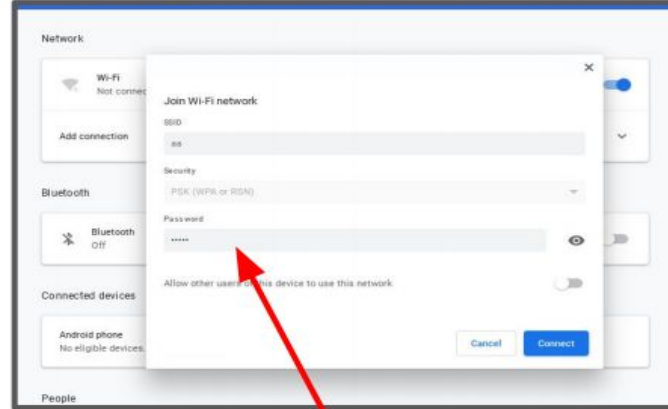

Type in the password and click on Connect

Login to tell the chromebook who you are.



Sign in to your Chromebook

Managed by nredlearn.org. [Learn more](#)

Enter your email

| @nredlearn.org

[Forgot email?](#)

Next

< [Back](#)

Remember only
school district
provided
@nredlearn.org
emails can sign
into district owned
chromebooks.



Sign in to your Chromebook
with your Google Account. [Learn more](#)

Enter your email

@nredlearn.org

[More options](#)

Then click "NEXT".

NEXT

[← Back](#)

[Next →](#)

Enter your password and click “NEXT”.

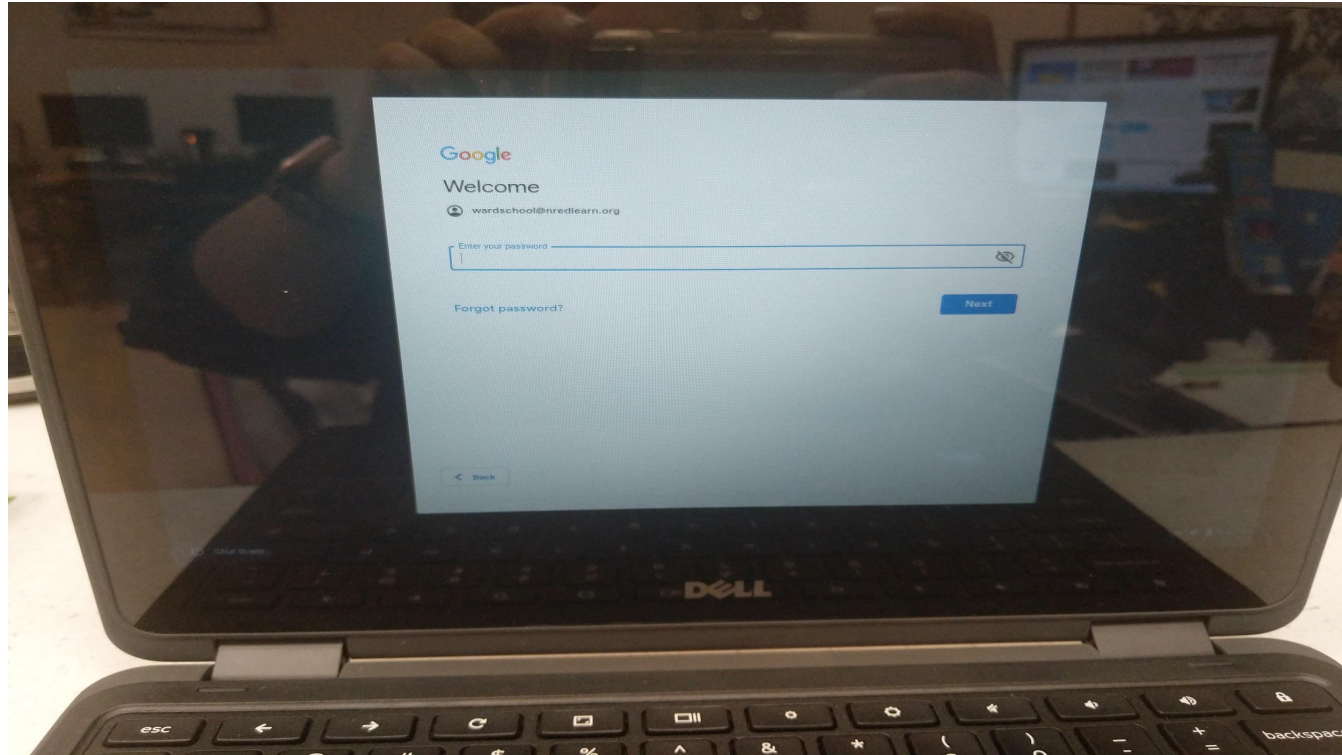

Passwords are like toothbrushes.
Don't share them, even with friends.

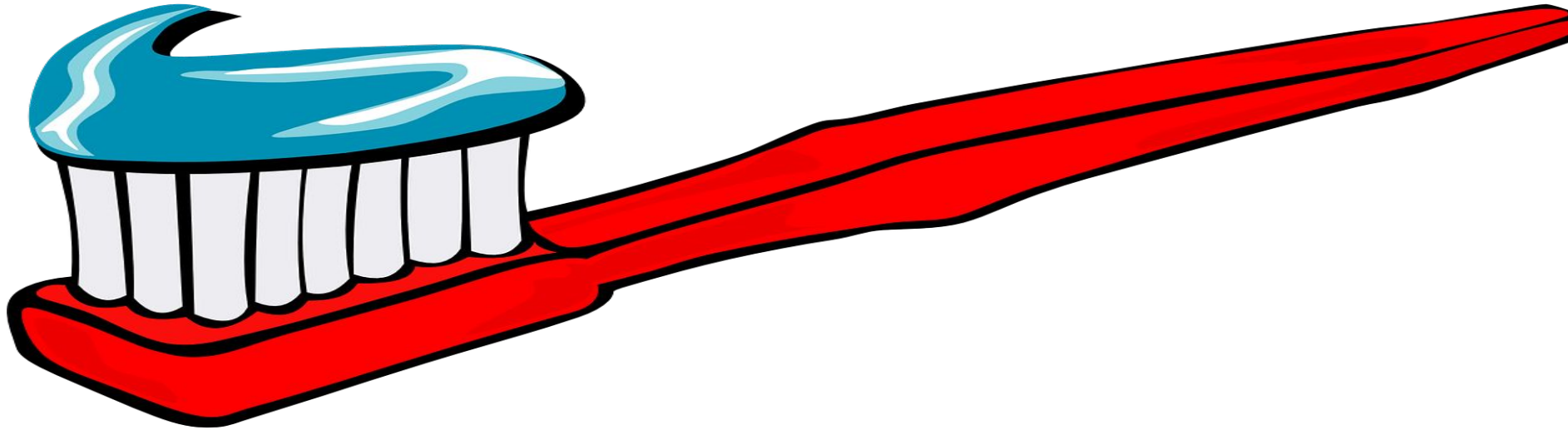

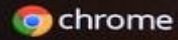

School Accounts

For school work only



Everything we do is saved and recorded to keep us safe.

Remember...

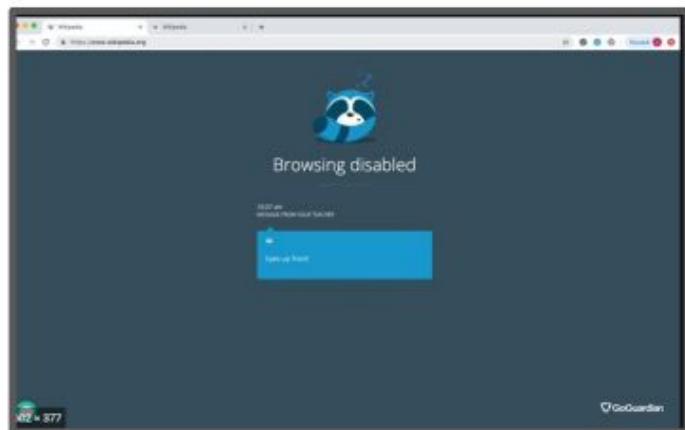

The **filters** you have at school will still be active when the Chromebook is at home... even though you are on another network. **Goguardian** is still active also.

Our school website, ward.nred.org should load automatically.

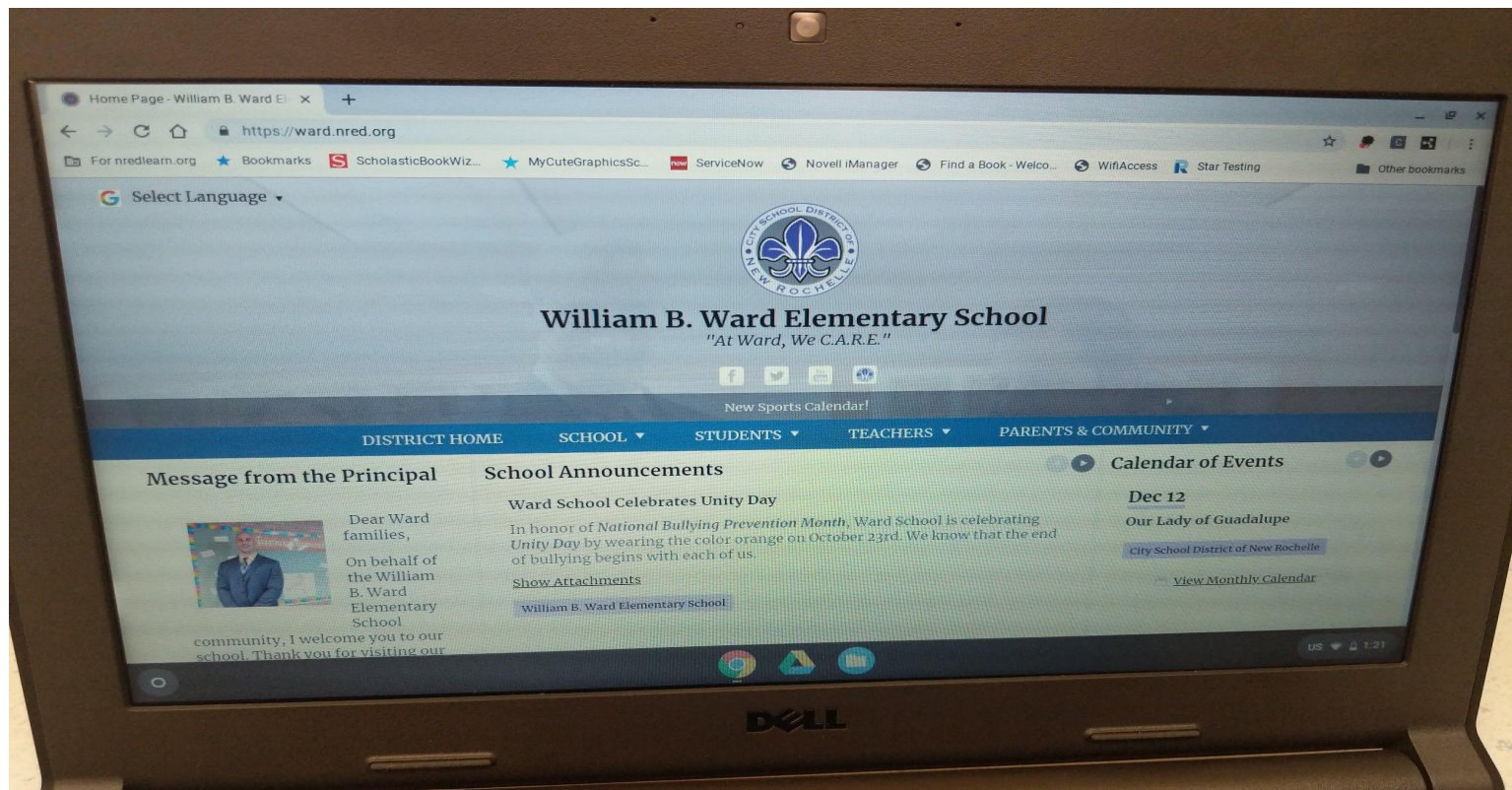

If the school district page, <http://nred.org> loads instead, just visit <http://ward.nred.org> to reach our school website.



Under the “Students” tab, click on “Google Classroom”

Select Language ▼



William B. Ward Elementary School

"At Ward, We C.A.R.E."

f t y v

New Sports Calendar!

DISTRICT HOME SCHOOL ▼ STUDENTS ▲ TEACHERS ▼ PARENTS & COMMUNITY ▼

Message from the Principal



Dear Ward families,

On behalf of the William B. Ward Elementary School

community, I welcome you to our school. Thank you for visiting our website and taking the time to

[Read More](#)

School Announcements

Ward School Celebrates

In honor of *National Bullying Prevention Month* by wearing of bullying begins with

[Show Attachments](#)

William B. Ward Elementary School

2019 Hour of Code Participation

- Dreambox (Ward)
- BrainPOP
- BrainPOP Junior
- Google Classroom**
- Google Docs NREDEarn
- Student Handbook
- Elementary School Code of Conduct ▼
- Ward Library Catalog
- Discovery Education
- Bookflix
- Raz Kids

Calendar of Events

◀ ▶

Dec 12

Our Lady of Guadalupe

Quick Links

[Anonymous Report...](#)



[School Menus](#)



[Boys' & Girls' Club](#)



[NREDEarn](#)

Highlights



Please find **Google Classroom** from the list under **Students**.

Or from [google.com](https://www.google.com) click the app launcher (9 squares) and click “Classroom” from the list.

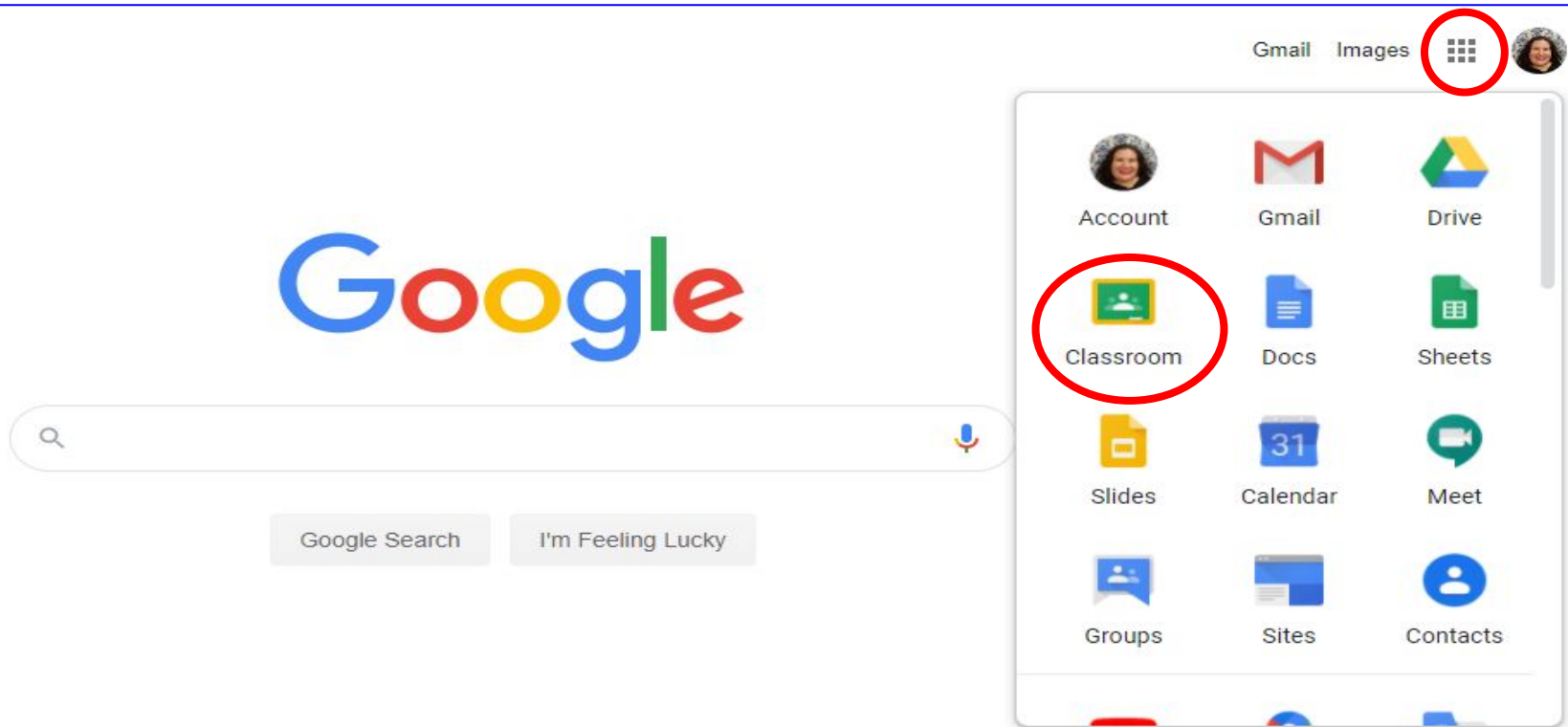

Or type classroom.google.com in your Google Chrome Browser.



After signing into Google Classroom, you will see thumbnails (small images) for any classes that the student is a part of on the screen.

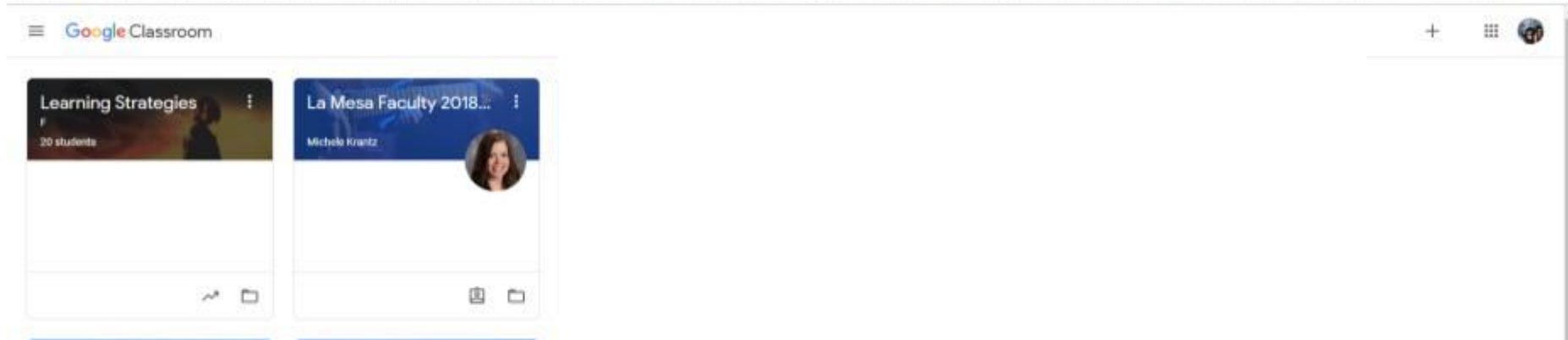

If you are invited to a new Google Classroom, click the “Join” button to accept the invitation.

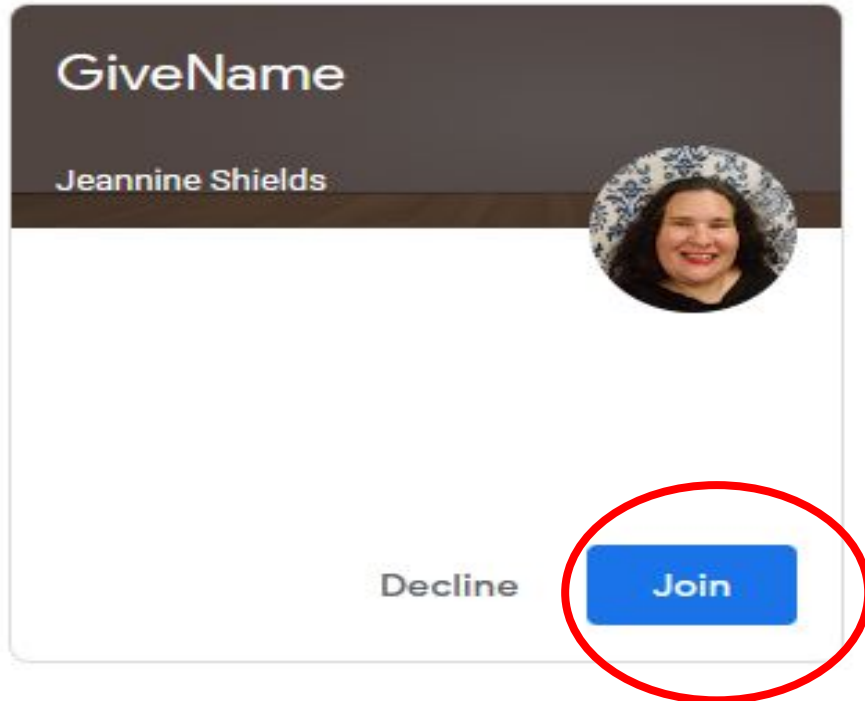

Click on the Google Classroom you would like to view.

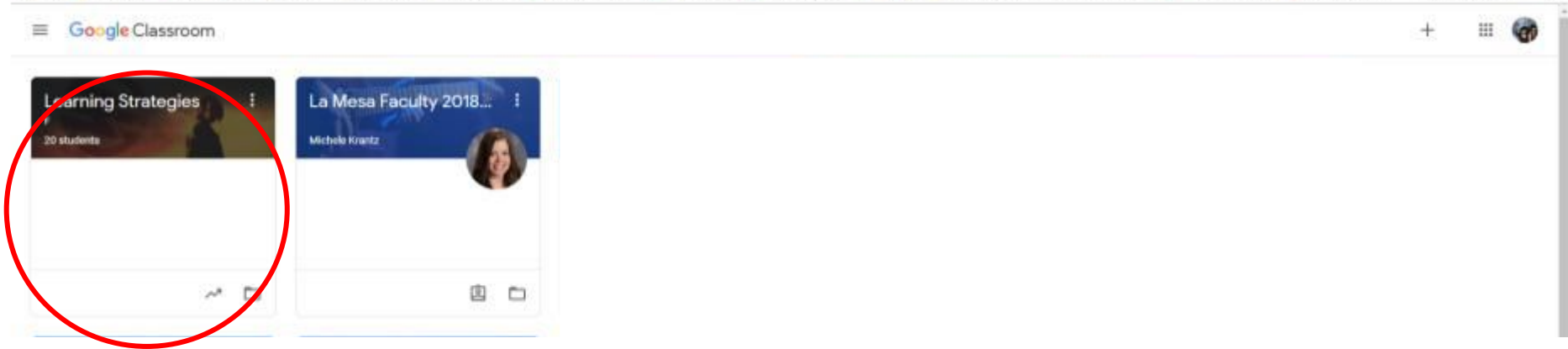

Your teacher's assignment may be a post (message):



Your teacher's assignment may have attachments:



Need help with a District provided Chromebook:

Q: I am having trouble with a district-issued Chromebook. What can I do?

A: Our partners at the Lower Hudson Regional Information Center (LHRIC) are providing a service to assist users of our district Chromebooks. Anyone who needs technical support with their Chromebook, must fill out a simple form for each request. This form is accessed by the following link: <https://lhric.service-now.com/student>. A field engineer will respond and assist as needed.