

KLSD
JOHN JAY HIGH SCHOOL

60 NORTH SALEM ROAD
CROSS RIVER, NY 10518

S.E.D. LEAD TESTING
2021

BETTER WATER WELLS SYSTEMS, INC.
348 SMITH RIDGE ROAD
SOUTH SALEM, NY 10590
914-533-6814

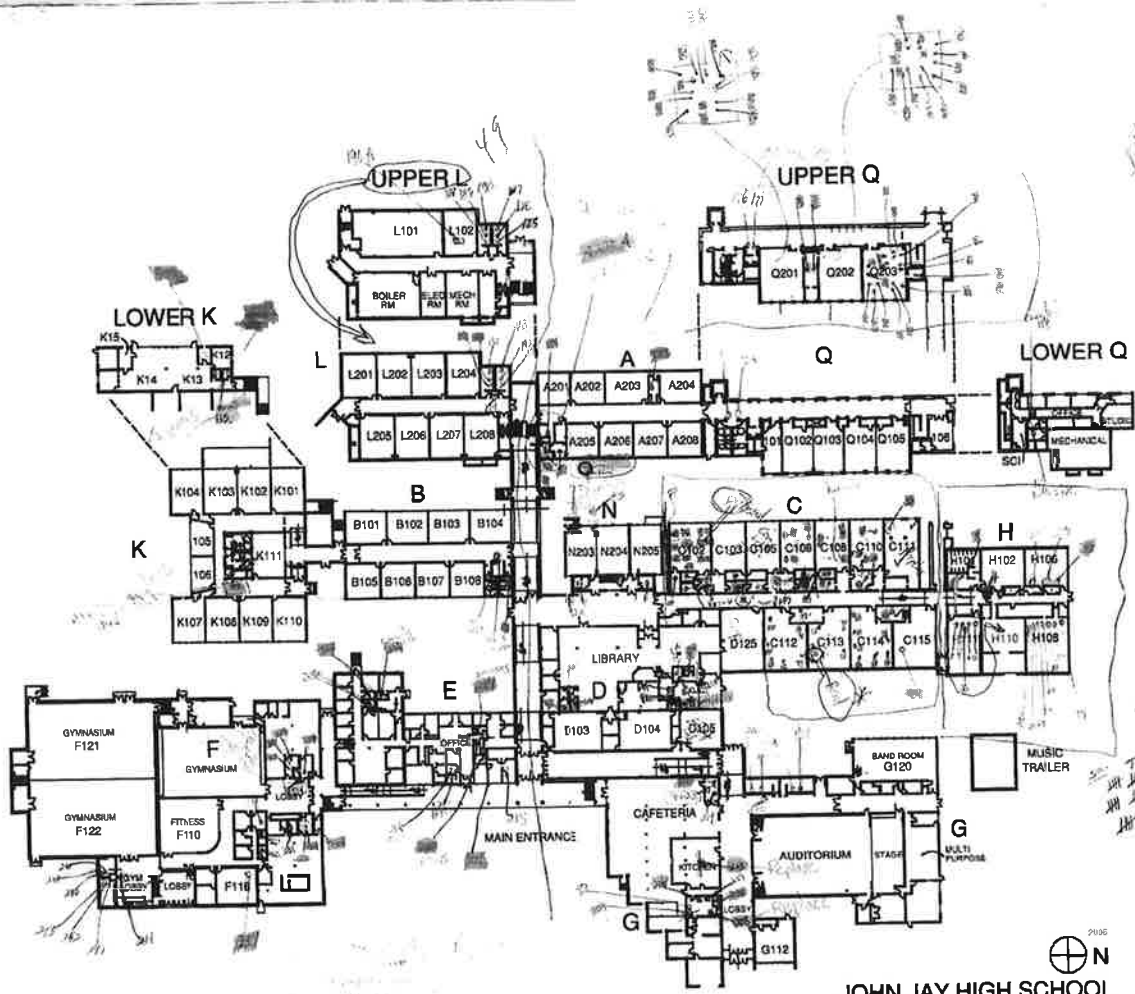

2105
N
JOHN JAY HIGH SCHOOL

Handwritten notes and signatures in the bottom right corner, including a large 'N' and various illegible scribbles.

Number	Location	Sink	Fountain	Test Notes
1	I Bathroom	√		
2	I Hallway		√	
3	H 101	√		No Test
4	H 101	√		No Test
5	H 101 Back Room	√		No Test
6	H 101 Back Room	√		No Test
7	H Hallway		√	
8	H 110	√		No Test
9	H 110	√		No Test
10	H 110	√		No Test
11	H 110	√		No Test
12	H 110	√		No Test
13	H 110	√		No Test
14	H 110	√		No Test
15	H 110	√		No Test
16	H 110	√		No Test
17	H Girls Bathroom	√		
18	H Boys Bathroom	√		
19	H 108	√		No Test
20	H 108	√		No Test
21	H 108	√		No Test
22	H 108	√		No Test
23	H 108	√		No Test
24	H 108	√		No Test
25	H 108	√		No Test
26	H 108	√		No Test
27	H 108	√		No Test
28	H 106	√		No Test
29	H 106	√		No Test
30	H 106	√		No Test
31	H 106	√		No Test
32	H 106	√		No Test
33	C 115 Backroom	√		No Test
34	C 115	√		No Test
35	C 111	√		No Test
36	C 110	√		No Test
37	C 110	√		No Test
38	C 110	√		No Test
39	C 110	√		No Test
40	C 110	√		No Test
41	C 110	√		No Test
42	C 109 A	√		No Test
43	C 114	√		No Test
44	C 114	√		No Test
45	C 114	√		No Test
46	C 114	√		No Test
47	C 114	√		No Test
48	C 114	√		No Test
49	C 114	√		No Test
50	C 108	√		No Test
51	C 108	√		No Test

Number	Location	Sink	Fountain	Test Notes
52	C 108	√		No Test
53	C 108	√		No Test
54	C 107 A	√		No Test
55	C 107 A	√		No Test
56	C 113	√		No Test
57	C 113	√		No Test
58	C 113	√		No Test
59	C 113	√		No Test
60	C 113 Backroom	√		No Test
61	C 112	√		No Test
62	C 112	√		No Test
63	C 112	√		No Test
64	C 112	√		No Test
65	C 112	√		No Test
66	C 112	√		No Test
67	C 104 B	√		No Test
68	C 106	√		No Test
69	C 106	√		No Test
70	C 106	√		No Test
71	C 106	√		No Test
72	C 101 C	√		No Test
73	C 103 Back Room	√		No Test
74	C 102	√		No Test
75	C 102	√		No Test
76	C 102	√		No Test
77	C 102	√		No Test
78	C 102	√		No Test
79	C 102	√		No Test
80	C 102	√		No Test
81	C 102	√		No Test
82	C 102	√		No Test
83	C 102	√		No Test
84	C 102	√		No Test
85	C 102	√		No Test
86	C 102	√		No Test
87	C 102	√		No Test
88	C 102 Backroom	√		
89	C Boys Bathroom	√		
90	C Girls Bathroom	√		
91	N Main Level Boys Bathroom	√		
92	N Main Level Girls Bathroom	√		
92 A	N Hallway		√	
92 B	N Hallway		√	
93	N Lower Staff Men's Bathroom	√		
94	N Lower Staff Women's Bathroom	√		
95	N Lower Faculty Area	√		
96	D Boys Bathroom	√		
97	D Girls Bathroom	√		
98	D 122	√		
99	Library Circulation Office	√		
100	Library Circulation Office	√		

Number	Location	Sink	Fountain	Test Notes
101	Library South Boys Bathroom	√		
102	Library South Hallway		√	
103	Library South Girls Bathroom	√		
104	B Boys Bathroom	√		
104A	B Boys Bathroom	√		
105	B Hallway		√	
106	B Girls Bathroom	√		
106A	B Girls Bathroom	√		
107	District Office Kitchen	√		
108	District Office Men's Bathroom	√		No Test
109	District Office Men's Bathroom	√		No Test
110	District Office Men's Bathroom	√		No Test
111	District Office Women's Bathroom	√		No Test
112	District Office Women's Bathroom	√		No Test
113	District Office Women's Bathroom	√		No Test
114	K Basement Girls Bathroom	√		
115	K Basement Hallway		√	OOS
116	K Basement Boys Bathroom	√		
117	Q Basement Bathroom	√		
118	Q Basement Hallway		√	
119	Q 1st Floor Staff Bathroom	√		No Test
120	Q 1st Floor Boys Bathroom	√		No Test
121	Q 1st Floor Boys Bathroom	√		No Test
122	Q 1st Floor Hallway		√	
123	Q 1st Floor Hallway		√	
124	Q 1st Floor Girls Bathroom	√		
125	Q 1st Floor Girls Bathroom	√		
126	Q 203	√		No Test
127	Q 203	√		No Test
128	Q 203	√		No Test
129	Q 203	√		No Test
130	Q 203	√		No Test
131	Q 203	√		No Test
132	Q 203	√		No Test
133	Q 203	√		No Test
134	Q 203	√		No Test
135	Q 203	√		No Test
136	Q 203	√		No Test
137	Q 203	√		No Test
138	Q 203	√		No Test
139	Q 203	√		No Test
140	Q 203	√		No Test
141	Q 202	√		No Test
142	Q 202	√		No Test
143	Q 202	√		No Test
144	Q 202	√		No Test
145	Q 202	√		No Test
146	Q 202	√		No Test
147	Q 202	√		No Test
148	Q 202	√		No Test
149	Q 202	√		No Test

Number	Location	Sink	Fountain	Test Notes
150	Q 202	√		No Test
151	Q 202	√		No Test
152	Q 202	√		No Test
153	Q 202	√		No Test
154	Q 202	√		No Test
155	Q 202	√		No Test
156	Q 202 Workroom	√		No Test
157	Q 202 Workroom	√		No Test
158	Q 201	√		No Test
159	Q 201	√		No Test
160	Q 201	√		No Test
161	Q 201	√		No Test
162	Q 201	√		No Test
163	Q 201	√		No Test
164	Q 201	√		No Test
165	Q 201	√		No Test
166	Q 201	√		No Test
167	Q 201	√		No Test
168	Q 201	√		No Test
169	Q 201	√		No Test
170	Q 201	√		No Test
171	Q 201	√		No Test
172	Q 201	√		No Test
173	Q 2nd Floor Staff Bathroom	√		No Test
174	Q 2nd Floor Boys Bathroom	√		No Test
175	Q 2nd Floor Boys Bathroom	√		No Test
176	Q 2nd Floor Hallway		√	
177	Q 2nd Floor Hallway		√	OOS
178	Q 2nd Floor Girls Bathroom	√		No Test
179	Q 2nd Floor Girls Bathroom	√		No Test
180	A 204 Backroom	√		
181	A 203 Boys Bathroom	√		
182	A 203 Boys Bathroom	√		
183	A 203 Boys Bathroom	√		
184	A 203 A	√		
184 A	A 203 Girls Bathroom	√		
184 B	A 203 Girls Bathroom	√		
184 C	A 203 Girls Bathroom	√		
185	L Basement Women's Bathroom	√		Test R to L
186	L Basement Women's Bathroom	√		Test R to L
187	L Basement Women's Bathroom	√		Test R to L
188	L Basement Men's Bathroom	√		Test L to R
189	L Basement Men's Bathroom	√		Test L to R
190	L Basement Men's Bathroom	√		Test L to R
190A	L102	√		OOS
191	L 1st Floor Girls Bathroom	√		
192	L 1st Floor Girls Bathroom	√		
193	L 1st Floor Girls Bathroom	√		
194	L 1st Floor Hallway		√	
195	L 1st Floor Boys Bathroom	√		
196	L 1st Floor Boys Bathroom	√		

Number	Location	Sink	Fountain	Test Notes
197	L 1st Floor Boys Bathroom	√		
198	G Men's Bathroom	√		Test R to L
199	G Men's Bathroom	√		Test R to L
200	G Hallway		√	
201	G Women's Bathroom	√		Test L to R
202	G Women's Bathroom	√		Test L to R
203	Kitchen Serving Area	√		
204	Kitchen Steamer	√		
205	Kitchen Bathroom	√		
206	Kitchen Prep Room	√		Test Clockwise From Door
207	Kitchen Prep Room	√		Test Clockwise From Door
208	Kitchen Prep Room	√		Test Clockwise From Door
209	Kitchen Prep Room	√		Test Clockwise From Door
210	Kitchen Prep Room Sprayer	√		Test Clockwise From Door
211	Kitchen Ice Maker	√		
212	Dish Room	√		
213	Dish Room	√		
214	Dish Room	√		OOS
215	Nurse Exam Room	√		
216	Nurse Office Bathroom	√		
217	Main Office Staff Women Bath	√		
218	Main Office Staff Men's Bathroom	√		
219	Main Office Girls Bathroom	√		
220	Main Office Boys Bathroom	√		
221	Principals Office	√		
222	Guidance Staff Bathroom	√		
223	Guidance Unisex Bathroom	√		
224	Girls Locker Room Office	√		
225	Girls Locker Room Bathroom	√		
226	Girls Locker Room Bathroom	√		
227	Girls Locker Room Bathroom	√		
228	Boys Locker Room Bathroom	√		
229	Boys Locker Room Bathroom	√		
230	Boys Locker Room Bathroom	√		
231	F 106 A	√		
232	F Trainer A Ice Maker	√		
233	F Trainer A	√		
234	F Trainer A Sprayer	√		
235	F Staff Women's Bathroom	√		
236	F Staff Men's Bathroom	√		
237	F 116	√		
238	New Gym Lobby Men's Bathroom	√		
239	New Gym Lobby Men's Bathroom	√		
240	New Gym Lobby Men's Bathroom	√		
241	New Gym Lobby Women's Bathroom	√		
242	New Gym Lobby Women's Bathroom	√		
243	New Gym Lobby Women's Bathroom	√		
244	New Gym Lobby		√	
245	Gym Laundry Ice Maker	√		
246	Gym Laundry	√		

JOHN JAY HIGH SCHOOL

JULY 13, 2021

LEAD TESTING

10/26/2016

7/13/2021

LOCATION	SINK #	TYPE	FD		RESULTS	FLUSH		RESULTS		RESULTS	TIME
I BATH	1	SINK	FD		0.0148	FLU		0.0046		0.0056	410
I HALLWAY	2	FOUNTAIN	FD	<	0.0005	FLU	<	0.001	<	0.0005	413
I HALLWAY	2A	BOTTLE F							<	0.0005	415
H HALL	7	FOUNTAIN	FD	<	0.0005	FLU	<	0.001	<	0.0005	422
H HALL	7A	BOTTLE F							<	0.0005	423
C BYS BATH	89	SINK	FD		<u>0.0225</u>	FLU		0.003		<u>0.0194</u>	432
CGR L BATH	90	SINK	FD		0.0109	FLU		0.0032		0.0126	434
N BYS BATH	91	SINK	FD		0.0062	FLU		0.004		0.0061	435
N GRL BATH	92	SINK	FD		0.0132	FLU		0.0031		0.0105	437
N HALL	92A	FOUNTAIN	FD	<	0.001	FLU	<	0.001	<	0.0005	438
N GRL HALL	92B	BOTTLE F							<	0.0005	439
N S MN RM	93	SINK	FD		0.013	FLU		0.0036		0.0111	441
N S W RM	94	SINK	FD		0.001	FLU		0.0039		0.0108	442
N FAC AREA	95	SINK	FD		<u>0.0181</u>	FLU		0.0028		0.0047	443
D BOYS BATH	96	SINK	FD		<u>0.0212</u>	FLU		0.0051		0.0145	447
D GRL BATH	97	SINK	FD		0.0058	FLU		0.0036		0.0049	448
D122	98	SINK	FD		<u>0.0239</u>	FLU		0.0049		0.0005	449
LIB CIRC OFF	99	SINK	FD		0.0032	FLU		<u>0.0319</u>		0.0104	450
LIB CIRC OFF	100	SINK	FD		<u>0.0151</u>	FLU		0.0044		0.0051	451
LIB S BY BATH	101	SINK	FD		<u>0.0243</u>	FLU		0.0027		0.0139	452
LIB S HALL	102	FOUNTAIN	FD		<u>0.0189</u>	FLU		0.005	<	0.0005	453
LIB S GL BATH	103	SINK	FD		<u>0.0187</u>	FLU		0.0037		<u>0.0178</u>	454
B BYS BATH	104	SINK	FD		<u>0.0208</u>	FLU		0.0025		<u>0.0221</u>	457
B BYS BATH	104A	SINK	FD		<u>0.0249</u>	FLU		0.003		<u>0.0196</u>	458
B HALL	105	FOUNTAIN	FD		0.0073	FLU		0.0035		0.0107	459
B GRL BATH	106	SINK								0.0048	501
B GRL BATH	106A	SINK	FD		0.0089	FLU		0.0119		0.0136	502
DO KITCH	107	SINK	FD		<u>0.368</u>	FLU		<u>0.0222</u>		0.0019	505
K BSMT G B	114	SINK	FD		<u>0.0329</u>	FLU		0.0055		<u>0.0389</u>	508
K BSNT B B	116	SINK	FD		<u>0.0212</u>	FLU		0.0039		<u>0.0236</u>	509
Q BSMT B	117	SINK	FD		0.0118	FLU		0.0025		0.0079	515
Q BSMT HALL	118	FOUNTAIN	FD		0.0142	FLU		0.0056		<u>0.0462</u>	517
Q 1 FL HALL	122	FOUNTAIN	FD		0.0024	FLU		0.0027		0.0061	520
Q1 FL HALL	123	FOUNTAIN	FD		0.0011	FLU		0.0027		0.0113	521
Q1 FL GRL BATH	124	SINK								0.0067	522
Q1 FL GRL BATH	125	SINK								0.0069	523
Q2FL HALL	176	FOUNTAIN	FD		0.004	FLU		0.0026		<u>0.0406</u>	529
A204 BKRM	180	SINK	FD		<u>0.146</u>	FLU		<u>0.0193</u>		<u>3.04</u>	531
A203 B BATH	181	SINK	FD		<u>0.0316</u>	FLU		<u>0.0158</u>		<u>0.0619</u>	534

A203 B BATH	182	SINK	FD		<u>0.0332</u>	FLU		0.0049
A203 B BATH	183	SINK	FD		<u>0.05</u>	FLU		0.0082
A203A	184	SINK	FD		<u>0.0197</u>	FLU		0.0044
A 203 G BATH	184A	SINK						
A 203 G BATH	184B	SINK						
A 203 G BATH	184C	SINK						
L BSMT W B	185	SINK	FD		<u>0.016</u>	FLU		0.0041
L BSMT W B	186	SINK	FD		0.0103	FLU		0.0118
L BSMT W B	187	SINK	FD		0.0047	FLU		0.0047
L BSMT M B	188	SINK	FD		0.0091	FLU		0.0046
L BSMT M B	189	SINK	FD		0.0125	FLU		0.0055
L BSMT M B	190	SINK	FD		0.0105	FLU		0.0051
L 1FL G BATH	191	SINK	FD		0.0089	FLU		0.0042
L 1FL G BATH	192	SINK	FD		0.0076	FLU		0.0042
L 1 FL G BATH	193	SINK	FD		0.008	FLU		0.0044
L 1 FL HALL	194	FOUNTAIN	FD		0.001	FLU		0.0038
L 1 FL B BATH	195	SINK	FD		<u>0.0292</u>	FLU		0.004
L 1 FL B BATH	196	SINK	FD		<u>0.0198</u>	FLU		0.0037
L 1 FL B BATH	197	SINK	FD		0.0032	FLU		0.003
G MN BATH	198	SINK	FD		0.0073	FLU		0.0015
G MN BATH	199	SINK	FD		0.0082	FLU		0.0023
G HALL	200	FOUNTAIN	FD	<	0.001	FLU	<	0.001
G HALL	200B	BOTTLE F						
G WMN BATH	201	SINK	FD		0.0083	FLU		0.0066
G WMN BATH	202	SINK	FD		0.0112	FLU		0.0063
KIT SRV AREA	203	SINK	FD		<u>0.0374</u>	FLU		0.0043
KIT BATH	205	SINK	FD		<u>0.0321</u>	FLU		0.009
KIT PREP RM	206	SINK	FD		<u>0.0797</u>	FLU		0.005
KIT PREP RM	207	SINK	FD		0.0087	FLU		0.0038
KIT PREP RM	208	SINK	FD		<u>0.088</u>	FLU		0.0065
KITPREP RM	209	SINK	FD		<u>0.0249</u>	FLU		0.0037
KITPREP RM	209A	SINK						
KIT PREP RM	210	SINK	FD		0.0109	FLU		0.0035
KIT ICE MAKER	211	SINK						
DISH ROOM	212	SINK						
NURSE EXAM	215	SINK	FD		0.0109	FLU		0.0041
NRS OFF BATH	216	SINK	FD		<u>0.0264</u>	FLU		0.0034
OFF W RM	217	SINK	FD		<u>0.0155</u>	FLU		0.0035
OFF M RM	218	SINK	FD		<u>0.0278</u>	FLU		0.0045
OFF G BATH	219	SINK	FD		0.0064	FLU		0.0032
OFF B BATH	220	SINK	FD		0.0122	FLU		0.0037
PRINCIPAL	221	SINK	FD		<u>0.0182</u>	FLU		0.0044
GUID ST BATH	222	SINK	FD		0.0085	FLU		0.0031
GUID UNI B	223	SINK	FD		<u>0.0151</u>	FLU		0.0034
G LKR RM OF	224	SINK	FD		<u>0.0194</u>	FLU		0.0036
G LKR RM B	225	SINK	FD		<u>0.0329</u>	FLU		0.0065
G LKR RM B	226	SINK	FD		<u>0.0304</u>	FLU		0.0058
G LKR RM B	227	SINK	FD		<u>0.0674</u>	FLU		0.0106
B LKR RM B	228	SINK	FD		<u>0.0309</u>	FLU		0.0049

	<u>0.0426</u>	534
	<u>0.0395</u>	535
	<u>0.0159</u>	536
	0.0049	537
	0.0077	538
	0.0071	539
	0.0048	550
	0.0109	551
	0.0091	551
	<u>0.0674</u>	553
	<u>0.0155</u>	554
	0.0061	554
	0.0135	559
	<u>0.0272</u>	600
	0.0056	601
	0.0029	555
	0.0076	602
	0.0147	603
	<u>0.0193</u>	604
	<u>0.0154</u>	610
	0.0079	611
<	0.0005	613
<	0.0005	613
	0.0076	615
	0.0067	616
	<u>0.0227</u>	620
	0.0142	621
	<u>0.0308</u>	622
	<u>0.0159</u>	623
	0.0096	624
	0.0074	626
	0.0105	627
	0.0083	627
<	0.0005	628
	0.0089	630
	<u>0.0153</u>	634
	0.0105	635
	0.0102	636
	<u>0.0247</u>	637
	0.0093	638
	<u>0.0151</u>	639
	0.0129	641
	0.0061	642
	0.0101	643
	<u>0.0163</u>	645
	0.0077	646
	0.0051	646
	0.0086	647
	<u>0.0316</u>	648

B LKR RM B	229	SINK	FD		<u>0.0212</u>	FLU		0.0048
B LKR RM B	230	SINK	FD		<u>0.0261</u>	FLU		0.0055
F 106A	231	SINK	FD		0.0143	FLU		0.0046
F TRAINER ICE M	232	SINK						
F TRAINER	233	SINK	FD		0.0042	FLU		0.0032
F STF W RM	235	SINK	FD		0.0112	FLU		0.003
F STF M RM	236	SINK	FD		0.0072	FLU		0.0029
F116	237	SINK	FD		<u>0.0205</u>	FLU		0.0046
NG LOB M RM	238	SINK	FD		0.0054	FLU		0.0032
NG LOB M RM	239	SINK	FD		0.0071	FLU		0.0047
NG LOB M RM	240	SINK	FD		<u>0.0167</u>	FLU		0.0032
NG LOB WRM	241	SINK	FD		0.0141	FLU		0.004
NG LOB WRM	242	SINK	FD		0.0097	FLU		0.0023
NG LOB WRM	243	SINK	FD		0.0085	FLU	<	0.001
NG LOBBY	244	FOUNTAIN	FD		0.0015	FLU	<	0.001
NG LOBBY	244A	BOTTLE F						

	<u>0.0289</u>	648
	<u>0.0253</u>	649
	0.0132	650
<	0.0005	652
	0.0051	653
	0.0072	654
	0.0021	655
	0.0133	658
	0.0038	700
	0.0038	700
	<u>0.0187</u>	701
	0.0036	703
	0.0034	703
	0.0053	704
<	0.0005	708
<	0.0005	708



CLIENT NOTIFICATION MCL / AL Exceedance

7/20/2021 1:19:08 PM

Sample Delivery Group: GCI72882

Location Code: BWWS

Project: KLSD JOHN JAY HIGH SCHOOL

Phoenix ID	Client Id	Matrix	Rush	Parameter	Result	Units	Analysis Date	MCL	AL
CI72887	SK#89	DW		Lead	0.0194	mg/L	07/16/21 03:42		0.015
CI72903	SK#103	DW		Lead	0.0178	mg/L	07/16/21 17:15		0.015
CI72904	SK#104	DW		Lead	0.0221	mg/L	07/16/21 17:18		0.015
CI72905	SK#104A	DW		Lead	0.0196	mg/L	07/16/21 17:21		0.015
CI72910	SK#114	DW		Lead	0.0389	mg/L	07/16/21 17:50		0.015
CI72911	SK#116	DW		Lead	0.0236	mg/L	07/16/21 17:52		0.015
CI72913	F+N#118	DW		Lead	0.0462	mg/L	07/16/21 20:09		0.015
CI72918	F+N#176	DW		Lead	0.0406	mg/L	07/16/21 20:35		0.015
CI72919	SK#180	DW		Lead	3.04	mg/L	07/16/21 23:22		0.015
CI72920	SK#181	DW		Lead	0.0619	mg/L	07/16/21 20:40		0.015
CI72921	SK#182	DW		Lead	0.0426	mg/L	07/16/21 20:42		0.015
CI72922	SK#184	DW		Lead	0.0159	mg/L	07/16/21 20:48		0.015
CI72926	SK#183	DW		Lead	0.0395	mg/L	07/16/21 21:11		0.015
CI72930	SK#188	DW		Lead	0.0674	mg/L	07/16/21 21:21		0.015
CI72931	SK#189	DW		Lead	0.0155	mg/L	07/16/21 21:24		0.015
CI72934	SK#192	DW		Lead	0.0272	mg/L	07/16/21 22:33		0.015
CI72939	SK#197	DW		Lead	0.0193	mg/L	07/16/21 22:46		0.015
CI72940	SK#198	DW		Lead	0.0154	mg/L	07/16/21 23:02		0.015
CI72946	SK#203	DW		Lead	0.0227	mg/L	07/16/21 23:25		0.015
CI72948	SK#206	DW		Lead	0.0308	mg/L	07/16/21 23:43		0.015
CI72949	SK#207	DW		Lead	0.0159	mg/L	07/16/21 23:45		0.015
CI72956	SK#215	DW		Lead	0.0153	mg/L	07/17/21 00:34		0.015
CI72959	SK#218	DW		Lead	0.0247	mg/L	07/17/21 00:42		0.015
CI72961	SK#220	DW		Lead	0.0151	mg/L	07/17/21 01:00		0.015
CI72965	SK#224	DW		Lead	0.0163	mg/L	07/17/21 01:13		0.015
CI72969	SK#228	DW		Lead	0.0316	mg/L	07/17/21 01:36		0.015

Contact: bwws, jason

Date: 7/20/2021 1:19:00 PM

Comments: emailed

Maximum Contaminant Level (MCL): The highest level of a contaminant that is allowed in drinking water. MCLs are enforceable standards.
Action Level (AL): The concentration of a contaminant which, if exceeded, triggers treatment or other requirements.



CLIENT NOTIFICATION MCL / AL Exceedance

7/20/2021 1:19:08 PM

Sample Delivery Group: GCI72882

Location Code: BWWS

Project: KLSJ JOHN JAY HIGH SCHOOL

Phoenix ID	Client Id	Matrix	Rush	Parameter	Result	Units	Analysis Date	MCL	AL
CI72970	SK#229	DW		Lead	0.0289	mg/L	07/17/21 01:39		0.015
CI72971	SK#230	DW		Lead	0.0253	mg/L	07/17/21 01:41		0.015
CI72980	SK#240	DW		Lead	0.0187	mg/L	07/19/21 20:10		0.015

Contact: bwws, jason

Date: 7/20/2021 1:19:00 PM

Comments: emailed

Maximum Contaminant Level (MCL): The highest level of a contaminant that is allowed in drinking water. MCLs are enforceable standards.
Action Level (AL): The concentration of a contaminant which, if exceeded, triggers treatment or other requirements.



Environmental Laboratories, Inc.
587 East Middle Turnpike, P.O.Box 370, Manchester, CT 06045



Analysis Report

July 20, 2021

FOR: Attn: Mr. Bob Woodstead
Better Water Well Systems
348 Smith Ridge Rd
South Salem, NY 10590

Sample Information

Matrix: DRINKING WATER
Location Code: BWWS
Rush Request: Standard
P.O.#:

Custody Information

Collected by:
Received by: B
Analyzed by: see "By" below

Date Time

07/13/21 4:10
07/13/21 15:33

Laboratory Data

SDG ID: GCI72882
Phoenix ID: CI72882

Project ID: KLSD JOHN JAY HIGH SCHOOL
Client ID: SK#1

Parameter	Result	RL/ PQL	DIL	Units	AL	MCL	MCLG	Date/Time	By	Reference
Lead	0.0056	0.0005	2	mg/L	0.015			07/16/21	CPP	E200.8
Total Metal Digestion	Completed							07/13/21		E200.8

RL/PQL=Minimum Reportable Level DW MCL=Maximum Potability Limit Sec Goal=Recommended Potability Limit NA=Not Applicable

For further interpretation or recommendations on treatment, please contact your local or state health department. Please see last page for additional information.

Phyllis Shiller, Lab Director
July 20, 2021



Environmental Laboratories, Inc.
587 East Middle Turnpike, P.O.Box 370, Manchester, CT 06045



Analysis Report

July 20, 2021

FOR: Attn: Mr. Bob Woodstead
Better Water Well Systems
348 Smith Ridge Rd
South Salem, NY 10590

Sample Information

Matrix: DRINKING WATER
Location Code: BWWS
Rush Request: Standard
P.O.#:

Custody Information

Collected by:
Received by: B
Analyzed by: see "By" below

Date Time
07/13/21 4:13
07/13/21 15:33

Laboratory Data

SDG ID: GC172882
Phoenix ID: C172883

Project ID: KLSD JOHN JAY HIGH SCHOOL
Client ID: F+N#2

Parameter	Result	RL/ PQL	DIL	Units	AL	MCL	MCLG	Date/Time	By	Reference
Lead	< 0.0005	0.0005	2	mg/L	0.015			07/16/21	CPP	E200.8
Total Metal Digestion	Completed							07/13/21		E200.8

RL/PQL=Minimum Reportable Level DW MCL=Maximum Potability Limit Sec Goal=Recommended Potability Limit NA=Not Applicable

Phyllis Shiller, Lab Director
July 20, 2021

For further interpretation or recommendations on treatment, please contact your local or state health department. Please see last page for additional information.



Environmental Laboratories, Inc.
587 East Middle Turnpike, P.O.Box 370, Manchester, CT 06045



Analysis Report

July 20, 2021

FOR: Attn: Mr. Bob Woodstead
Better Water Well Systems
348 Smith Ridge Rd
South Salem, NY 10590

Sample Information

Matrix: DRINKING WATER
Location Code: BWWS
Rush Request: Standard
P.O.#:

Custody Information

Collected by:
Received by: B
Analyzed by: see "By" below

Date

07/13/21

Time

4:15

07/13/21

15:33

Laboratory Data

SDG ID: GCI72882

Phoenix ID: CI72884

Project ID: KLSD JOHN JAY HIGH SCHOOL

Client ID: BF#2A

Parameter	Result	RL/ PQL	DIL	Units	AL	MCL	MCLG	Date/Time	By	Reference
Lead	< 0.0005	0.0005	2	mg/L	0.015			07/16/21	CPP	E200.8
Total Metal Digestion	Completed							07/13/21		E200.8

RL/PQL=Minimum Reportable Level DW MCL=Maximum Potability Limit Sec Goal=Recommended Potability Limit NA=Not Applicable

Phyllis Shiller, Lab Director
July 20, 2021

For further interpretation or recommendations on treatment, please contact your local or state health department. Please see last page for additional information.



Environmental Laboratories, Inc.
587 East Middle Turnpike, P.O.Box 370, Manchester, CT 06045



Analysis Report

July 20, 2021

FOR: Attn: Mr. Bob Woodstead
Better Water Well Systems
348 Smith Ridge Rd
South Salem, NY 10590

Sample Information

Matrix: DRINKING WATER
Location Code: BWWS
Rush Request: Standard
P.O.#:

Custody Information

Collected by:
Received by: B
Analyzed by: see "By" below

Date

07/13/21
07/13/21

Time

4:22
15:33

Laboratory Data

SDG ID: GC172882
Phoenix ID: CI72885

Project ID: KLSD JOHN JAY HIGH SCHOOL
Client ID: F+N#7

Parameter	Result	RL/ PQL	DIL	Units	AL	MCL	MCLG	Date/Time	By	Reference
Lead	< 0.0005	0.0005	2	mg/L	0.015			07/16/21	CPP	E200.8
Total Metal Digestion	Completed							07/13/21		E200.8

RL/PQL=Minimum Reportable Level DW MCL=Maximum Potability Limit Sec Goal=Recommended Potability Limit NA=Not Applicable

Phyllis Shiller, Lab Director
July 20, 2021

For further interpretation or recommendations on treatment, please contact your local or state health department. Please see last page for additional information.



Environmental Laboratories, Inc.
587 East Middle Turnpike, P.O.Box 370, Manchester, CT 06045



Analysis Report

July 20, 2021

FOR: Attn: Mr. Bob Woodstead
Better Water Well Systems
348 Smith Ridge Rd
South Salem, NY 10590

Sample Information

Matrix: DRINKING WATER
Location Code: BWWS
Rush Request: Standard
P.O.#:

Custody Information

Collected by:
Received by: B
Analyzed by: see "By" below

Date

07/13/21
07/13/21

Time

4:23
15:33

Laboratory Data

SDG ID: GCI72882
Phoenix ID: CI72886

Project ID: KLSD JOHN JAY HIGH SCHOOL
Client ID: BF#7A

Parameter	Result	RL/ PQL	DIL	Units	AL	MCL	MCLG	Date/Time	By	Reference
Lead	< 0.0005	0.0005	2	mg/L	0.015			07/16/21	CPP	E200.8
Total Metal Digestion	Completed							07/13/21		E200.8

RL/PQL=Minimum Reportable Level DW MCL=Maximum Potability Limit Sec Goal=Recommended Potability Limit NA=Not Applicable

Phyllis Shiller, Lab Director
July 20, 2021

For further interpretation or recommendations on treatment, please contact your local or state health department. Please see last page for additional information.



Environmental Laboratories, Inc.
587 East Middle Turnpike, P.O.Box 370, Manchester, CT 06045



Analysis Report

July 20, 2021

FOR: Attn: Mr. Bob Woodstead
Better Water Well Systems
348 Smith Ridge Rd
South Salem, NY 10590

Sample Information

Matrix: DRINKING WATER
Location Code: BWWS
Rush Request: Standard
P.O.#:

Custody Information

Collected by:
Received by: B
Analyzed by: see "By" below

Date Time

07/13/21 4:32
07/13/21 15:33

Laboratory Data

SDG ID: GC172882
Phoenix ID: C172887

Project ID: KLSD JOHN JAY HIGH SCHOOL
Client ID: SK#89

Parameter	Result	RL/ PQL	DIL	Units	AL	MCL	MCLG	Date/Time	By	Reference
Lead	0.0194	0.0005	2	mg/L	0.015			07/16/21	CPP	E200.8
*** Lead exceeds Action Level of 0.015 ***										
Total Metal Digestion	Completed							07/13/21		E200.8

RL/PQL=Minimum Reportable Level DW MCL=Maximum Potability Limit Sec Goal=Recommended Potability Limit NA=Not Applicable

Phyllis Shiller, Lab Director
July 20, 2021

For further interpretation or recommendations on treatment, please contact your local or state health department. Please see last page for additional information.



Environmental Laboratories, Inc.
587 East Middle Turnpike, P.O.Box 370, Manchester, CT 06045



Analysis Report

July 20, 2021

FOR: Attn: Mr. Bob Woodstead
Better Water Well Systems
348 Smith Ridge Rd
South Salem, NY 10590

Sample Information

Matrix: DRINKING WATER
Location Code: BWWS
Rush Request: Standard
P.O.#:

Custody Information

Collected by:
Received by: B
Analyzed by: see "By" below

Date

07/13/21
07/13/21

Time

4:34
15:33

Laboratory Data

SDG ID: GC172882
Phoenix ID: C172888

Project ID: KLSD JOHN JAY HIGH SCHOOL
Client ID: SK#90

Parameter	Result	RL/ PQL	DIL	Units	AL	MCL	MCLG	Date/Time	By	Reference
Lead	0.0126	0.0005	2	mg/L	0.015			07/16/21	CPP	E200.8
Total Metal Digestion	Completed							07/13/21		E200.8

RL/PQL=Minimum Reportable Level DW MCL=Maximum Potability Limit Sec Goal=Recommended Potability Limit NA=Not Applicable

Phyllis Shiller, Lab Director
July 20, 2021

For further interpretation or recommendations on treatment, please contact your local or state health department. Please see last page for additional information.



Environmental Laboratories, Inc.
587 East Middle Turnpike, P.O.Box 370, Manchester, CT 06045



Analysis Report

July 20, 2021

FOR: Attn: Mr. Bob Woodstead
Better Water Well Systems
348 Smith Ridge Rd
South Salem, NY 10590

Sample Information

Matrix: DRINKING WATER
Location Code: BWWS
Rush Request: Standard
P.O.#:

Custody Information

Collected by:
Received by: B
Analyzed by: see "By" below

Date

07/13/21
07/13/21

Time

4:35
15:33

Laboratory Data

SDG ID: GC172882
Phoenix ID: C172889

Project ID: KLSD JOHN JAY HIGH SCHOOL
Client ID: SK#91

Parameter	Result	RL/ PQL	DIL	Units	AL	MCL	MCLG	Date/Time	By	Reference
Lead	0.0061	0.0005	2	mg/L	0.015			07/16/21	CPP	E200.8
Total Metal Digestion	Completed							07/13/21		E200.8

RL/PQL=Minimum Reportable Level DW MCL=Maximum Potability Limit Sec Goal=Recommended Potability Limit NA=Not Applicable

Phyllis Shiller, Lab Director
July 20, 2021

For further interpretation or recommendations on treatment, please contact your local or state health department. Please see last page for additional information.



Environmental Laboratories, Inc.
587 East Middle Turnpike, P.O.Box 370, Manchester, CT 06045



Analysis Report

July 20, 2021

FOR: Attn: Mr. Bob Woodstead
Better Water Well Systems
348 Smith Ridge Rd
South Salem, NY 10590

Sample Information

Matrix: DRINKING WATER
Location Code: BWWS
Rush Request: Standard
P.O.#:

Custody Information

Collected by:
Received by: B
Analyzed by: see "By" below

Date

Time

07/13/21 4:37
07/13/21 15:33

Laboratory Data

SDG ID: GCI72882
Phoenix ID: CI72890

Project ID: KLSJ JOHN JAY HIGH SCHOOL
Client ID: SK#92

Parameter	Result	RL/ PQL	DIL	Units	AL	MCL	MCLG	Date/Time	By	Reference
Lead	0.0105	0.0005	2	mg/L	0.015			07/16/21	CPP	E200.8
Total Metal Digestion	Completed							07/13/21		E200.8

RL/PQL=Minimum Reportable Level DW MCL=Maximum Potability Limit Sec Goal=Recommended Potability Limit NA=Not Applicable

Phyllis Shiller, Lab Director
July 20, 2021

For further interpretation or recommendations on treatment, please contact your local or state health department. Please see last page for additional information.



Environmental Laboratories, Inc.
587 East Middle Turnpike, P.O.Box 370, Manchester, CT 06045



Analysis Report

July 20, 2021

FOR: Attn: Mr. Bob Woodstead
Better Water Well Systems
348 Smith Ridge Rd
South Salem, NY 10590

Sample Information

Matrix: DRINKING WATER
Location Code: BWWS
Rush Request: Standard
P.O.#:

Custody Information

Collected by:
Received by: B
Analyzed by: see "By" below

Date

07/13/21
07/13/21

Time

4:38
15:33

Laboratory Data

SDG ID: GC172882
Phoenix ID: CI72891

Project ID: KLSD JOHN JAY HIGH SCHOOL
Client ID: F+N#92A

Parameter	Result	RL/ PQL	DIL	Units	AL	MCL	MCLG	Date/Time	By	Reference
Lead	< 0.0005	0.0005	2	mg/L	0.015			07/16/21	CPP	E200.8
Total Metal Digestion	Completed							07/13/21		E200.8

RL/PQL=Minimum Reportable Level DW MCL=Maximum Potability Limit Sec Goal=Recommended Potability Limit NA=Not Applicable

Phyllis Shiller, Lab Director
July 20, 2021

For further interpretation or recommendations on treatment, please contact your local or state health department. Please see last page for additional information.



Environmental Laboratories, Inc.
587 East Middle Turnpike, P.O.Box 370, Manchester, CT 06045



Analysis Report

July 20, 2021

FOR: Attn: Mr. Bob Woodstead
Better Water Well Systems
348 Smith Ridge Rd
South Salem, NY 10590

Sample Information

Matrix: DRINKING WATER
Location Code: BWWS
Rush Request: Standard
P.O.#:

Custody Information

Collected by:
Received by: B
Analyzed by: see "By" below

Date

07/13/21

Time

4:39

07/13/21

15:33

Laboratory Data

SDG ID: GC172882
Phoenix ID: C172892

Project ID: KLSJ JOHN JAY HIGH SCHOOL
Client ID: BF#92B

Parameter	Result	RL/ PQL	DIL	Units	AL	MCL	MCLG	Date/Time	By	Reference
Lead	< 0.0005	0.0005	2	mg/L	0.015			07/16/21	CPP	E200.8
Total Metal Digestion	Completed							07/13/21	B/AG/BF	E200.8

RL/PQL=Minimum Reportable Level DW MCL=Maximum Potability Limit Sec Goal=Recommended Potability Limit NA=Not Applicable

Phyllis Shiller, Lab Director
July 20, 2021

For further interpretation or recommendations on treatment, please contact your local or state health department. Please see last page for additional information.



Environmental Laboratories, Inc.
587 East Middle Turnpike, P.O.Box 370, Manchester, CT 06045



Analysis Report

July 20, 2021

FOR: Attn: Mr. Bob Woodstead
Better Water Well Systems
348 Smith Ridge Rd
South Salem, NY 10590

Sample Information

Matrix: DRINKING WATER
Location Code: BWWS
Rush Request: Standard
P.O.#:

Custody Information

Collected by:
Received by: B
Analyzed by: see "By" below

Date

Time

07/13/21 4:41
07/13/21 15:33

Laboratory Data

SDG ID: GC172882
Phoenix ID: CI72893

Project ID: KLSJ JOHN JAY HIGH SCHOOL
Client ID: SK#93

Parameter	Result	RL/ PQL	DIL	Units	AL	MCL	MCLG	Date/Time	By	Reference
Lead	0.0111	0.0005	2	mg/L	0.015			07/16/21	CPP	E200.8
Total Metal Digestion	Completed							07/13/21	B/AG/BF	E200.8

RL/PQL=Minimum Reportable Level DW MCL=Maximum Potability Limit Sec Goal=Recommended Potability Limit NA=Not Applicable

Phyllis Shiller, Lab Director
July 20, 2021

For further interpretation or recommendations on treatment, please contact your local or state health department. Please see last page for additional information.



Environmental Laboratories, Inc.
587 East Middle Turnpike, P.O.Box 370, Manchester, CT 06045



Analysis Report

July 20, 2021

FOR: Attn: Mr. Bob Woodstead
Better Water Well Systems
348 Smith Ridge Rd
South Salem, NY 10590

Sample Information

Matrix: DRINKING WATER
Location Code: BWWS
Rush Request: Standard
P.O.#:

Custody Information

Collected by:
Received by: B
Analyzed by: see "By" below

Date Time

07/13/21 4:42
07/13/21 15:33

Laboratory Data

SDG ID: GC172882
Phoenix ID: C172894

Project ID: KLSD JOHN JAY HIGH SCHOOL
Client ID: SK#94

Parameter	Result	RL/ PQL	DIL	Units	AL	MCL	MCLG	Date/Time	By	Reference
Lead	0.0108	0.0005	2	mg/L	0.015			07/16/21	CPP	E200.8
Total Metal Digestion	Completed							07/13/21	B/AG/BF	E200.8

RL/PQL=Minimum Reportable Level DW MCL=Maximum Potability Limit Sec Goal=Recommended Potability Limit NA=Not Applicable

Phyllis Shiller, Lab Director
July 20, 2021

For further interpretation or recommendations on treatment, please contact your local or state health department. Please see last page for additional information.



Environmental Laboratories, Inc.
587 East Middle Turnpike, P.O.Box 370, Manchester, CT 06045



Analysis Report

July 20, 2021

FOR: Attn: Mr. Bob Woodstead
Better Water Well Systems
348 Smith Ridge Rd
South Salem, NY 10590

Sample Information

Matrix: DRINKING WATER
Location Code: BWWS
Rush Request: Standard
P.O.#:

Custody Information

Collected by:
Received by: B
Analyzed by: see "By" below

Date

07/13/21
07/13/21

Time

4:43
15:33

Laboratory Data

SDG ID: GCI72882
Phoenix ID: CI72895

Project ID: KLSD JOHN JAY HIGH SCHOOL
Client ID: SK#95

Parameter	Result	RL/ PQL	DIL	Units	AL	MCL	MCLG	Date/Time	By	Reference
Lead	0.0047	0.0005	2	mg/L	0.015			07/16/21	CPP	E200.8
Total Metal Digestion	Completed							07/13/21	B/AG/BF	E200.8

RL/PQL=Minimum Reportable Level DW MCL=Maximum Potability Limit Sec Goal=Recommended Potability Limit NA=Not Applicable

Phyllis Shiller, Lab Director
July 20, 2021

For further interpretation or recommendations on treatment, please contact your local or state health department. Please see last page for additional information.



Environmental Laboratories, Inc.
587 East Middle Turnpike, P.O.Box 370, Manchester, CT 06045



Analysis Report

July 20, 2021

FOR: Attn: Mr. Bob Woodstead
Better Water Well Systems
348 Smith Ridge Rd
South Salem, NY 10590

Sample Information

Matrix: DRINKING WATER
Location Code: BWWS
Rush Request: Standard
P.O.#:

Custody Information

Collected by:
Received by: B
Analyzed by: see "By" below

Date

Time

07/13/21 4:47
07/13/21 15:33

Laboratory Data

SDG ID: GCI72882
Phoenix ID: CI72896

Project ID: KLSD JOHN JAY HIGH SCHOOL
Client ID: SK#96

Parameter	Result	RL/ PQL	DIL	Units	AL	MCL	MCLG	Date/Time	By	Reference
Lead	0.0145	0.0005	2	mg/L	0.015			07/16/21	CPP	E200.8
Total Metal Digestion	Completed							07/13/21	B/AG/BF	E200.8

RL/PQL=Minimum Reportable Level DW MCL=Maximum Potability Limit Sec Goal=Recommended Potability Limit NA=Not Applicable

Phyllis Shiller, Lab Director
July 20, 2021

For further interpretation or recommendations on treatment, please contact your local or state health department. Please see last page for additional information.



Environmental Laboratories, Inc.
587 East Middle Turnpike, P.O.Box 370, Manchester, CT 06045



Analysis Report

July 20, 2021

FOR: Attn: Mr. Bob Woodstead
Better Water Well Systems
348 Smith Ridge Rd
South Salem, NY 10590

Sample Information

Matrix: DRINKING WATER
Location Code: BWWS
Rush Request: Standard
P.O.#:

Custody Information

Collected by:
Received by: B
Analyzed by: see "By" below

Date

Time

07/13/21 4:48
07/13/21 15:33

Laboratory Data

SDG ID: GC172882
Phoenix ID: C172897

Project ID: KLSD JOHN JAY HIGH SCHOOL
Client ID: SK#97

Parameter	Result	RL/ PQL	DIL	Units	AL	MCL	MCLG	Date/Time	By	Reference
Lead	0.0049	0.0005	2	mg/L	0.015			07/16/21	CPP	E200.8
Total Metal Digestion	Completed							07/13/21	B/AG/BF	E200.8

RL/PQL=Minimum Reportable Level DW MCL=Maximum Potability Limit Sec Goal=Recommended Potability Limit NA=Not Applicable

Phyllis Shiller, Lab Director
July 20, 2021

For further interpretation or recommendations on treatment, please contact your local or state health department. Please see last page for additional information.



Environmental Laboratories, Inc.
587 East Middle Turnpike, P.O.Box 370, Manchester, CT 06045



Analysis Report

July 20, 2021

FOR: Attn: Mr. Bob Woodstead
Better Water Well Systems
348 Smith Ridge Rd
South Salem, NY 10590

Sample Information

Matrix: DRINKING WATER
Location Code: BWWS
Rush Request: Standard
P.O.#:

Custody Information

Collected by:
Received by: B
Analyzed by: see "By" below

Date

07/13/21
07/13/21

Time

4:49
15:33

Laboratory Data

SDG ID: GC172882
Phoenix ID: CI72898

Project ID: KLSJ JOHN JAY HIGH SCHOOL
Client ID: SK#98

Parameter	Result	RL/ PQL	DIL	Units	AL	MCL	MCLG	Date/Time	By	Reference
Lead	0.0005	0.0005	2	mg/L	0.015			07/16/21	CPP	E200.8
Total Metal Digestion	Completed							07/13/21	B/AG/BF	E200.8

RL/PQL=Minimum Reportable Level DW MCL=Maximum Potability Limit Sec Goal=Recommended Potability Limit NA=Not Applicable

Phyllis Shiller, Lab Director
July 20, 2021

For further interpretation or recommendations on treatment, please contact your local or state health department. Please see last page for additional information.



Environmental Laboratories, Inc.
587 East Middle Turnpike, P.O.Box 370, Manchester, CT 06045



Analysis Report

July 20, 2021

FOR: Attn: Mr. Bob Woodstead
Better Water Well Systems
348 Smith Ridge Rd
South Salem, NY 10590

Sample Information

Matrix: DRINKING WATER
Location Code: BWWS
Rush Request: Standard
P.O.#:

Custody Information

Collected by:
Received by: B
Analyzed by: see "By" below

Date

07/13/21
07/13/21

Time

4:50
15:33

Laboratory Data

SDG ID: GCI72882
Phoenix ID: CI72899

Project ID: KLSJ JOHN JAY HIGH SCHOOL
Client ID: SK#99

Parameter	Result	RL/ PQL	DIL	Units	AL	MCL	MCLG	Date/Time	By	Reference
Lead	0.0104	0.0005	2	mg/L	0.015			07/16/21	CPP	E200.8
Total Metal Digestion	Completed							07/13/21	B/AG/BF	E200.8

RL/PQL=Minimum Reportable Level DW MCL=Maximum Potability Limit Sec Goal=Recommended Potability Limit NA=Not Applicable

Phyllis Shiller, Lab Director
July 20, 2021

For further interpretation or recommendations on treatment, please contact your local or state health department. Please see last page for additional information.



Environmental Laboratories, Inc.
587 East Middle Turnpike, P.O.Box 370, Manchester, CT 06045



Analysis Report

July 20, 2021

FOR: Attn: Mr. Bob Woodstead
Better Water Well Systems
348 Smith Ridge Rd
South Salem, NY 10590

Sample Information

Matrix: DRINKING WATER
Location Code: BWWS
Rush Request: Standard
P.O.#:

Custody Information

Collected by:
Received by: B
Analyzed by: see "By" below

Date

Time

07/13/21 4:51
07/13/21 15:33

Laboratory Data

SDG ID: GCI72882
Phoenix ID: CI72900

Project ID: KLSD JOHN JAY HIGH SCHOOL
Client ID: SK#100

Parameter	Result	RL/ PQL	DIL	Units	AL	MCL	MCLG	Date/Time	By	Reference
Lead	0.0051	0.0005	2	mg/L	0.015			07/16/21	CPP	E200.8
Total Metal Digestion	Completed							07/13/21	B/AG/BF	E200.8

RL/PQL=Minimum Reportable Level DW MCL=Maximum Potability Limit Sec Goal=Recommended Potability Limit NA=Not Applicable

Phyllis Shiller, Lab Director
July 20, 2021

For further interpretation or recommendations on treatment, please contact your local or state health department. Please see last page for additional information.



Environmental Laboratories, Inc.
587 East Middle Turnpike, P.O.Box 370, Manchester, CT 06045



Analysis Report

July 20, 2021

FOR: Attn: Mr. Bob Woodstead
Better Water Well Systems
348 Smith Ridge Rd
South Salem, NY 10590

Sample Information

Matrix: DRINKING WATER
Location Code: BWWS
Rush Request: Standard
P.O.#:

Custody Information

Collected by:
Received by: B
Analyzed by: see "By" below

Date

07/13/21
07/13/21

Time

4:52
15:33

Laboratory Data

SDG ID: GC172882
Phoenix ID: C172901

Project ID: KLSD JOHN JAY HIGH SCHOOL
Client ID: SK#101

Parameter	Result	RL/ PQL	DIL	Units	AL	MCL	MCLG	Date/Time	By	Reference
Lead	0.0139	0.0005	2	mg/L	0.015			07/16/21	CPP	E200.8
Total Metal Digestion	Completed							07/13/21	B/AG/BF	E200.8

RL/PQL=Minimum Reportable Level DW MCL=Maximum Potability Limit Sec Goal=Recommended Potability Limit NA=Not Applicable

Phyllis Shiller, Lab Director
July 20, 2021

For further interpretation or recommendations on treatment, please contact your local or state health department. Please see last page for additional information.



Environmental Laboratories, Inc.
587 East Middle Turnpike, P.O.Box 370, Manchester, CT 06045



Analysis Report

July 20, 2021

FOR: Attn: Mr. Bob Woodstead
Better Water Well Systems
348 Smith Ridge Rd
South Salem, NY 10590

Sample Information

Matrix: DRINKING WATER
Location Code: BWWS
Rush Request: Standard
P.O.#:

Custody Information

Collected by:
Received by: B
Analyzed by: see "By" below

Date

Time

07/13/21 4:53
07/13/21 15:33

Laboratory Data

SDG ID: GCI72882
Phoenix ID: CI72902

Project ID: KLSD JOHN JAY HIGH SCHOOL
Client ID: F+N#102

Parameter	Result	RL/ PQL	DIL	Units	AL	MCL	MCLG	Date/Time	By	Reference
Lead	< 0.0005	0.0005	2	mg/L	0.015			07/16/21	CPP	E200.8
Total Metal Digestion	Completed							07/13/21	B/AG/BF	E200.8

RL/PQL=Minimum Reportable Level DW MCL=Maximum Potability Limit Sec Goal=Recommended Potability Limit NA=Not Applicable

Phyllis Shiller, Lab Director
July 20, 2021

For further interpretation or recommendations on treatment, please contact your local or state health department. Please see last page for additional information.



Environmental Laboratories, Inc.
587 East Middle Turnpike, P.O.Box 370, Manchester, CT 06045



Analysis Report

July 20, 2021

FOR: Attn: Mr. Bob Woodstead
Better Water Well Systems
348 Smith Ridge Rd
South Salem, NY 10590

Sample Information

Matrix: DRINKING WATER
Location Code: BWWS
Rush Request: Standard
P.O.#:

Custody Information

Collected by:
Received by: B
Analyzed by: see "By" below

Date

07/13/21
07/13/21

Time

4:54
15:33

Laboratory Data

SDG ID: GC172882
Phoenix ID: CI72903

Project ID: KLSD JOHN JAY HIGH SCHOOL
Client ID: SK#103

Parameter	Result	RL/ PQL	DIL	Units	AL	MCL	MCLG	Date/Time	By	Reference
Lead	0.0178	0.0005	2	mg/L	0.015			07/16/21	CPP	E200.8
*** Lead exceeds Action Level of 0.015 ***										
Total Metal Digestion	Completed							07/13/21	B/AG/BF	E200.8

RL/PQL=Minimum Reportable Level DW MCL=Maximum Potability Limit Sec Goal=Recommended Potability Limit NA=Not Applicable

Phyllis Shiller, Lab Director
July 20, 2021

For further interpretation or recommendations on treatment, please contact your local or state health department. Please see last page for additional information.



Environmental Laboratories, Inc.
587 East Middle Turnpike, P.O.Box 370, Manchester, CT 06045



Analysis Report

July 20, 2021

FOR: Attn: Mr. Bob Woodstead
Better Water Well Systems
348 Smith Ridge Rd
South Salem, NY 10590

Sample Information

Matrix: DRINKING WATER
Location Code: BWWS
Rush Request: Standard
P.O.#:

Custody Information

Collected by:
Received by: B
Analyzed by: see "By" below

Date

07/13/21
07/13/21

Time

4:57
15:33

Laboratory Data

SDG ID: GC172882
Phoenix ID: C172904

Project ID: KLSD JOHN JAY HIGH SCHOOL
Client ID: SK#104

Parameter	Result	RL/ PQL	DIL	Units	AL	MCL	MCLG	Date/Time	By	Reference
Lead	0.0221	0.0005	2	mg/L	0.015			07/16/21	CPP	E200.8
*** Lead exceeds Action Level of 0.015 ***										
Total Metal Digestion	Completed							07/13/21	B/AG/BF	E200.8

RL/PQL=Minimum Reportable Level DW MCL=Maximum Potability Limit Sec Goal=Recommended Potability Limit NA=Not Applicable

For further interpretation or recommendations on treatment, please contact your local or state health department. Please see last page for additional information.

Phyllis Shiller, Lab Director
July 20, 2021



Environmental Laboratories, Inc.
587 East Middle Turnpike, P.O.Box 370, Manchester, CT 06045



Analysis Report

July 20, 2021

FOR: Attn: Mr. Bob Woodstead
Better Water Well Systems
348 Smith Ridge Rd
South Salem, NY 10590

Sample Information

Matrix: DRINKING WATER
Location Code: BWWS
Rush Request: Standard
P.O.#:

Custody Information

Collected by:
Received by: B
Analyzed by: see "By" below

Date

07/13/21
07/13/21

Time

4:58
15:33

Laboratory Data

SDG ID: GCI72882
Phoenix ID: CI72905

Project ID: KLSD JOHN JAY HIGH SCHOOL
Client ID: SK#104A

Parameter	Result	RL/ PQL	DIL	Units	AL	MCL	MCLG	Date/Time	By	Reference
Lead	0.0196	0.0005	2	mg/L	0.015			07/16/21	CPP	E200.8
*** Lead exceeds Action Level of 0.015 ***										
Total Metal Digestion	Completed							07/13/21	B/AG/BF	E200.8

RL/PQL=Minimum Reportable Level DW MCL=Maximum Potability Limit Sec Goal=Recommended Potability Limit NA=Not Applicable

For further interpretation or recommendations on treatment, please contact your local or state health department. Please see last page for additional information.

Phyllis Shiller, Lab Director
July 20, 2021



Environmental Laboratories, Inc.
587 East Middle Turnpike, P.O.Box 370, Manchester, CT 06045



Analysis Report

July 20, 2021

FOR: Attn: Mr. Bob Woodstead
Better Water Well Systems
348 Smith Ridge Rd
South Salem, NY 10590

Sample Information

Matrix: DRINKING WATER
Location Code: BWWS
Rush Request: Standard
P.O.#:

Custody Information

Collected by:
Received by: B
Analyzed by: see "By" below

Date

07/13/21
07/13/21

Time

4:59
15:33

Laboratory Data

SDG ID: GC172882
Phoenix ID: C172906

Project ID: KLSD JOHN JAY HIGH SCHOOL
Client ID: F+N#105

Parameter	Result	RL/ PQL	DIL	Units	AL	MCL	MCLG	Date/Time	By	Reference
Lead	0.0107	0.0005	2	mg/L	0.015			07/16/21	CPP	E200.8
Total Metal Digestion	Completed							07/13/21	B/AG/BF	E200.8

RL/PQL=Minimum Reportable Level DW MCL=Maximum Potability Limit Sec Goal=Recommended Potability Limit NA=Not Applicable

Phyllis Shiller, Lab Director
July 20, 2021

For further interpretation or recommendations on treatment, please contact your local or state health department. Please see last page for additional information.



Environmental Laboratories, Inc.
587 East Middle Turnpike, P.O.Box 370, Manchester, CT 06045



Analysis Report

July 20, 2021

FOR: Attn: Mr. Bob Woodstead
Better Water Well Systems
348 Smith Ridge Rd
South Salem, NY 10590

Sample Information

Matrix: DRINKING WATER
Location Code: BWWS
Rush Request: Standard
P.O.#:

Custody Information

Collected by:
Received by: B
Analyzed by: see "By" below

Date

07/13/21
07/13/21

Time

5:01
15:33

Laboratory Data

SDG ID: GC172882
Phoenix ID: CI72907

Project ID: KLSD JOHN JAY HIGH SCHOOL
Client ID: SK#106

Parameter	Result	RL/ PQL	DIL	Units	AL	MCL	MCLG	Date/Time	By	Reference
Lead	0.0048	0.0005	2	mg/L	0.015			07/16/21	CPP	E200.8
Total Metal Digestion	Completed							07/13/21	B/AG/BF	E200.8

RL/PQL=Minimum Reportable Level DW MCL=Maximum Potability Limit Sec Goal=Recommended Potability Limit NA=Not Applicable

Phyllis Shiller, Lab Director
July 20, 2021

For further interpretation or recommendations on treatment, please contact your local or state health department. Please see last page for additional information.



Environmental Laboratories, Inc.
587 East Middle Turnpike, P.O.Box 370, Manchester, CT 06045



Analysis Report

July 20, 2021

FOR: Attn: Mr. Bob Woodstead
Better Water Well Systems
348 Smith Ridge Rd
South Salem, NY 10590

Sample Information

Matrix: DRINKING WATER
Location Code: BWWS
Rush Request: Standard
P.O.#:

Custody Information

Collected by:
Received by: B
Analyzed by: see "By" below

Date

07/13/21
07/13/21

Time

5:02
15:33

Laboratory Data

SDG ID: GCI72882
Phoenix ID: CI72908

Project ID: KLSD JOHN JAY HIGH SCHOOL
Client ID: SK#106A

Parameter	Result	RL/ PQL	DIL	Units	AL	MCL	MCLG	Date/Time	By	Reference
Lead	0.0136	0.0005	2	mg/L	0.015			07/16/21	CPP	E200.8
Total Metal Digestion	Completed							07/13/21	B/AG/BF	E200.8

RL/PQL=Minimum Reportable Level DW MCL=Maximum Potability Limit Sec Goal=Recommended Potability Limit NA=Not Applicable

Phyllis Shiller, Lab Director
July 20, 2021

For further interpretation or recommendations on treatment, please contact your local or state health department. Please see last page for additional information.



Environmental Laboratories, Inc.
587 East Middle Turnpike, P.O.Box 370, Manchester, CT 06045



Analysis Report

July 20, 2021

FOR: Attn: Mr. Bob Woodstead
Better Water Well Systems
348 Smith Ridge Rd
South Salem, NY 10590

Sample Information

Matrix: DRINKING WATER
Location Code: BWWS
Rush Request: Standard
P.O.#:

Custody Information

Collected by:
Received by: B
Analyzed by: see "By" below

Date

Time

07/13/21 5:05
07/13/21 15:33

Laboratory Data

SDG ID: GC172882
Phoenix ID: CI72909

Project ID: KLSD JOHN JAY HIGH SCHOOL
Client ID: SK#107

Parameter	Result	RL/ PQL	DIL	Units	AL	MCL	MCLG	Date/Time	By	Reference
Lead	0.0019	0.0005	2	mg/L	0.015			07/16/21	CPP	E200.8
Total Metal Digestion	Completed							07/13/21	B/AG/BF	E200.8

RL/PQL=Minimum Reportable Level DW MCL=Maximum Potability Limit Sec Goal=Recommended Potability Limit NA=Not Applicable

Phyllis Shiller, Lab Director
July 20, 2021

For further interpretation or recommendations on treatment, please contact your local or state health department. Please see last page for additional information.



Environmental Laboratories, Inc.
587 East Middle Turnpike, P.O.Box 370, Manchester, CT 06045



Analysis Report

July 20, 2021

FOR: Attn: Mr. Bob Woodstead
Better Water Well Systems
348 Smith Ridge Rd
South Salem, NY 10590

Sample Information

Matrix: DRINKING WATER
Location Code: BWWS
Rush Request: Standard
P.O.#:

Custody Information

Collected by:
Received by: B
Analyzed by: see "By" below

Date

07/13/21
07/13/21

Time

5:08
15:33

Laboratory Data

SDG ID: GC172882
Phoenix ID: C172910

Project ID: KLSD JOHN JAY HIGH SCHOOL
Client ID: SK#114

Parameter	Result	RL/ PQL	DIL	Units	AL	MCL	MCLG	Date/Time	By	Reference
Lead	0.0389	0.0005	2	mg/L	0.015			07/16/21	CPP	E200.8
*** Lead exceeds Action Level of 0.015 ***										
Total Metal Digestion	Completed							07/13/21	B/AG/BF	E200.8

RL/PQL=Minimum Reportable Level DW MCL=Maximum Potability Limit Sec Goal=Recommended Potability Limit NA=Not Applicable

Phyllis Shiller, Lab Director
July 20, 2021

For further interpretation or recommendations on treatment, please contact your local or state health department. Please see last page for additional information.



Environmental Laboratories, Inc.
587 East Middle Turnpike, P.O.Box 370, Manchester, CT 06045



Analysis Report

July 20, 2021

FOR: Attn: Mr. Bob Woodstead
Better Water Well Systems
348 Smith Ridge Rd
South Salem, NY 10590

Sample Information

Matrix: DRINKING WATER
Location Code: BWWS
Rush Request: Standard
P.O.#:

Custody Information

Collected by:
Received by: B
Analyzed by: see "By" below

Date

07/13/21
07/13/21

Time

5:09
15:33

Laboratory Data

SDG ID: GC172882
Phoenix ID: C172911

Project ID: KLSD JOHN JAY HIGH SCHOOL
Client ID: SK#116

Parameter	Result	RL/ PQL	DIL	Units	AL	MCL	MCLG	Date/Time	By	Reference
Lead	0.0236	0.0005	2	mg/L	0.015			07/16/21	CPP	E200.8
*** Lead exceeds Action Level of 0.015 ***										
Total Metal Digestion	Completed							07/13/21	B/AG/BF	E200.8

RL/PQL=Minimum Reportable Level DW MCL=Maximum Potability Limit Sec Goal=Recommended Potability Limit NA=Not Applicable

Phyllis Shiller, Lab Director
July 20, 2021

For further interpretation or recommendations on treatment, please contact your local or state health department. Please see last page for additional information.



Environmental Laboratories, Inc.
587 East Middle Turnpike, P.O.Box 370, Manchester, CT 06045



Analysis Report

July 20, 2021

FOR: Attn: Mr. Bob Woodstead
Better Water Well Systems
348 Smith Ridge Rd
South Salem, NY 10590

Sample Information

Matrix: DRINKING WATER
Location Code: BWWS
Rush Request: Standard
P.O.#:

Custody Information

Collected by:
Received by: B
Analyzed by: see "By" below

Date

07/13/21
07/13/21

Time

5:15
15:33

Laboratory Data

SDG ID: GC172882
Phoenix ID: C172912

Project ID: KLSD JOHN JAY HIGH SCHOOL
Client ID: SK#117

Parameter	Result	RL/ PQL	DIL	Units	AL	MCL	MCLG	Date/Time	By	Reference
Lead	0.0079	0.0005	2	mg/L	0.015			07/16/21	CPP	E200.8
Total Metal Digestion	Completed							07/13/21	B/AG/BF	E200.8

RL/PQL=Minimum Reportable Level DW MCL=Maximum Potability Limit Sec Goal=Recommended Potability Limit NA=Not Applicable

Phyllis Shiller, Lab Director
July 20, 2021

For further interpretation or recommendations on treatment, please contact your local or state health department. Please see last page for additional information.



Environmental Laboratories, Inc.
587 East Middle Turnpike, P.O.Box 370, Manchester, CT 06045



Analysis Report

July 20, 2021

FOR: Attn: Mr. Bob Woodstead
Better Water Well Systems
348 Smith Ridge Rd
South Salem, NY 10590

Sample Information

Matrix: DRINKING WATER
Location Code: BWWS
Rush Request: Standard
P.O.#:

Custody Information

Collected by:
Received by: B
Analyzed by: see "By" below

Date

07/13/21
07/13/21

Time

5:17
15:33

Laboratory Data

SDG ID: GCI72882
Phoenix ID: CI72913

Project ID: KLSD JOHN JAY HIGH SCHOOL
Client ID: F+N#118

Parameter	Result	RL/ PQL	DIL	Units	AL	MCL	MCLG	Date/Time	By	Reference
Lead	0.0462	0.0005	2	mg/L	0.015			07/16/21	CPP	E200.8
*** Lead exceeds Action Level of 0.015 ***										
Total Metal Digestion	Completed							07/13/21	B/AG/BF	E200.8

RL/PQL=Minimum Reportable Level DW MCL=Maximum Potability Limit Sec Goal=Recommended Potability Limit NA=Not Applicable

For further interpretation or recommendations on treatment, please contact your local or state health department. Please see last page for additional information.

Phyllis Shiller, Lab Director
July 20, 2021



Environmental Laboratories, Inc.
587 East Middle Turnpike, P.O.Box 370, Manchester, CT 06045



Analysis Report

July 20, 2021

FOR: Attn: Mr. Bob Woodstead
Better Water Well Systems
348 Smith Ridge Rd
South Salem, NY 10590

Sample Information

Matrix: DRINKING WATER
Location Code: BWWS
Rush Request: Standard
P.O.#:

Custody Information

Collected by:
Received by: B
Analyzed by: see "By" below

Date

07/13/21
07/13/21

Time

5:20
15:33

Laboratory Data

SDG ID: GC172882
Phoenix ID: C172914

Project ID: KLSD JOHN JAY HIGH SCHOOL
Client ID: F+N#122

Parameter	Result	RL/ PQL	DIL	Units	AL	MCL	MCLG	Date/Time	By	Reference
Lead	0.0061	0.0005	2	mg/L	0.015			07/16/21	CPP	E200.8
Total Metal Digestion	Completed							07/13/21	B/AG/BF	E200.8

RL/PQL=Minimum Reportable Level DW MCL=Maximum Potability Limit Sec Goal=Recommended Potability Limit NA=Not Applicable

Phyllis Shiller, Lab Director
July 20, 2021

For further interpretation or recommendations on treatment, please contact your local or state health department. Please see last page for additional information.



Environmental Laboratories, Inc.
587 East Middle Turnpike, P.O.Box 370, Manchester, CT 06045



Analysis Report

July 20, 2021

FOR: Attn: Mr. Bob Woodstead
Better Water Well Systems
348 Smith Ridge Rd
South Salem, NY 10590

Sample Information

Matrix: DRINKING WATER
Location Code: BWWS
Rush Request: Standard
P.O.#:

Custody Information

Collected by:
Received by: B
Analyzed by: see "By" below

Date

07/13/21
07/13/21

Time

5:21
15:33

Laboratory Data

SDG ID: GC172882
Phoenix ID: C172915

Project ID: KLSJ JOHN JAY HIGH SCHOOL
Client ID: F+N#123

Parameter	Result	RL/ PQL	DIL	Units	AL	MCL	MCLG	Date/Time	By	Reference
Lead	0.0113	0.0005	2	mg/L	0.015			07/16/21	CPP	E200.8
Total Metal Digestion	Completed							07/13/21	B/AG/BF	E200.8

RL/PQL=Minimum Reportable Level DW MCL=Maximum Potability Limit Sec Goal=Recommended Potability Limit NA=Not Applicable

Phyllis Shiller, Lab Director
July 20, 2021

For further interpretation or recommendations on treatment, please contact your local or state health department. Please see last page for additional information.



Environmental Laboratories, Inc.
587 East Middle Turnpike, P.O.Box 370, Manchester, CT 06045



Analysis Report

July 20, 2021

FOR: Attn: Mr. Bob Woodstead
Better Water Well Systems
348 Smith Ridge Rd
South Salem, NY 10590

Sample Information

Matrix: DRINKING WATER
Location Code: BWWS
Rush Request: Standard
P.O.#:

Custody Information

Collected by:
Received by: B
Analyzed by: see "By" below

Date Time

07/13/21 5:22
07/13/21 15:33

Laboratory Data

SDG ID: GC172882
Phoenix ID: C172916

Project ID: KLSD JOHN JAY HIGH SCHOOL
Client ID: SK#124

Parameter	Result	RL/ PQL	DIL	Units	AL	MCL	MCLG	Date/Time	By	Reference
Lead	0.0067	0.0005	2	mg/L	0.015			07/16/21	CPP	E200.8
Total Metal Digestion	Completed							07/13/21	B/AG/BF	E200.8

RL/PQL=Minimum Reportable Level DW MCL=Maximum Potability Limit Sec Goal=Recommended Potability Limit NA=Not Applicable

Phyllis Shiller, Lab Director
July 20, 2021

For further interpretation or recommendations on treatment, please contact your local or state health department. Please see last page for additional information.



Environmental Laboratories, Inc.
587 East Middle Turnpike, P.O.Box 370, Manchester, CT 06045



Analysis Report

July 20, 2021

FOR: Attn: Mr. Bob Woodstead
Better Water Well Systems
348 Smith Ridge Rd
South Salem, NY 10590

Sample Information

Matrix: DRINKING WATER
Location Code: BWWS
Rush Request: Standard
P.O.#:

Custody Information

Collected by:
Received by: B
Analyzed by: see "By" below

Date

07/13/21
07/13/21

Time

5:23
15:33

Laboratory Data

SDG ID: GCI72882
Phoenix ID: CI72917

Project ID: KLSJ JOHN JAY HIGH SCHOOL
Client ID: SK#125

Parameter	Result	RL/ PQL	DIL	Units	AL	MCL	MCLG	Date/Time	By	Reference
Lead	0.0069	0.0005	2	mg/L	0.015			07/16/21	CPP	E200.8
Total Metal Digestion	Completed							07/13/21	B/AG/BF	E200.8

RL/PQL=Minimum Reportable Level DW MCL=Maximum Potability Limit Sec Goal=Recommended Potability Limit NA=Not Applicable

Phyllis Shiller, Lab Director
July 20, 2021

For further interpretation or recommendations on treatment, please contact your local or state health department. Please see last page for additional information.



Environmental Laboratories, Inc.
587 East Middle Turnpike, P.O.Box 370, Manchester, CT 06045



Analysis Report

July 20, 2021

FOR: Attn: Mr. Bob Woodstead
Better Water Well Systems
348 Smith Ridge Rd
South Salem, NY 10590

Sample Information

Matrix: DRINKING WATER
Location Code: BWWS
Rush Request: Standard
P.O.#:

Custody Information

Collected by:
Received by: B
Analyzed by: see "By" below

Date

07/13/21
07/13/21

Time

5:29
15:33

Laboratory Data

SDG ID: GC172882
Phoenix ID: C172918

Project ID: KLSD JOHN JAY HIGH SCHOOL
Client ID: F+N#176

Parameter	Result	RL/ PQL	DIL	Units	AL	MCL	MCLG	Date/Time	By	Reference
Lead	0.0406	0.0005	2	mg/L	0.015			07/16/21	CPP	E200.8
*** Lead exceeds Action Level of 0.015 ***										
Total Metal Digestion	Completed							07/13/21	B/AG/BF	E200.8

RL/PQL=Minimum Reportable Level DW MCL=Maximum Potability Limit Sec Goal=Recommended Potability Limit NA=Not Applicable

Phyllis Shiller, Lab Director
July 20, 2021

For further interpretation or recommendations on treatment, please contact your local or state health department. Please see last page for additional information.



Environmental Laboratories, Inc.
587 East Middle Turnpike, P.O.Box 370, Manchester, CT 06045



Analysis Report

July 20, 2021

FOR: Attn: Mr. Bob Woodstead
Better Water Well Systems
348 Smith Ridge Rd
South Salem, NY 10590

Sample Information

Matrix: DRINKING WATER
Location Code: BWWS
Rush Request: Standard
P.O.#:

Custody Information

Collected by:
Received by: B
Analyzed by: see "By" below

Date

07/13/21
07/13/21

Time

5:31
15:33

Laboratory Data

SDG ID: GC172882
Phoenix ID: C172919

Project ID: KLSD JOHN JAY HIGH SCHOOL
Client ID: SK#180

Parameter	Result	RL/ PQL	DIL	Units	AL	MCL	MCLG	Date/Time	By	Reference
Lead	3.04	0.013	50	mg/L	0.015			07/16/21	CPP	E200.8
*** Lead exceeds Action Level of 0.015 ***										
Total Metal Digestion	Completed							07/13/21	B/AG/BF	E200.8

RL/PQL=Minimum Reportable Level DW MCL=Maximum Potability Limit Sec Goal=Recommended Potability Limit NA=Not Applicable

Phyllis Shiller, Lab Director
July 20, 2021

For further interpretation or recommendations on treatment, please contact your local or state health department. Please see last page for additional information.



Environmental Laboratories, Inc.
587 East Middle Turnpike, P.O.Box 370, Manchester, CT 06045



Analysis Report

July 20, 2021

FOR: Attn: Mr. Bob Woodstead
Better Water Well Systems
348 Smith Ridge Rd
South Salem, NY 10590

Sample Information

Matrix: DRINKING WATER
Location Code: BWWS
Rush Request: Standard
P.O.#:

Custody Information

Collected by:
Received by: B
Analyzed by: see "By" below

Date

07/13/21
07/13/21

Time

5:34
15:33

Laboratory Data

SDG ID: GC172882
Phoenix ID: C172920

Project ID: KLSD JOHN JAY HIGH SCHOOL
Client ID: SK#181

Parameter	Result	RL/ PQL	DIL	Units	AL	MCL	MCLG	Date/Time	By	Reference
Lead	0.0619	0.0005	2	mg/L	0.015			07/16/21	CPP	E200.8
*** Lead exceeds Action Level of 0.015 ***										
Total Metal Digestion	Completed							07/13/21	B/AG/BF	E200.8

RL/PQL=Minimum Reportable Level DW MCL=Maximum Potability Limit Sec Goal=Recommended Potability Limit NA=Not Applicable

For further interpretation or recommendations on treatment, please contact your local or state health department. Please see last page for additional information.

Phyllis Shiller, Lab Director
July 20, 2021



Environmental Laboratories, Inc.
587 East Middle Turnpike, P.O.Box 370, Manchester, CT 06045



Analysis Report

July 20, 2021

FOR: Attn: Mr. Bob Woodstead
Better Water Well Systems
348 Smith Ridge Rd
South Salem, NY 10590

Sample Information

Matrix: DRINKING WATER
Location Code: BWWS
Rush Request: Standard
P.O.#:

Custody Information

Collected by:
Received by: B
Analyzed by: see "By" below

Date

07/13/21
07/13/21

Time

5:34
15:33

Laboratory Data

SDG ID: GC172882
Phoenix ID: C172921

Project ID: KLSD JOHN JAY HIGH SCHOOL
Client ID: SK#182

Parameter	Result	RL/ PQL	DIL	Units	AL	MCL	MCLG	Date/Time	By	Reference
Lead	0.0426	0.0005	2	mg/L	0.015			07/16/21	CPP	E200.8
*** Lead exceeds Action Level of 0.015 ***										
Total Metal Digestion	Completed							07/13/21	B/AG/BF	E200.8

RL/PQL=Minimum Reportable Level DW MCL=Maximum Potability Limit Sec Goal=Recommended Potability Limit NA=Not Applicable

Phyllis Shiller, Lab Director
July 20, 2021

For further interpretation or recommendations on treatment, please contact your local or state health department. Please see last page for additional information.



Environmental Laboratories, Inc.
587 East Middle Turnpike, P.O.Box 370, Manchester, CT 06045



Analysis Report

July 20, 2021

FOR: Attn: Mr. Bob Woodstead
Better Water Well Systems
348 Smith Ridge Rd
South Salem, NY 10590

Sample Information

Matrix: DRINKING WATER
Location Code: BWWS
Rush Request: Standard
P.O.#:

Custody Information

Collected by:
Received by: B
Analyzed by: see "By" below

Date

07/13/21
07/13/21

Time

5:36
15:33

Laboratory Data

SDG ID: GCI72882
Phoenix ID: CI72922

Project ID: KLSJ JOHN JAY HIGH SCHOOL
Client ID: SK#184

Parameter	Result	RL/ PQL	DIL	Units	AL	MCL	MCLG	Date/Time	By	Reference
Lead	0.0159	0.0005	2	mg/L	0.015			07/16/21	CPP	E200.8
*** Lead exceeds Action Level of 0.015 ***										
Total Metal Digestion	Completed							07/13/21	B/AG/BF	E200.8

RL/PQL=Minimum Reportable Level DW MCL=Maximum Potability Limit Sec Goal=Recommended Potability Limit NA=Not Applicable

For further interpretation or recommendations on treatment, please contact your local or state health department. Please see last page for additional information.

Phyllis Shiller, Lab Director
July 20, 2021



Environmental Laboratories, Inc.
587 East Middle Turnpike, P.O.Box 370, Manchester, CT 06045



Analysis Report

July 20, 2021

FOR: Attn: Mr. Bob Woodstead
Better Water Well Systems
348 Smith Ridge Rd
South Salem, NY 10590

Sample Information

Matrix: DRINKING WATER
Location Code: BWWS
Rush Request: Standard
P.O.#:

Custody Information

Collected by:
Received by: B
Analyzed by: see "By" below

Date

07/13/21
07/13/21

Time

5:37
15:33

Laboratory Data

SDG ID: GCI72882
Phoenix ID: C172923

Project ID: KLSD JOHN JAY HIGH SCHOOL
Client ID: SK#184A

Parameter	Result	RL/ PQL	DIL	Units	AL	MCL	MCLG	Date/Time	By	Reference
Lead	0.0049	0.0005	2	mg/L	0.015			07/16/21	CPP	E200.8
Total Metal Digestion	Completed							07/13/21	B/AG/BF	E200.8

RL/PQL=Minimum Reportable Level DW MCL=Maximum Potability Limit Sec Goal=Recommended Potability Limit NA=Not Applicable

Phyllis Shiller, Lab Director
July 20, 2021

For further interpretation or recommendations on treatment, please contact your local or state health department. Please see last page for additional information.



Environmental Laboratories, Inc.
587 East Middle Turnpike, P.O.Box 370, Manchester, CT 06045



Analysis Report

July 20, 2021

FOR: Attn: Mr. Bob Woodstead
Better Water Well Systems
348 Smith Ridge Rd
South Salem, NY 10590

Sample Information

Matrix: DRINKING WATER
Location Code: BWWS
Rush Request: Standard
P.O.#:

Custody Information

Collected by:
Received by: B
Analyzed by: see "By" below

Date

07/13/21
07/13/21

Time

5:38
15:33

Laboratory Data

SDG ID: GC172882
Phoenix ID: CI72924

Project ID: KLSD JOHN JAY HIGH SCHOOL
Client ID: SK#184B

Parameter	Result	RL/ PQL	DIL	Units	AL	MCL	MCLG	Date/Time	By	Reference
Lead	0.0077	0.0005	2	mg/L	0.015			07/16/21	CPP	E200.8
Total Metal Digestion	Completed							07/13/21	B/AG/BF	E200.8

RL/PQL=Minimum Reportable Level DW MCL=Maximum Potability Limit Sec Goal=Recommended Potability Limit NA=Not Applicable

For further interpretation or recommendations on treatment, please contact your local or state health department. Please see last page for additional information.

Phyllis Shiller, Lab Director
July 20, 2021



Environmental Laboratories, Inc.
587 East Middle Turnpike, P.O.Box 370, Manchester, CT 06045



Analysis Report

July 20, 2021

FOR: Attn: Mr. Bob Woodstead
Better Water Well Systems
348 Smith Ridge Rd
South Salem, NY 10590

Sample Information

Matrix: DRINKING WATER
Location Code: BWWS
Rush Request: Standard
P.O.#:

Custody Information

Collected by:
Received by: B
Analyzed by: see "By" below

Date

07/13/21
07/13/21

Time

5:39
15:33

Laboratory Data

SDG ID: GC172882
Phoenix ID: C172925

Project ID: KLSJ JOHN JAY HIGH SCHOOL
Client ID: SK#184C

Parameter	Result	RL/ PQL	DIL	Units	AL	MCL	MCLG	Date/Time	By	Reference
Lead	0.0071	0.0005	2	mg/L	0.015			07/16/21	CPP	E200.8
Total Metal Digestion	Completed							07/13/21	B/AG/BF	E200.8

RL/PQL=Minimum Reportable Level DW MCL=Maximum Potability Limit Sec Goal=Recommended Potability Limit NA=Not Applicable

Phyllis Shiller, Lab Director
July 20, 2021

For further interpretation or recommendations on treatment, please contact your local or state health department. Please see last page for additional information.



Environmental Laboratories, Inc.
587 East Middle Turnpike, P.O.Box 370, Manchester, CT 06045



Analysis Report

July 20, 2021

FOR: Attn: Mr. Bob Woodstead
Better Water Well Systems
348 Smith Ridge Rd
South Salem, NY 10590

Sample Information

Matrix: DRINKING WATER
Location Code: BWWS
Rush Request: Standard
P.O.#:

Custody Information

Collected by:
Received by: B
Analyzed by: see "By" below

Date

07/13/21
07/13/21

Time

5:35
15:33

Laboratory Data

SDG ID: GC172882
Phoenix ID: C172926

Project ID: KLSJ JOHN JAY HIGH SCHOOL
Client ID: SK#183

Parameter	Result	RL/ PQL	DIL	Units	AL	MCL	MCLG	Date/Time	By	Reference
Lead	0.0395	0.0005	2	mg/L	0.015			07/16/21	CPP	E200.8
*** Lead exceeds Action Level of 0.015 ***										
Total Metal Digestion	Completed							07/13/21	B/AG/BF	E200.8

RL/PQL=Minimum Reportable Level DW MCL=Maximum Potability Limit Sec Goal=Recommended Potability Limit NA=Not Applicable

For further interpretation or recommendations on treatment, please contact your local or state health department. Please see last page for additional information.

Phyllis Shiller, Lab Director
July 20, 2021



Environmental Laboratories, Inc.
587 East Middle Turnpike, P.O.Box 370, Manchester, CT 06045



Analysis Report

July 20, 2021

FOR: Attn: Mr. Bob Woodstead
Better Water Well Systems
348 Smith Ridge Rd
South Salem, NY 10590

Sample Information

Matrix: DRINKING WATER
Location Code: BWWS
Rush Request: Standard
P.O.#:

Custody Information

Collected by:
Received by: B
Analyzed by: see "By" below

Date

Time

07/13/21 5:50
07/13/21 15:33

Laboratory Data

SDG ID: GCI72882
Phoenix ID: CI72927

Project ID: KLSJ JOHN JAY HIGH SCHOOL
Client ID: SK#185

Parameter	Result	RL/ PQL	DIL	Units	AL	MCL	MCLG	Date/Time	By	Reference
Lead	0.0048	0.0005	2	mg/L	0.015			07/16/21	CPP	E200.8
Total Metal Digestion	Completed							07/13/21	B/AG/BF	E200.8

RL/PQL=Minimum Reportable Level DW MCL=Maximum Potability Limit Sec Goal=Recommended Potability Limit NA=Not Applicable

Phyllis Shiller, Lab Director
July 20, 2021

For further interpretation or recommendations on treatment, please contact your local or state health department. Please see last page for additional information.



Environmental Laboratories, Inc.
587 East Middle Turnpike, P.O.Box 370, Manchester, CT 06045



Analysis Report

July 20, 2021

FOR: Attn: Mr. Bob Woodstead
Better Water Well Systems
348 Smith Ridge Rd
South Salem, NY 10590

Sample Information

Matrix: DRINKING WATER
Location Code: BWWS
Rush Request: Standard
P.O.#:

Custody Information

Collected by:
Received by: B
Analyzed by: see "By" below

Date

Time

07/13/21 5:51
07/13/21 15:33

Laboratory Data

SDG ID: GC172882
Phoenix ID: CI72928

Project ID: KLSD JOHN JAY HIGH SCHOOL
Client ID: SK#186

Parameter	Result	RL/ PQL	DIL	Units	AL	MCL	MCLG	Date/Time	By	Reference
Lead	0.0109	0.0005	2	mg/L	0.015			07/16/21	CPP	E200.8
Total Metal Digestion	Completed							07/13/21	B/AG/BF	E200.8

RL/PQL=Minimum Reportable Level DW MCL=Maximum Potability Limit Sec Goal=Recommended Potability Limit NA=Not Applicable

Phyllis Shiller, Lab Director
July 20, 2021

For further interpretation or recommendations on treatment, please contact your local or state health department. Please see last page for additional information.



Environmental Laboratories, Inc.
587 East Middle Turnpike, P.O.Box 370, Manchester, CT 06045



Analysis Report

July 20, 2021

FOR: Attn: Mr. Bob Woodstead
Better Water Well Systems
348 Smith Ridge Rd
South Salem, NY 10590

Sample Information

Matrix: DRINKING WATER
Location Code: BWWS
Rush Request: Standard
P.O.#:

Custody Information

Collected by:
Received by: B
Analyzed by: see "By" below

Date

07/13/21
07/13/21

Time

5:51
15:33

Laboratory Data

SDG ID: GC172882
Phoenix ID: C172929

Project ID: KLSD JOHN JAY HIGH SCHOOL
Client ID: SK#187

Parameter	Result	RL/ PQL	DIL	Units	AL	MCL	MCLG	Date/Time	By	Reference
Lead	0.0091	0.0005	2	mg/L	0.015			07/16/21	CPP	E200.8
Total Metal Digestion	Completed							07/13/21	B/AG/BF	E200.8

RL/PQL=Minimum Reportable Level DW MCL=Maximum Potability Limit Sec Goal=Recommended Potability Limit NA=Not Applicable

For further interpretation or recommendations on treatment, please contact your local or state health department. Please see last page for additional information.

Phyllis Shiller, Lab Director
July 20, 2021



Environmental Laboratories, Inc.
587 East Middle Turnpike, P.O.Box 370, Manchester, CT 06045



Analysis Report

July 20, 2021

FOR: Attn: Mr. Bob Woodstead
Better Water Well Systems
348 Smith Ridge Rd
South Salem, NY 10590

Sample Information

Matrix: DRINKING WATER
Location Code: BWWS
Rush Request: Standard
P.O.#:

Custody Information

Collected by:
Received by: B
Analyzed by: see "By" below

Date

07/13/21
07/13/21

Time

5:53
15:33

Laboratory Data

SDG ID: GC172882
Phoenix ID: C172930

Project ID: KLSD JOHN JAY HIGH SCHOOL
Client ID: SK#188

Parameter	Result	RL/ PQL	DIL	Units	AL	MCL	MCLG	Date/Time	By	Reference
Lead	0.0674	0.0005	2	mg/L	0.015			07/16/21	CPP	E200.8
*** Lead exceeds Action Level of 0.015 ***										
Total Metal Digestion	Completed							07/13/21	B/AG/BF	E200.8

RL/PQL=Minimum Reportable Level DW MCL=Maximum Potability Limit Sec Goal=Recommended Potability Limit NA=Not Applicable

For further interpretation or recommendations on treatment, please contact your local or state health department. Please see last page for additional information.

Phyllis Shiller, Lab Director
July 20, 2021



Environmental Laboratories, Inc.
587 East Middle Turnpike, P.O.Box 370, Manchester, CT 06045



Analysis Report

July 20, 2021

FOR: Attn: Mr. Bob Woodstead
Better Water Well Systems
348 Smith Ridge Rd
South Salem, NY 10590

Sample Information

Matrix: DRINKING WATER
Location Code: BWWS
Rush Request: Standard
P.O.#:

Custody Information

Collected by:
Received by: B
Analyzed by: see "By" below

Date

07/13/21
07/13/21

Time

5:54
15:33

Laboratory Data

SDG ID: GC172882
Phoenix ID: C172931

Project ID: KLSD JOHN JAY HIGH SCHOOL
Client ID: SK#189

Parameter	Result	RL/ PQL	DIL	Units	AL	MCL	MCLG	Date/Time	By	Reference
Lead	0.0155	0.0005	2	mg/L	0.015			07/16/21	CPP	E200.8
*** Lead exceeds Action Level of 0.015 ***										
Total Metal Digestion	Completed							07/13/21	B/AG/BF	E200.8

RL/PQL=Minimum Reportable Level DW MCL=Maximum Potability Limit Sec Goal=Recommended Potability Limit NA=Not Applicable

Phyllis Shiller, Lab Director
July 20, 2021

For further interpretation or recommendations on treatment, please contact your local or state health department. Please see last page for additional information.



Environmental Laboratories, Inc.
587 East Middle Turnpike, P.O.Box 370, Manchester, CT 06045



Analysis Report

July 20, 2021

FOR: Attn: Mr. Bob Woodstead
Better Water Well Systems
348 Smith Ridge Rd
South Salem, NY 10590

Sample Information

Matrix: DRINKING WATER
Location Code: BWWS
Rush Request: Standard
P.O.#:

Custody Information

Collected by:
Received by: B
Analyzed by: see "By" below

Date

07/13/21
07/13/21

Time

5:54
15:33

Laboratory Data

SDG ID: GCI72882
Phoenix ID: CI72932

Project ID: KLSD JOHN JAY HIGH SCHOOL
Client ID: SK#190

Parameter	Result	RL/ PQL	DIL	Units	AL	MCL	MCLG	Date/Time	By	Reference
Lead	0.0061	0.0005	2	mg/L	0.015			07/16/21	CPP	E200.8
Total Metal Digestion	Completed							07/14/21	AG	E200.8

RL/PQL=Minimum Reportable Level DW MCL=Maximum Potability Limit Sec Goal=Recommended Potability Limit NA=Not Applicable

For further interpretation or recommendations on treatment, please contact your local or state health department. Please see last page for additional information.

Phyllis Shiller, Lab Director
July 20, 2021



Environmental Laboratories, Inc.
587 East Middle Turnpike, P.O.Box 370, Manchester, CT 06045



Analysis Report

July 20, 2021

FOR: Attn: Mr. Bob Woodstead
Better Water Well Systems
348 Smith Ridge Rd
South Salem, NY 10590

Sample Information

Matrix: DRINKING WATER
Location Code: BWWS
Rush Request: Standard
P.O.#:

Custody Information

Collected by:
Received by: B
Analyzed by: see "By" below

Date

07/13/21
07/13/21

Time

5:59
15:33

Laboratory Data

SDG ID: GCI72882
Phoenix ID: CI72933

Project ID: KLSD JOHN JAY HIGH SCHOOL
Client ID: SK#191

Parameter	Result	RL/ PQL	DIL	Units	AL	MCL	MCLG	Date/Time	By	Reference
Lead	0.0135	0.0005	2	mg/L	0.015			07/16/21	CPP	E200.8
Total Metal Digestion	Completed							07/14/21	AG	E200.8

RL/PQL=Minimum Reportable Level DW MCL=Maximum Potability Limit Sec Goal=Recommended Potability Limit NA=Not Applicable

Phyllis Shiller, Lab Director
July 20, 2021

For further interpretation or recommendations on treatment, please contact your local or state health department. Please see last page for additional information.



Environmental Laboratories, Inc.
587 East Middle Turnpike, P.O.Box 370, Manchester, CT 06045



Analysis Report

July 20, 2021

FOR: Attn: Mr. Bob Woodstead
Better Water Well Systems
348 Smith Ridge Rd
South Salem, NY 10590

Sample Information

Matrix: DRINKING WATER
Location Code: BWWS
Rush Request: Standard
P.O.#:

Custody Information

Collected by:
Received by: B
Analyzed by: see "By" below

Date

07/13/21
07/13/21

Time

6:00
15:33

Laboratory Data

SDG ID: GC172882
Phoenix ID: C172934

Project ID: KLSD JOHN JAY HIGH SCHOOL
Client ID: SK#192

Parameter	Result	RL/ PQL	DIL	Units	AL	MCL	MCLG	Date/Time	By	Reference
Lead	0.0272	0.0005	2	mg/L	0.015			07/16/21	CPP	E200.8
*** Lead exceeds Action Level of 0.015 ***										
Total Metal Digestion	Completed							07/14/21	AG	E200.8

RL/PQL=Minimum Reportable Level DW MCL=Maximum Potability Limit Sec Goal=Recommended Potability Limit NA=Not Applicable

For further interpretation or recommendations on treatment, please contact your local or state health department. Please see last page for additional information.

Phyllis Shiller, Lab Director
July 20, 2021



Environmental Laboratories, Inc.
587 East Middle Turnpike, P.O.Box 370, Manchester, CT 06045



Analysis Report

July 20, 2021

FOR: Attn: Mr. Bob Woodstead
Better Water Well Systems
348 Smith Ridge Rd
South Salem, NY 10590

Sample Information

Matrix: DRINKING WATER
Location Code: BWWS
Rush Request: Standard
P.O.#:

Custody Information

Collected by:
Received by: B
Analyzed by: see "By" below

Date

Time

07/13/21 6:01
07/13/21 15:33

Laboratory Data

SDG ID: GC172882
Phoenix ID: C172935

Project ID: KLSJ JOHN JAY HIGH SCHOOL
Client ID: SK#193

Parameter	Result	RL/ PQL	DIL	Units	AL	MCL	MCLG	Date/Time	By	Reference
Lead	0.0056	0.0005	2	mg/L	0.015			07/16/21	CPP	E200.8
Total Metal Digestion	Completed							07/14/21	AG	E200.8

RL/PQL=Minimum Reportable Level DW MCL=Maximum Potability Limit Sec Goal=Recommended Potability Limit NA=Not Applicable

Phyllis Shiller, Lab Director
July 20, 2021

For further interpretation or recommendations on treatment, please contact your local or state health department. Please see last page for additional information.



Environmental Laboratories, Inc.
587 East Middle Turnpike, P.O.Box 370, Manchester, CT 06045



Analysis Report

July 20, 2021

FOR: Attn: Mr. Bob Woodstead
Better Water Well Systems
348 Smith Ridge Rd
South Salem, NY 10590

Sample Information

Matrix: DRINKING WATER
Location Code: BWWS
Rush Request: Standard
P.O.#:

Custody Information

Collected by:
Received by: B
Analyzed by: see "By" below

Date

Time

07/13/21 5:55
07/13/21 15:33

Laboratory Data

SDG ID: GCI72882
Phoenix ID: CI72936

Project ID: KLSJ JOHN JAY HIGH SCHOOL
Client ID: F+N#194

Parameter	Result	RL/ PQL	DIL	Units	AL	MCL	MCLG	Date/Time	By	Reference
Lead	0.0029	0.0005	2	mg/L	0.015			07/16/21	CPP	E200.8
Total Metal Digestion	Completed							07/14/21	AG	E200.8

RL/PQL=Minimum Reportable Level DW MCL=Maximum Potability Limit Sec Goal=Recommended Potability Limit NA=Not Applicable

For further interpretation or recommendations on treatment, please contact your local or state health department. Please see last page for additional information.

Phyllis Shiller, Lab Director
July 20, 2021



Environmental Laboratories, Inc.
587 East Middle Turnpike, P.O.Box 370, Manchester, CT 06045



Analysis Report

July 20, 2021

FOR: Attn: Mr. Bob Woodstead
Better Water Well Systems
348 Smith Ridge Rd
South Salem, NY 10590

Sample Information

Matrix: DRINKING WATER
Location Code: BWWS
Rush Request: Standard
P.O.#:

Custody Information

Collected by:
Received by: B
Analyzed by: see "By" below

Date

Time

07/13/21 6:02
07/13/21 15:33

Laboratory Data

SDG ID: GCI72882
Phoenix ID: CI72937

Project ID: KLSD JOHN JAY HIGH SCHOOL
Client ID: SK#195

Parameter	Result	RL/ PQL	DIL	Units	AL	MCL	MCLG	Date/Time	By	Reference
Lead	0.0076	0.0005	2	mg/L	0.015			07/16/21	CPP	E200.8
Total Metal Digestion	Completed							07/14/21	AG	E200.8

RL/PQL=Minimum Reportable Level DW MCL=Maximum Potability Limit Sec Goal=Recommended Potability Limit NA=Not Applicable

Phyllis Shiller, Lab Director
July 20, 2021

For further interpretation or recommendations on treatment, please contact your local or state health department. Please see last page for additional information.



Environmental Laboratories, Inc.
587 East Middle Turnpike, P.O.Box 370, Manchester, CT 06045



Analysis Report

July 20, 2021

FOR: Attn: Mr. Bob Woodstead
Better Water Well Systems
348 Smith Ridge Rd
South Salem, NY 10590

Sample Information

Matrix: DRINKING WATER
Location Code: BWWS
Rush Request: Standard
P.O.#:

Custody Information

Collected by:
Received by: B
Analyzed by: see "By" below

Date

07/13/21
07/13/21

Time

6:03
15:33

Laboratory Data

SDG ID: GC172882
Phoenix ID: CI72938

Project ID: KLSD JOHN JAY HIGH SCHOOL
Client ID: SK#196

Parameter	Result	RL/ PQL	DIL	Units	AL	MCL	MCLG	Date/Time	By	Reference
Lead	0.0147	0.0005	2	mg/L	0.015			07/16/21	CPP	E200.8
Total Metal Digestion	Completed							07/14/21	AG	E200.8

RL/PQL=Minimum Reportable Level DW MCL=Maximum Potability Limit Sec Goal=Recommended Potability Limit NA=Not Applicable

For further interpretation or recommendations on treatment, please contact your local or state health department. Please see last page for additional information.

Phyllis Shiller, Lab Director
July 20, 2021



Environmental Laboratories, Inc.
587 East Middle Turnpike, P.O.Box 370, Manchester, CT 06045



Analysis Report

July 20, 2021

FOR: Attn: Mr. Bob Woodstead
Better Water Well Systems
348 Smith Ridge Rd
South Salem, NY 10590

Sample Information

Matrix: DRINKING WATER
Location Code: BWWS
Rush Request: Standard
P.O.#:

Custody Information

Collected by:
Received by: B
Analyzed by: see "By" below

Date

07/13/21
07/13/21

Time

6:04
15:33

Laboratory Data

SDG ID: GCI72882
Phoenix ID: CI72939

Project ID: KLSJ JOHN JAY HIGH SCHOOL
Client ID: SK#197

Parameter	Result	RL/ PQL	DIL	Units	AL	MCL	MCLG	Date/Time	By	Reference
Lead	0.0193	0.0005	2	mg/L	0.015			07/16/21	CPP	E200.8
*** Lead exceeds Action Level of 0.015 ***										
Total Metal Digestion	Completed							07/14/21	AG	E200.8

RL/PQL=Minimum Reportable Level DW MCL=Maximum Potability Limit Sec Goal=Recommended Potability Limit NA=Not Applicable

For further interpretation or recommendations on treatment, please contact your local or state health department. Please see last page for additional information.

Phyllis Shiller, Lab Director
July 20, 2021



Environmental Laboratories, Inc.
587 East Middle Turnpike, P.O.Box 370, Manchester, CT 06045



Analysis Report

July 20, 2021

FOR: Attn: Mr. Bob Woodstead
Better Water Well Systems
348 Smith Ridge Rd
South Salem, NY 10590

Sample Information

Matrix: DRINKING WATER
Location Code: BWWS
Rush Request: Standard
P.O.#:

Custody Information

Collected by:
Received by: B
Analyzed by: see "By" below

Date

07/13/21
07/13/21

Time

6:10
15:33

Laboratory Data

SDG ID: GCI72882
Phoenix ID: CI72940

Project ID: KLSJ JOHN JAY HIGH SCHOOL
Client ID: SK#198

Parameter	Result	RL/ PQL	DIL	Units	AL	MCL	MCLG	Date/Time	By	Reference
Lead	0.0154	0.0005	2	mg/L	0.015			07/16/21	CPP	E200.8
*** Lead exceeds Action Level of 0.015 ***										
Total Metal Digestion	Completed							07/14/21	AG	E200.8

RL/PQL=Minimum Reportable Level DW MCL=Maximum Potability Limit Sec Goal=Recommended Potability Limit NA=Not Applicable

For further interpretation or recommendations on treatment, please contact your local or state health department. Please see last page for additional information.

Phyllis Shiller, Lab Director
July 20, 2021



Environmental Laboratories, Inc.
587 East Middle Turnpike, P.O.Box 370, Manchester, CT 06045



Analysis Report

July 20, 2021

FOR: Attn: Mr. Bob Woodstead
Better Water Well Systems
348 Smith Ridge Rd
South Salem, NY 10590

Sample Information

Matrix: DRINKING WATER
Location Code: BWWS
Rush Request: Standard
P.O.#:

Custody Information

Collected by:
Received by: B
Analyzed by: see "By" below

Date

07/13/21
07/13/21

Time

6:11
15:33

Laboratory Data

SDG ID: GC172882
Phoenix ID: CI72941

Project ID: KLSD JOHN JAY HIGH SCHOOL
Client ID: SK#199

Parameter	Result	RL/ PQL	DIL	Units	AL	MCL	MCLG	Date/Time	By	Reference
Lead	0.0079	0.0005	2	mg/L	0.015			07/16/21	CPP	E200.8
Total Metal Digestion	Completed							07/14/21	AG	E200.8

RL/PQL=Minimum Reportable Level DW MCL=Maximum Potability Limit Sec Goal=Recommended Potability Limit NA=Not Applicable

Phyllis Shiller, Lab Director
July 20, 2021

For further interpretation or recommendations on treatment, please contact your local or state health department. Please see last page for additional information.



Environmental Laboratories, Inc.
587 East Middle Turnpike, P.O.Box 370, Manchester, CT 06045



Analysis Report

July 20, 2021

FOR: Attn: Mr. Bob Woodstead
Better Water Well Systems
348 Smith Ridge Rd
South Salem, NY 10590

Sample Information

Matrix: DRINKING WATER
Location Code: BWWS
Rush Request: Standard
P.O.#:

Custody Information

Collected by:
Received by: B
Analyzed by: see "By" below

Date

Time

07/13/21 6:13
07/13/21 15:33

Laboratory Data

SDG ID: GC172882
Phoenix ID: CI72942

Project ID: KLSD JOHN JAY HIGH SCHOOL
Client ID: F+N#200

Parameter	Result	RL/ PQL	DIL	Units	AL	MCL	MCLG	Date/Time	By	Reference
Lead	< 0.0005	0.0005	2	mg/L	0.015			07/16/21	CPP	E200.8
Total Metal Digestion	Completed							07/14/21	AG	E200.8

RL/PQL=Minimum Reportable Level DW MCL=Maximum Potability Limit Sec Goal=Recommended Potability Limit NA=Not Applicable

Phyllis Shiller, Lab Director
July 20, 2021

For further interpretation or recommendations on treatment, please contact your local or state health department. Please see last page for additional information.



Environmental Laboratories, Inc.
587 East Middle Turnpike, P.O.Box 370, Manchester, CT 06045



Analysis Report

July 20, 2021

FOR: Attn: Mr. Bob Woodstead
Better Water Well Systems
348 Smith Ridge Rd
South Salem, NY 10590

Sample Information

Matrix: DRINKING WATER
Location Code: BWWS
Rush Request: Standard
P.O.#:

Custody Information

Collected by:
Received by: B
Analyzed by: see "By" below

Date

07/13/21
07/13/21

Time

6:13
15:33

Laboratory Data

SDG ID: GC172882
Phoenix ID: CI72943

Project ID: KLSD JOHN JAY HIGH SCHOOL
Client ID: BF#200B

Parameter	Result	RL/ PQL	DIL	Units	AL	MCL	MCLG	Date/Time	By	Reference
Lead	< 0.0005	0.0005	2	mg/L	0.015			07/16/21	CPP	E200.8
Total Metal Digestion	Completed							07/14/21	AG	E200.8

RL/PQL=Minimum Reportable Level DW MCL=Maximum Potability Limit Sec Goal=Recommended Potability Limit NA=Not Applicable

Phyllis Shiller, Lab Director
July 20, 2021

For further interpretation or recommendations on treatment, please contact your local or state health department. Please see last page for additional information.



Environmental Laboratories, Inc.
587 East Middle Turnpike, P.O.Box 370, Manchester, CT 06045



Analysis Report

July 20, 2021

FOR: Attn: Mr. Bob Woodstead
Better Water Well Systems
348 Smith Ridge Rd
South Salem, NY 10590

Sample Information

Matrix: DRINKING WATER
Location Code: BWWS
Rush Request: Standard
P.O.#:

Custody Information

Collected by:
Received by: B
Analyzed by: see "By" below

Date

07/13/21
07/13/21

Time

6:15
15:33

Laboratory Data

SDG ID: GC172882
Phoenix ID: C172944

Project ID: KLSJ JOHN JAY HIGH SCHOOL
Client ID: SK#201

Parameter	Result	RL/ PQL	DIL	Units	AL	MCL	MCLG	Date/Time	By	Reference
Lead	0.0076	0.0005	2	mg/L	0.015			07/16/21	CPP	E200.8
Total Metal Digestion	Completed							07/14/21	AG	E200.8

RL/PQL=Minimum Reportable Level DW MCL=Maximum Potability Limit Sec Goal=Recommended Potability Limit NA=Not Applicable

For further interpretation or recommendations on treatment, please contact your local or state health department. Please see last page for additional information.

Phyllis Shiller, Lab Director
July 20, 2021



Environmental Laboratories, Inc.
587 East Middle Turnpike, P.O.Box 370, Manchester, CT 06045



Analysis Report

July 20, 2021

FOR: Attn: Mr. Bob Woodstead
Better Water Well Systems
348 Smith Ridge Rd
South Salem, NY 10590

Sample Information

Matrix: DRINKING WATER
Location Code: BWWS
Rush Request: Standard
P.O.#:

Custody Information

Collected by:
Received by: B
Analyzed by: see "By" below

Date

Time

07/13/21 6:16
07/13/21 15:33

Laboratory Data

SDG ID: GC172882
Phoenix ID: C172945

Project ID: KLSD JOHN JAY HIGH SCHOOL
Client ID: SK#202

Parameter	Result	RL/ PQL	DIL	Units	AL	MCL	MCLG	Date/Time	By	Reference
Lead	0.0067	0.0005	2	mg/L	0.015			07/16/21	CPP	E200.8
Total Metal Digestion	Completed							07/14/21	AG	E200.8

RL/PQL=Minimum Reportable Level DW MCL=Maximum Potability Limit Sec Goal=Recommended Potability Limit NA=Not Applicable

For further interpretation or recommendations on treatment, please contact your local or state health department. Please see last page for additional information.

Phyllis Shiller, Lab Director
July 20, 2021



Environmental Laboratories, Inc.
587 East Middle Turnpike, P.O.Box 370, Manchester, CT 06045



Analysis Report

July 20, 2021

FOR: Attn: Mr. Bob Woodstead
Better Water Well Systems
348 Smith Ridge Rd
South Salem, NY 10590

Sample Information

Matrix: DRINKING WATER
Location Code: BWWS
Rush Request: Standard
P.O.#:

Custody Information

Collected by:
Received by: B
Analyzed by: see "By" below

Date

07/13/21
07/13/21

Time

6:20
15:33

Laboratory Data

SDG ID: GC172882
Phoenix ID: C172946

Project ID: KLSJ JOHN JAY HIGH SCHOOL
Client ID: SK#203

Parameter	Result	RL/ PQL	DIL	Units	AL	MCL	MCLG	Date/Time	By	Reference
Lead	0.0227	0.0005	2	mg/L	0.015			07/16/21	CPP	E200.8
*** Lead exceeds Action Level of 0.015 ***										
Total Metal Digestion	Completed							07/14/21	AG	E200.8

RL/PQL=Minimum Reportable Level DW MCL=Maximum Potability Limit Sec Goal=Recommended Potability Limit NA=Not Applicable

For further interpretation or recommendations on treatment, please contact your local or state health department. Please see last page for additional information.

Phyllis Shiller, Lab Director
July 20, 2021



Environmental Laboratories, Inc.
587 East Middle Turnpike, P.O.Box 370, Manchester, CT 06045



Analysis Report

July 20, 2021

FOR: Attn: Mr. Bob Woodstead
Better Water Well Systems
348 Smith Ridge Rd
South Salem, NY 10590

Sample Information

Matrix: DRINKING WATER
Location Code: BWWS
Rush Request: Standard
P.O.#:

Custody Information

Collected by:
Received by: B
Analyzed by: see "By" below

Date

07/13/21
07/13/21

Time

6:21
15:33

Laboratory Data

SDG ID: GC172882
Phoenix ID: C172947

Project ID: KLSD JOHN JAY HIGH SCHOOL
Client ID: SK#205

Parameter	Result	RL/ PQL	DIL	Units	AL	MCL	MCLG	Date/Time	By	Reference
Lead	0.0142	0.0005	2	mg/L	0.015			07/16/21	CPP	E200.8
Total Metal Digestion	Completed							07/14/21	AG	E200.8

RL/PQL=Minimum Reportable Level DW MCL=Maximum Potability Limit Sec Goal=Recommended Potability Limit NA=Not Applicable

Phyllis Shiller, Lab Director
July 20, 2021

For further interpretation or recommendations on treatment, please contact your local or state health department. Please see last page for additional information.



Environmental Laboratories, Inc.
587 East Middle Turnpike, P.O.Box 370, Manchester, CT 06045



Analysis Report

July 20, 2021

FOR: Attn: Mr. Bob Woodstead
Better Water Well Systems
348 Smith Ridge Rd
South Salem, NY 10590

Sample Information

Matrix: DRINKING WATER
Location Code: BWWS
Rush Request: Standard
P.O.#:

Custody Information

Collected by:
Received by: B
Analyzed by: see "By" below

Date

07/13/21
07/13/21

Time

6:22
15:33

Laboratory Data

SDG ID: GC172882
Phoenix ID: CI72948

Project ID: KLSD JOHN JAY HIGH SCHOOL
Client ID: SK#206

Parameter	Result	RL/ PQL	DIL	Units	AL	MCL	MCLG	Date/Time	By	Reference
Lead	0.0308	0.0005	2	mg/L	0.015			07/16/21	CPP	E200.8
*** Lead exceeds Action Level of 0.015 ***										
Total Metal Digestion	Completed							07/14/21	AG	E200.8

RL/PQL=Minimum Reportable Level DW MCL=Maximum Potability Limit Sec Goal=Recommended Potability Limit NA=Not Applicable

For further interpretation or recommendations on treatment, please contact your local or state health department. Please see last page for additional information.

Phyllis Shiller, Lab Director
July 20, 2021



Environmental Laboratories, Inc.
587 East Middle Turnpike, P.O.Box 370, Manchester, CT 06045



Analysis Report

July 20, 2021

FOR: Attn: Mr. Bob Woodstead
Better Water Well Systems
348 Smith Ridge Rd
South Salem, NY 10590

Sample Information

Matrix: DRINKING WATER
Location Code: BWWS
Rush Request: Standard
P.O.#:

Custody Information

Collected by:
Received by: B
Analyzed by: see "By" below

Date

Time

07/13/21 6:23
07/13/21 15:33

Laboratory Data

SDG ID: GC172882
Phoenix ID: C172949

Project ID: KLSJ JOHN JAY HIGH SCHOOL
Client ID: SK#207

Parameter	Result	RL/ PQL	DIL	Units	AL	MCL	MCLG	Date/Time	By	Reference
Lead	0.0159	0.0005	2	mg/L	0.015			07/16/21	CPP	E200.8
*** Lead exceeds Action Level of 0.015 ***										
Total Metal Digestion	Completed							07/14/21	AG	E200.8

RL/PQL=Minimum Reportable Level DW MCL=Maximum Potability Limit Sec Goal=Recommended Potability Limit NA=Not Applicable

For further interpretation or recommendations on treatment, please contact your local or state health department. Please see last page for additional information.

Phyllis Shiller, Lab Director
July 20, 2021



Environmental Laboratories, Inc.
587 East Middle Turnpike, P.O.Box 370, Manchester, CT 06045



Analysis Report

July 20, 2021

FOR: Attn: Mr. Bob Woodstead
Better Water Well Systems
348 Smith Ridge Rd
South Salem, NY 10590

Sample Information

Matrix: DRINKING WATER
Location Code: BWWS
Rush Request: Standard
P.O.#:

Custody Information

Collected by:
Received by: B
Analyzed by: see "By" below

Date

07/13/21
07/13/21

Time

6:24
15:33

Laboratory Data

SDG ID: GC172882
Phoenix ID: C172950

Project ID: KLSJ JOHN JAY HIGH SCHOOL
Client ID: SK#208

Parameter	Result	RL/ PQL	DIL	Units	AL	MCL	MCLG	Date/Time	By	Reference
Lead	0.0096	0.0005	2	mg/L	0.015			07/16/21	CPP	E200.8
Total Metal Digestion	Completed							07/14/21	AG	E200.8

RL/PQL=Minimum Reportable Level DW MCL=Maximum Potability Limit Sec Goal=Recommended Potability Limit NA=Not Applicable

Phyllis Shiller, Lab Director
July 20, 2021

For further interpretation or recommendations on treatment, please contact your local or state health department. Please see last page for additional information.



Environmental Laboratories, Inc.
587 East Middle Turnpike, P.O.Box 370, Manchester, CT 06045



Analysis Report

July 20, 2021

FOR: Attn: Mr. Bob Woodstead
Better Water Well Systems
348 Smith Ridge Rd
South Salem, NY 10590

Sample Information

Matrix: DRINKING WATER
Location Code: BWWS
Rush Request: Standard
P.O.#:

Custody Information

Collected by:
Received by: B
Analyzed by: see "By" below

Date

07/13/21
07/13/21

Time

6:26
15:33

Laboratory Data

SDG ID: GCI72882
Phoenix ID: CI72951

Project ID: KLSJ JOHN JAY HIGH SCHOOL
Client ID: SK#209

Parameter	Result	RL/ PQL	DIL	Units	AL	MCL	MCLG	Date/Time	By	Reference
Lead	0.0074	0.0005	2	mg/L	0.015			07/16/21	CPP	E200.8
Total Metal Digestion	Completed							07/14/21	AG	E200.8

RL/PQL=Minimum Reportable Level DW MCL=Maximum Potability Limit Sec Goal=Recommended Potability Limit NA=Not Applicable

Phyllis Shiller, Lab Director
July 20, 2021

For further interpretation or recommendations on treatment, please contact your local or state health department. Please see last page for additional information.



Environmental Laboratories, Inc.
587 East Middle Turnpike, P.O.Box 370, Manchester, CT 06045



Analysis Report

July 20, 2021

FOR: Attn: Mr. Bob Woodstead
Better Water Well Systems
348 Smith Ridge Rd
South Salem, NY 10590

Sample Information

Matrix: DRINKING WATER
Location Code: BWWS
Rush Request: Standard
P.O.#:

Custody Information

Collected by:
Received by: B
Analyzed by: see "By" below

Date

Time

07/13/21 6:27
07/13/21 15:33

Laboratory Data

SDG ID: GCI72882
Phoenix ID: CI72952

Project ID: KLSD JOHN JAY HIGH SCHOOL
Client ID: SK#209A

Parameter	Result	RL/ PQL	DIL	Units	AL	MCL	MCLG	Date/Time	By	Reference
Lead	0.0105	0.0005	2	mg/L	0.015			07/17/21	CPP	E200.8
Total Metal Digestion	Completed							07/14/21	AG	E200.8

RL/PQL=Minimum Reportable Level DW MCL=Maximum Potability Limit Sec Goal=Recommended Potability Limit NA=Not Applicable

Phyllis Shiller, Lab Director
July 20, 2021

For further interpretation or recommendations on treatment, please contact your local or state health department. Please see last page for additional information.



Environmental Laboratories, Inc.
587 East Middle Turnpike, P.O.Box 370, Manchester, CT 06045



Analysis Report

July 20, 2021

FOR: Attn: Mr. Bob Woodstead
Better Water Well Systems
348 Smith Ridge Rd
South Salem, NY 10590

Sample Information

Matrix: DRINKING WATER
Location Code: BWWS
Rush Request: Standard
P.O.#:

Custody Information

Collected by:
Received by: B
Analyzed by: see "By" below

Date

07/13/21
07/13/21

Time

6:27
15:33

Laboratory Data

SDG ID: GC172882
Phoenix ID: C172953

Project ID: KLSJ JOHN JAY HIGH SCHOOL
Client ID: SK#210

Parameter	Result	RL/ PQL	DIL	Units	AL	MCL	MCLG	Date/Time	By	Reference
Lead	0.0083	0.0005	2	mg/L	0.015			07/17/21	CPP	E200.8
Total Metal Digestion	Completed							07/14/21	AG	E200.8

RL/PQL=Minimum Reportable Level DW MCL=Maximum Potability Limit Sec Goal=Recommended Potability Limit NA=Not Applicable

For further interpretation or recommendations on treatment, please contact your local or state health department. Please see last page for additional information.

Phyllis Shiller, Lab Director
July 20, 2021



Environmental Laboratories, Inc.
587 East Middle Turnpike, P.O.Box 370, Manchester, CT 06045



Analysis Report

July 20, 2021

FOR: Attn: Mr. Bob Woodstead
Better Water Well Systems
348 Smith Ridge Rd
South Salem, NY 10590

Sample Information

Matrix: DRINKING WATER
Location Code: BWWS
Rush Request: Standard
P.O.#:

Custody Information

Collected by:
Received by: B
Analyzed by: see "By" below

Date

Time

07/13/21 6:28
07/13/21 15:33

Laboratory Data

SDG ID: GC172882
Phoenix ID: CI72954

Project ID: KLSD JOHN JAY HIGH SCHOOL
Client ID: SK#211

Parameter	Result	RL/ PQL	DIL	Units	AL	MCL	MCLG	Date/Time	By	Reference
Lead	< 0.0005	0.0005	2	mg/L	0.015			07/17/21	CPP	E200.8
Total Metal Digestion	Completed							07/14/21	AG	E200.8

RL/PQL=Minimum Reportable Level DW MCL=Maximum Potability Limit Sec Goal=Recommended Potability Limit NA=Not Applicable

For further interpretation or recommendations on treatment, please contact your local or state health department. Please see last page for additional information.

Phyllis Shiller, Lab Director
July 20, 2021



Environmental Laboratories, Inc.
587 East Middle Turnpike, P.O.Box 370, Manchester, CT 06045



Analysis Report

July 20, 2021

FOR: Attn: Mr. Bob Woodstead
Better Water Well Systems
348 Smith Ridge Rd
South Salem, NY 10590

Sample Information

Matrix: DRINKING WATER
Location Code: BWWS
Rush Request: Standard
P.O.#:

Custody Information

Collected by:
Received by: B
Analyzed by: see "By" below

Date

07/13/21
07/13/21

Time

6:30
15:33

Laboratory Data

SDG ID: GC172882
Phoenix ID: C172955

Project ID: KLSD JOHN JAY HIGH SCHOOL
Client ID: SK#212

Parameter	Result	RL/ PQL	DIL	Units	AL	MCL	MCLG	Date/Time	By	Reference
Lead	0.0089	0.0005	2	mg/L	0.015			07/17/21	CPP	E200.8
Total Metal Digestion	Completed							07/14/21	AG	E200.8

RL/PQL=Minimum Reportable Level DW MCL=Maximum Potability Limit Sec Goal=Recommended Potability Limit NA=Not Applicable

Phyllis Shiller, Lab Director
July 20, 2021

For further interpretation or recommendations on treatment, please contact your local or state health department. Please see last page for additional information.



Environmental Laboratories, Inc.
587 East Middle Turnpike, P.O.Box 370, Manchester, CT 06045



Analysis Report

July 20, 2021

FOR: Attn: Mr. Bob Woodstead
Better Water Well Systems
348 Smith Ridge Rd
South Salem, NY 10590

Sample Information

Matrix: DRINKING WATER
Location Code: BWWS
Rush Request: Standard
P.O.#:

Custody Information

Collected by:
Received by: B
Analyzed by: see "By" below

Date

07/13/21
07/13/21

Time

6:34
15:33

Laboratory Data

SDG ID: GCI72882
Phoenix ID: CI72956

Project ID: KLSD JOHN JAY HIGH SCHOOL
Client ID: SK#215

Parameter	Result	RL/ PQL	DIL	Units	AL	MCL	MCLG	Date/Time	By	Reference
Lead	0.0153	0.0005	2	mg/L	0.015			07/17/21	CPP	E200.8
*** Lead exceeds Action Level of 0.015 ***										
Total Metal Digestion	Completed							07/14/21	AG	E200.8

RL/PQL=Minimum Reportable Level DW MCL=Maximum Potability Limit Sec Goal=Recommended Potability Limit NA=Not Applicable

For further interpretation or recommendations on treatment, please contact your local or state health department. Please see last page for additional information.

Phyllis Shiller, Lab Director
July 20, 2021



Environmental Laboratories, Inc.
587 East Middle Turnpike, P.O.Box 370, Manchester, CT 06045



Analysis Report

July 20, 2021

FOR: Attn: Mr. Bob Woodstead
Better Water Well Systems
348 Smith Ridge Rd
South Salem, NY 10590

Sample Information

Matrix: DRINKING WATER
Location Code: BWWS
Rush Request: Standard
P.O.#:

Custody Information

Collected by:
Received by: B
Analyzed by: see "By" below

Date

Time

07/13/21 6:35
07/13/21 15:33

Laboratory Data

SDG ID: GCI72882
Phoenix ID: CI72957

Project ID: KLSD JOHN JAY HIGH SCHOOL
Client ID: SK#216

Parameter	Result	RL/ PQL	DIL	Units	AL	MCL	MCLG	Date/Time	By	Reference
Lead	0.0105	0.0005	2	mg/L	0.015			07/17/21	CPP	E200.8
Total Metal Digestion	Completed							07/14/21	AG	E200.8

RL/PQL=Minimum Reportable Level DW MCL=Maximum Potability Limit Sec Goal=Recommended Potability Limit NA=Not Applicable

Phyllis Shiller, Lab Director
July 20, 2021

For further interpretation or recommendations on treatment, please contact your local or state health department. Please see last page for additional information.



Environmental Laboratories, Inc.
587 East Middle Turnpike, P.O.Box 370, Manchester, CT 06045



Analysis Report

July 20, 2021

FOR: Attn: Mr. Bob Woodstead
Better Water Well Systems
348 Smith Ridge Rd
South Salem, NY 10590

Sample Information

Matrix: DRINKING WATER
Location Code: BWWS
Rush Request: Standard
P.O.#:

Custody Information

Collected by:
Received by: B
Analyzed by: see "By" below

Date

07/13/21
07/13/21

Time

6:36
15:33

Laboratory Data

SDG ID: GC172882
Phoenix ID: C172958

Project ID: KLSD JOHN JAY HIGH SCHOOL
Client ID: SK#217

Parameter	Result	RL/ PQL	DIL	Units	AL	MCL	MCLG	Date/Time	By	Reference
Lead	0.0102	0.0005	2	mg/L	0.015			07/17/21	CPP	E200.8
Total Metal Digestion	Completed							07/14/21	AG	E200.8

RL/PQL=Minimum Reportable Level DW MCL=Maximum Potability Limit Sec Goal=Recommended Potability Limit NA=Not Applicable

For further interpretation or recommendations on treatment, please contact your local or state health department. Please see last page for additional information.

Phyllis Shiller, Lab Director
July 20, 2021



Environmental Laboratories, Inc.
587 East Middle Turnpike, P.O.Box 370, Manchester, CT 06045



Analysis Report

July 20, 2021

FOR: Attn: Mr. Bob Woodstead
Better Water Well Systems
348 Smith Ridge Rd
South Salem, NY 10590

Sample Information

Matrix: DRINKING WATER
Location Code: BWWS
Rush Request: Standard
P.O.#:

Custody Information

Collected by:
Received by: B
Analyzed by: see "By" below

Date

07/13/21
07/13/21

Time

6:37
15:33

Laboratory Data

SDG ID: GC172882
Phoenix ID: C172959

Project ID: KLSD JOHN JAY HIGH SCHOOL
Client ID: SK#218

Parameter	Result	RL/ PQL	DIL	Units	AL	MCL	MCLG	Date/Time	By	Reference
Lead	0.0247	0.0005	2	mg/L	0.015			07/17/21	CPP	E200.8
*** Lead exceeds Action Level of 0.015 ***										
Total Metal Digestion	Completed							07/14/21	AG	E200.8

RL/PQL=Minimum Reportable Level DW MCL=Maximum Potability Limit Sec Goal=Recommended Potability Limit NA=Not Applicable

For further interpretation or recommendations on treatment, please contact your local or state health department. Please see last page for additional information.

Phyllis Shiller, Lab Director
July 20, 2021



Environmental Laboratories, Inc.
587 East Middle Turnpike, P.O.Box 370, Manchester, CT 06045



Analysis Report

July 20, 2021

FOR: Attn: Mr. Bob Woodstead
Better Water Well Systems
348 Smith Ridge Rd
South Salem, NY 10590

Sample Information

Matrix: DRINKING WATER
Location Code: BWWS
Rush Request: Standard
P.O.#:

Custody Information

Collected by:
Received by: B
Analyzed by: see "By" below

Date

07/13/21
07/13/21

Time

6:38
15:33

Laboratory Data

SDG ID: GC172882
Phoenix ID: C172960

Project ID: KLSD JOHN JAY HIGH SCHOOL
Client ID: SK#219

Parameter	Result	RL/ PQL	DIL	Units	AL	MCL	MCLG	Date/Time	By	Reference
Lead	0.0093	0.0005	2	mg/L	0.015			07/17/21	CPP	E200.8
Total Metal Digestion	Completed							07/14/21	AG	E200.8

RL/PQL=Minimum Reportable Level DW MCL=Maximum Potability Limit Sec Goal=Recommended Potability Limit NA=Not Applicable

Phyllis Shiller, Lab Director
July 20, 2021

For further interpretation or recommendations on treatment, please contact your local or state health department. Please see last page for additional information.



Environmental Laboratories, Inc.
587 East Middle Turnpike, P.O.Box 370, Manchester, CT 06045



Analysis Report

July 20, 2021

FOR: Attn: Mr. Bob Woodstead
Better Water Well Systems
348 Smith Ridge Rd
South Salem, NY 10590

Sample Information

Matrix: DRINKING WATER
Location Code: BWWS
Rush Request: Standard
P.O.#:

Custody Information

Collected by:
Received by: B
Analyzed by: see "By" below

Date

07/13/21
07/13/21

Time

6:39
15:33

Laboratory Data

SDG ID: GC172882
Phoenix ID: C172961

Project ID: KLSD JOHN JAY HIGH SCHOOL
Client ID: SK#220

Parameter	Result	RL/ PQL	DIL	Units	AL	MCL	MCLG	Date/Time	By	Reference
Lead	0.0151	0.0005	2	mg/L	0.015			07/17/21	CPP	E200.8
*** Lead exceeds Action Level of 0.015 ***										
Total Metal Digestion	Completed							07/14/21	AG	E200.8

RL/PQL=Minimum Reportable Level DW MCL=Maximum Potability Limit Sec Goal=Recommended Potability Limit NA=Not Applicable

Phyllis Shiller, Lab Director
July 20, 2021

For further interpretation or recommendations on treatment, please contact your local or state health department. Please see last page for additional information.



Environmental Laboratories, Inc.
587 East Middle Turnpike, P.O.Box 370, Manchester, CT 06045



Analysis Report

July 20, 2021

FOR: Attn: Mr. Bob Woodstead
Better Water Well Systems
348 Smith Ridge Rd
South Salem, NY 10590

Sample Information

Matrix: DRINKING WATER
Location Code: BWWS
Rush Request: Standard
P.O.#:

Custody Information

Collected by:
Received by: B
Analyzed by: see "By" below

Date

07/13/21
07/13/21

Time

6:41
15:33

Laboratory Data

SDG ID: GC172882
Phoenix ID: C172962

Project ID: KLSJ JOHN JAY HIGH SCHOOL
Client ID: SK#221

Parameter	Result	RL/ PQL	DIL	Units	AL	MCL	MCLG	Date/Time	By	Reference
Lead	0.0129	0.0005	2	mg/L	0.015			07/17/21	CPP	E200.8
Total Metal Digestion	Completed							07/14/21	AG	E200.8

RL/PQL=Minimum Reportable Level DW MCL=Maximum Potability Limit Sec Goal=Recommended Potability Limit NA=Not Applicable

Phyllis Shiller, Lab Director
July 20, 2021

For further interpretation or recommendations on treatment, please contact your local or state health department. Please see last page for additional information.



Environmental Laboratories, Inc.
587 East Middle Turnpike, P.O.Box 370, Manchester, CT 06045



Analysis Report

July 20, 2021

FOR: Attn: Mr. Bob Woodstead
Better Water Well Systems
348 Smith Ridge Rd
South Salem, NY 10590

Sample Information

Matrix: DRINKING WATER
Location Code: BWWS
Rush Request: Standard
P.O.#:

Custody Information

Collected by:
Received by: B
Analyzed by: see "By" below

Date

07/13/21
07/13/21

Time

6:42
15:33

Laboratory Data

SDG ID: GC172882
Phoenix ID: C172963

Project ID: KLSD JOHN JAY HIGH SCHOOL
Client ID: SK#222

Parameter	Result	RL/ PQL	DIL	Units	AL	MCL	MCLG	Date/Time	By	Reference
Lead	0.0061	0.0005	2	mg/L	0.015			07/17/21	CPP	E200.8
Total Metal Digestion	Completed							07/14/21	AG	E200.8

RL/PQL=Minimum Reportable Level DW MCL=Maximum Potability Limit Sec Goal=Recommended Potability Limit NA=Not Applicable

Phyllis Shiller, Lab Director
July 20, 2021

For further interpretation or recommendations on treatment, please contact your local or state health department. Please see last page for additional information.



Environmental Laboratories, Inc.
587 East Middle Turnpike, P.O.Box 370, Manchester, CT 06045



Analysis Report

July 20, 2021

FOR: Attn: Mr. Bob Woodstead
Better Water Well Systems
348 Smith Ridge Rd
South Salem, NY 10590

Sample Information

Matrix: DRINKING WATER
Location Code: BWWS
Rush Request: Standard
P.O.#:

Custody Information

Collected by:
Received by: B
Analyzed by: see "By" below

Date

07/13/21
07/13/21

Time

6:43
15:33

Laboratory Data

SDG ID: GC172882
Phoenix ID: C172964

Project ID: KLSD JOHN JAY HIGH SCHOOL
Client ID: SK#223

Parameter	Result	RL/ PQL	DIL	Units	AL	MCL	MCLG	Date/Time	By	Reference
Lead	0.0101	0.0005	2	mg/L	0.015			07/17/21	CPP	E200.8
Total Metal Digestion	Completed							07/14/21	AG	E200.8

RL/PQL=Minimum Reportable Level DW MCL=Maximum Potability Limit Sec Goal=Recommended Potability Limit NA=Not Applicable

Phyllis Shiller, Lab Director
July 20, 2021

For further interpretation or recommendations on treatment, please contact your local or state health department. Please see last page for additional information.



Environmental Laboratories, Inc.
587 East Middle Turnpike, P.O.Box 370, Manchester, CT 06045



Analysis Report

July 20, 2021

FOR: Attn: Mr. Bob Woodstead
Better Water Well Systems
348 Smith Ridge Rd
South Salem, NY 10590

Sample Information

Matrix: DRINKING WATER
Location Code: BWWS
Rush Request: Standard
P.O.#:

Custody Information

Collected by:
Received by: B
Analyzed by: see "By" below

Date

07/13/21
07/13/21

Time

6:45
15:33

Laboratory Data

SDG ID: GC172882
Phoenix ID: C172965

Project ID: KLSD JOHN JAY HIGH SCHOOL
Client ID: SK#224

Parameter	Result	RL/ PQL	DIL	Units	AL	MCL	MCLG	Date/Time	By	Reference
Lead	0.0163	0.0005	2	mg/L	0.015			07/17/21	CPP	E200.8
*** Lead exceeds Action Level of 0.015 ***										
Total Metal Digestion	Completed							07/14/21	AG	E200.8

RL/PQL=Minimum Reportable Level DW MCL=Maximum Potability Limit Sec Goal=Recommended Potability Limit NA=Not Applicable

For further interpretation or recommendations on treatment, please contact your local or state health department. Please see last page for additional information.

Phyllis Shiller, Lab Director
July 20, 2021



Environmental Laboratories, Inc.
587 East Middle Turnpike, P.O.Box 370, Manchester, CT 06045



Analysis Report

July 20, 2021

FOR: Attn: Mr. Bob Woodstead
Better Water Well Systems
348 Smith Ridge Rd
South Salem, NY 10590

Sample Information

Matrix: DRINKING WATER
Location Code: BWWS
Rush Request: Standard
P.O.#:

Custody Information

Collected by:
Received by: B
Analyzed by: see "By" below

Date

07/13/21
07/13/21

Time

6:46
15:33

Laboratory Data

SDG ID: GC172882
Phoenix ID: C172966

Project ID: KLSD JOHN JAY HIGH SCHOOL
Client ID: SK#225

Parameter	Result	RL/ PQL	DIL	Units	AL	MCL	MCLG	Date/Time	By	Reference
Lead	0.0077	0.0005	2	mg/L	0.015			07/17/21	CPP	E200.8
Total Metal Digestion	Completed							07/14/21	AG	E200.8

RL/PQL=Minimum Reportable Level DW MCL=Maximum Potability Limit Sec Goal=Recommended Potability Limit NA=Not Applicable

For further interpretation or recommendations on treatment, please contact your local or state health department. Please see last page for additional information.

Phyllis Shiller, Lab Director
July 20, 2021



Environmental Laboratories, Inc.
587 East Middle Turnpike, P.O.Box 370, Manchester, CT 06045



Analysis Report

July 20, 2021

FOR: Attn: Mr. Bob Woodstead
Better Water Well Systems
348 Smith Ridge Rd
South Salem, NY 10590

Sample Information

Matrix: DRINKING WATER
Location Code: BWWS
Rush Request: Standard
P.O.#:

Custody Information

Collected by:
Received by: B
Analyzed by: see "By" below

Date

Time

07/13/21 6:46
07/13/21 15:33

Laboratory Data

SDG ID: GC172882
Phoenix ID: CI72967

Project ID: KLSD JOHN JAY HIGH SCHOOL
Client ID: SK#226

Parameter	Result	RL/ PQL	DIL	Units	AL	MCL	MCLG	Date/Time	By	Reference
Lead	0.0051	0.0005	2	mg/L	0.015			07/17/21	CPP	E200.8
Total Metal Digestion	Completed							07/14/21	AG	E200.8

RL/PQL=Minimum Reportable Level DW MCL=Maximum Potability Limit Sec Goal=Recommended Potability Limit NA=Not Applicable

Phyllis Shiller, Lab Director
July 20, 2021

For further interpretation or recommendations on treatment, please contact your local or state health department. Please see last page for additional information.



Environmental Laboratories, Inc.
587 East Middle Turnpike, P.O.Box 370, Manchester, CT 06045



Analysis Report

July 20, 2021

FOR: Attn: Mr. Bob Woodstead
Better Water Well Systems
348 Smith Ridge Rd
South Salem, NY 10590

Sample Information

Matrix: DRINKING WATER
Location Code: BWWS
Rush Request: Standard
P.O.#:

Custody Information

Collected by:
Received by: B
Analyzed by: see "By" below

Date

07/13/21
07/13/21

Time

6:47
15:33

Laboratory Data

SDG ID: GC172882
Phoenix ID: C172968

Project ID: KLSJ JOHN JAY HIGH SCHOOL
Client ID: SK#227

Parameter	Result	RL/ PQL	DIL	Units	AL	MCL	MCLG	Date/Time	By	Reference
Lead	0.0086	0.0005	2	mg/L	0.015			07/17/21	CPP	E200.8
Total Metal Digestion	Completed							07/14/21	AG	E200.8

RL/PQL=Minimum Reportable Level DW MCL=Maximum Potability Limit Sec Goal=Recommended Potability Limit NA=Not Applicable

Phyllis Shiller, Lab Director
July 20, 2021

For further interpretation or recommendations on treatment, please contact your local or state health department. Please see last page for additional information.



Environmental Laboratories, Inc.
587 East Middle Turnpike, P.O.Box 370, Manchester, CT 06045



Analysis Report

July 20, 2021

FOR: Attn: Mr. Bob Woodstead
Better Water Well Systems
348 Smith Ridge Rd
South Salem, NY 10590

Sample Information

Matrix: DRINKING WATER
Location Code: BWWS
Rush Request: Standard
P.O.#:

Custody Information

Collected by:
Received by: B
Analyzed by: see "By" below

Date

07/13/21
07/13/21

Time

6:48
15:33

Laboratory Data

SDG ID: GC172882
Phoenix ID: C172969

Project ID: KLSD JOHN JAY HIGH SCHOOL
Client ID: SK#228

Parameter	Result	RL/ PQL	DIL	Units	AL	MCL	MCLG	Date/Time	By	Reference
Lead	0.0316	0.0005	2	mg/L	0.015			07/17/21	CPP	E200.8
*** Lead exceeds Action Level of 0.015 ***										
Total Metal Digestion	Completed							07/14/21	AG	E200.8

RL/PQL=Minimum Reportable Level DW MCL=Maximum Potability Limit Sec Goal=Recommended Potability Limit NA=Not Applicable

For further interpretation or recommendations on treatment, please contact your local or state health department. Please see last page for additional information.

Phyllis Shiller, Lab Director
July 20, 2021



Environmental Laboratories, Inc.
587 East Middle Turnpike, P.O.Box 370, Manchester, CT 06045



Analysis Report

July 20, 2021

FOR: Attn: Mr. Bob Woodstead
Better Water Well Systems
348 Smith Ridge Rd
South Salem, NY 10590

Sample Information

Matrix: DRINKING WATER
Location Code: BWWS
Rush Request: Standard
P.O.#:

Custody Information

Collected by:
Received by: B
Analyzed by: see "By" below

Date

07/13/21
07/13/21

Time

6:48
15:33

Laboratory Data

SDG ID: GCI72882
Phoenix ID: CI72970

Project ID: KLSJ JOHN JAY HIGH SCHOOL
Client ID: SK#229

Parameter	Result	RL/ PQL	DIL	Units	AL	MCL	MCLG	Date/Time	By	Reference
Lead	0.0289	0.0005	2	mg/L	0.015			07/17/21	CPP	E200.8
*** Lead exceeds Action Level of 0.015 ***										
Total Metal Digestion	Completed							07/14/21	AG	E200.8

RL/PQL=Minimum Reportable Level DW MCL=Maximum Potability Limit Sec Goal=Recommended Potability Limit NA=Not Applicable

For further interpretation or recommendations on treatment, please contact your local or state health department. Please see last page for additional information.

Phyllis Shiller, Lab Director
July 20, 2021



Environmental Laboratories, Inc.
587 East Middle Turnpike, P.O.Box 370, Manchester, CT 06045



Analysis Report

July 20, 2021

FOR: Attn: Mr. Bob Woodstead
Better Water Well Systems
348 Smith Ridge Rd
South Salem, NY 10590

Sample Information

Matrix: DRINKING WATER
Location Code: BWWS
Rush Request: Standard
P.O.#:

Custody Information

Collected by:
Received by: B
Analyzed by: see "By" below

Date

07/13/21
07/13/21

Time

6:49
15:33

Laboratory Data

SDG ID: GC172882
Phoenix ID: CI72971

Project ID: KLSD JOHN JAY HIGH SCHOOL
Client ID: SK#230

Parameter	Result	RL/ PQL	DIL	Units	AL	MCL	MCLG	Date/Time	By	Reference
Lead	0.0253	0.0005	2	mg/L	0.015			07/17/21	CPP	E200.8
*** Lead exceeds Action Level of 0.015 ***										
Total Metal Digestion	Completed							07/14/21	AG	E200.8

RL/PQL=Minimum Reportable Level DW MCL=Maximum Potability Limit Sec Goal=Recommended Potability Limit NA=Not Applicable

For further interpretation or recommendations on treatment, please contact your local or state health department. Please see last page for additional information.

Phyllis Shiller, Lab Director
July 20, 2021



Environmental Laboratories, Inc.
587 East Middle Turnpike, P.O.Box 370, Manchester, CT 06045



Analysis Report

July 20, 2021

FOR: Attn: Mr. Bob Woodstead
Better Water Well Systems
348 Smith Ridge Rd
South Salem, NY 10590

Sample Information

Matrix: DRINKING WATER
Location Code: BWWS
Rush Request: Standard
P.O.#:

Custody Information

Collected by:
Received by: B
Analyzed by: see "By" below

Date

07/13/21
07/13/21

Time

6:50
15:33

Laboratory Data

SDG ID: GC172882
Phoenix ID: C172972

Project ID: KLSD JOHN JAY HIGH SCHOOL
Client ID: SK#231

Parameter	Result	RL/ PQL	DIL	Units	AL	MCL	MCLG	Date/Time	By	Reference
Lead	0.0132	0.0005	2	mg/L	0.015			07/15/21	MGH	E200.8
Total Metal Digestion	Completed							07/14/21		E200.8

RL/PQL=Minimum Reportable Level DW MCL=Maximum Potability Limit Sec Goal=Recommended Potability Limit NA=Not Applicable

For further interpretation or recommendations on treatment, please contact your local or state health department. Please see last page for additional information.

Phyllis Shiller, Lab Director
July 20, 2021



Environmental Laboratories, Inc.
587 East Middle Turnpike, P.O.Box 370, Manchester, CT 06045



Analysis Report

July 20, 2021

FOR: Attn: Mr. Bob Woodstead
Better Water Well Systems
348 Smith Ridge Rd
South Salem, NY 10590

Sample Information

Matrix: DRINKING WATER
Location Code: BWWS
Rush Request: Standard
P.O.#:

Custody Information

Collected by:
Received by: B
Analyzed by: see "By" below

Date

Time

07/13/21 6:52
07/13/21 15:33

Laboratory Data

SDG ID: GCI72882
Phoenix ID: CI72973

Project ID: KLSJ JOHN JAY HIGH SCHOOL
Client ID: SK#232

Parameter	Result	RL/ PQL	DIL	Units	AL	MCL	MCLG	Date/Time	By	Reference
Lead	< 0.0005	0.0005	2	mg/L	0.015			07/19/21	CPP	E200.8
Total Metal Digestion	Completed							07/14/21		E200.8

RL/PQL=Minimum Reportable Level DW MCL=Maximum Potability Limit Sec Goal=Recommended Potability Limit NA=Not Applicable

For further interpretation or recommendations on treatment, please contact your local or state health department. Please see last page for additional information.

Phyllis Shiller, Lab Director
July 20, 2021



Environmental Laboratories, Inc.
587 East Middle Turnpike, P.O.Box 370, Manchester, CT 06045



Analysis Report

July 20, 2021

FOR: Attn: Mr. Bob Woodstead
Better Water Well Systems
348 Smith Ridge Rd
South Salem, NY 10590

Sample Information

Matrix: DRINKING WATER
Location Code: BWWS
Rush Request: Standard
P.O.#:

Custody Information

Collected by:
Received by: B
Analyzed by: see "By" below

Date

Time

07/13/21 6:53
07/13/21 15:33

Laboratory Data

SDG ID: GCI72882
Phoenix ID: CI72974

Project ID: KLSD JOHN JAY HIGH SCHOOL
Client ID: SK#233

Parameter	Result	RL/ PQL	DIL	Units	AL	MCL	MCLG	Date/Time	By	Reference
Lead	0.0051	0.0005	2	mg/L	0.015			07/19/21	CPP	E200.8
Total Metal Digestion	Completed							07/14/21		E200.8

RL/PQL=Minimum Reportable Level DW MCL=Maximum Potability Limit Sec Goal=Recommended Potability Limit NA=Not Applicable

For further interpretation or recommendations on treatment, please contact your local or state health department. Please see last page for additional information.

Phyllis Shiller, Lab Director
July 20, 2021



Environmental Laboratories, Inc.
587 East Middle Turnpike, P.O.Box 370, Manchester, CT 06045



Analysis Report

July 20, 2021

FOR: Attn: Mr. Bob Woodstead
Better Water Well Systems
348 Smith Ridge Rd
South Salem, NY 10590

Sample Information

Matrix: DRINKING WATER
Location Code: BWWS
Rush Request: Standard
P.O.#:

Custody Information

Collected by:
Received by: B
Analyzed by: see "By" below

Date

Time

07/13/21 6:54
07/13/21 15:33

Laboratory Data

SDG ID: GCI72882
Phoenix ID: CI72975

Project ID: KLSJ JOHN JAY HIGH SCHOOL
Client ID: SK#235

Parameter	Result	RL/ PQL	DIL	Units	AL	MCL	MCLG	Date/Time	By	Reference
Lead	0.0072	0.0005	2	mg/L	0.015			07/19/21	CPP	E200.8
Total Metal Digestion	Completed							07/14/21		E200.8

RL/PQL=Minimum Reportable Level DW MCL=Maximum Potability Limit Sec Goal=Recommended Potability Limit NA=Not Applicable

Phyllis Shiller, Lab Director
July 20, 2021

For further interpretation or recommendations on treatment, please contact your local or state health department. Please see last page for additional information.



Environmental Laboratories, Inc.
587 East Middle Turnpike, P.O.Box 370, Manchester, CT 06045



Analysis Report

July 20, 2021

FOR: Attn: Mr. Bob Woodstead
Better Water Well Systems
348 Smith Ridge Rd
South Salem, NY 10590

Sample Information

Matrix: DRINKING WATER
Location Code: BWWS
Rush Request: Standard
P.O.#:

Custody Information

Collected by:
Received by: B
Analyzed by: see "By" below

Date

07/13/21
07/13/21

Time

6:55
15:33

Laboratory Data

SDG ID: GC172882
Phoenix ID: CI72976

Project ID: KLSJ JOHN JAY HIGH SCHOOL
Client ID: SK#236

Parameter	Result	RL/ PQL	DIL	Units	AL	MCL	MCLG	Date/Time	By	Reference
Lead	0.0021	0.0005	2	mg/L	0.015			07/19/21	CPP	E200.8
Total Metal Digestion	Completed							07/14/21		E200.8

RL/PQL=Minimum Reportable Level DW MCL=Maximum Potability Limit Sec Goal=Recommended Potability Limit NA=Not Applicable

Phyllis Shiller, Lab Director
July 20, 2021

For further interpretation or recommendations on treatment, please contact your local or state health department. Please see last page for additional information.



Environmental Laboratories, Inc.
587 East Middle Turnpike, P.O.Box 370, Manchester, CT 06045



Analysis Report

July 20, 2021

FOR: Attn: Mr. Bob Woodstead
Better Water Well Systems
348 Smith Ridge Rd
South Salem, NY 10590

Sample Information

Matrix: DRINKING WATER
Location Code: BWWS
Rush Request: Standard
P.O.#:

Custody Information

Collected by:
Received by: B
Analyzed by: see "By" below

Date

07/13/21
07/13/21

Time

6:58
15:33

Laboratory Data

SDG ID: GCI72882
Phoenix ID: CI72977

Project ID: KLSD JOHN JAY HIGH SCHOOL
Client ID: SK#237

Parameter	Result	RL/ PQL	DIL	Units	AL	MCL	MCLG	Date/Time	By	Reference
Lead	0.0133	0.0005	2	mg/L	0.015			07/19/21	CPP	E200.8
Total Metal Digestion	Completed							07/14/21		E200.8

RL/PQL=Minimum Reportable Level DW MCL=Maximum Potability Limit Sec Goal=Recommended Potability Limit NA=Not Applicable

For further interpretation or recommendations on treatment, please contact your local or state health department. Please see last page for additional information.

Phyllis Shiller, Lab Director
July 20, 2021



Environmental Laboratories, Inc.
587 East Middle Turnpike, P.O.Box 370, Manchester, CT 06045



Analysis Report

July 20, 2021

FOR: Attn: Mr. Bob Woodstead
Better Water Well Systems
348 Smith Ridge Rd
South Salem, NY 10590

Sample Information

Matrix: DRINKING WATER
Location Code: BWWS
Rush Request: Standard
P.O.#:

Custody Information

Collected by:
Received by: B
Analyzed by: see "By" below

Date

07/13/21
07/13/21

Time

7:00
15:33

Laboratory Data

SDG ID: GC172882
Phoenix ID: CI72978

Project ID: KLSJ JOHN JAY HIGH SCHOOL
Client ID: SK#238

Parameter	Result	RL/ PQL	DIL	Units	AL	MCL	MCLG	Date/Time	By	Reference
Lead	0.0038	0.0005	2	mg/L	0.015			07/19/21	CPP	E200.8
Total Metal Digestion	Completed							07/14/21		E200.8

RL/PQL=Minimum Reportable Level DW MCL=Maximum Potability Limit Sec Goal=Recommended Potability Limit NA=Not Applicable

Phyllis Shiller, Lab Director
July 20, 2021

For further interpretation or recommendations on treatment, please contact your local or state health department. Please see last page for additional information.



Environmental Laboratories, Inc.
587 East Middle Turnpike, P.O.Box 370, Manchester, CT 06045



Analysis Report

July 20, 2021

FOR: Attn: Mr. Bob Woodstead
Better Water Well Systems
348 Smith Ridge Rd
South Salem, NY 10590

Sample Information

Matrix: DRINKING WATER
Location Code: BWWS
Rush Request: Standard
P.O.#:

Custody Information

Collected by:
Received by: B
Analyzed by: see "By" below

Date

Time

07/13/21 7:00
07/13/21 15:33

Laboratory Data

SDG ID: GC172882
Phoenix ID: C172979

Project ID: KLSD JOHN JAY HIGH SCHOOL
Client ID: SK#239

Parameter	Result	RL/ PQL	DIL	Units	AL	MCL	MCLG	Date/Time	By	Reference
Lead	0.0038	0.0005	2	mg/L	0.015			07/19/21	CPP	E200.8
Total Metal Digestion	Completed							07/14/21		E200.8

RL/PQL=Minimum Reportable Level DW MCL=Maximum Potability Limit Sec Goal=Recommended Potability Limit NA=Not Applicable

Phyllis Shiller, Lab Director
July 20, 2021

For further interpretation or recommendations on treatment, please contact your local or state health department. Please see last page for additional information.



Environmental Laboratories, Inc.
587 East Middle Turnpike, P.O.Box 370, Manchester, CT 06045



Analysis Report

July 20, 2021

FOR: Attn: Mr. Bob Woodstead
Better Water Well Systems
348 Smith Ridge Rd
South Salem, NY 10590

Sample Information

Matrix: DRINKING WATER
Location Code: BWWS
Rush Request: Standard
P.O.#:

Custody Information

Collected by:
Received by: B
Analyzed by: see "By" below

Date

07/13/21
07/13/21

Time

7:01
15:33

Laboratory Data

SDG ID: GC172882
Phoenix ID: CI72980

Project ID: KLSJ JOHN JAY HIGH SCHOOL
Client ID: SK#240

Parameter	Result	RL/ PQL	DIL	Units	AL	MCL	MCLG	Date/Time	By	Reference
Lead	0.0187	0.0005	2	mg/L	0.015			07/19/21	CPP	E200.8
*** Lead exceeds Action Level of 0.015 ***										
Total Metal Digestion	Completed							07/14/21		E200.8

RL/PQL=Minimum Reportable Level DW MCL=Maximum Potability Limit Sec Goal=Recommended Potability Limit NA=Not Applicable

For further interpretation or recommendations on treatment, please contact your local or state health department. Please see last page for additional information.

Phyllis Shiller, Lab Director
July 20, 2021



Environmental Laboratories, Inc.
587 East Middle Turnpike, P.O.Box 370, Manchester, CT 06045



Analysis Report

July 20, 2021

FOR: Attn: Mr. Bob Woodstead
Better Water Well Systems
348 Smith Ridge Rd
South Salem, NY 10590

Sample Information

Matrix: DRINKING WATER
Location Code: BWWS
Rush Request: Standard
P.O.#:

Custody Information

Collected by:
Received by: B
Analyzed by: see "By" below

Date

Time

07/13/21 7:03
07/13/21 15:33

Laboratory Data

SDG ID: GC172882
Phoenix ID: C172981

Project ID: KLSD JOHN JAY HIGH SCHOOL
Client ID: SK#241

Parameter	Result	RL/ PQL	DIL	Units	AL	MCL	MCLG	Date/Time	By	Reference
Lead	0.0036	0.0005	2	mg/L	0.015			07/19/21	CPP	E200.8
Total Metal Digestion	Completed							07/14/21		E200.8

RL/PQL=Minimum Reportable Level DW MCL=Maximum Potability Limit Sec Goal=Recommended Potability Limit NA=Not Applicable

Phyllis Shiller, Lab Director
July 20, 2021

For further interpretation or recommendations on treatment, please contact your local or state health department. Please see last page for additional information.



Environmental Laboratories, Inc.
587 East Middle Turnpike, P.O.Box 370, Manchester, CT 06045



Analysis Report

July 20, 2021

FOR: Attn: Mr. Bob Woodstead
Better Water Well Systems
348 Smith Ridge Rd
South Salem, NY 10590

Sample Information

Matrix: DRINKING WATER
Location Code: BWWS
Rush Request: Standard
P.O.#:

Custody Information

Collected by:
Received by: B
Analyzed by: see "By" below

Date

07/13/21
07/13/21

Time

7:03
15:33

Laboratory Data

SDG ID: GCI72882
Phoenix ID: CI72982

Project ID: KLSD JOHN JAY HIGH SCHOOL
Client ID: SK#242

Parameter	Result	RL/ PQL	DIL	Units	AL	MCL	MCLG	Date/Time	By	Reference
Lead	0.0034	0.0005	2	mg/L	0.015			07/19/21	CPP	E200.8
Total Metal Digestion	Completed							07/14/21		E200.8

RL/PQL=Minimum Reportable Level DW MCL=Maximum Potability Limit Sec Goal=Recommended Potability Limit NA=Not Applicable

Phyllis Shiller, Lab Director
July 20, 2021

For further interpretation or recommendations on treatment, please contact your local or state health department. Please see last page for additional information.



Environmental Laboratories, Inc.
587 East Middle Turnpike, P.O.Box 370, Manchester, CT 06045



Analysis Report

July 20, 2021

FOR: Attn: Mr. Bob Woodstead
Better Water Well Systems
348 Smith Ridge Rd
South Salem, NY 10590

Sample Information

Matrix: DRINKING WATER
Location Code: BWWS
Rush Request: Standard
P.O.#:

Custody Information

Collected by:
Received by: B
Analyzed by: see "By" below

Date

07/13/21
07/13/21

Time

7:04
15:33

Laboratory Data

SDG ID: GCI72882
Phoenix ID: CI72983

Project ID: KLSD JOHN JAY HIGH SCHOOL
Client ID: SK#243

Parameter	Result	RL/ PQL	DIL	Units	AL	MCL	MCLG	Date/Time	By	Reference
Lead	0.0053	0.0005	2	mg/L	0.015			07/19/21	CPP	E200.8
Total Metal Digestion	Completed							07/14/21		E200.8

RL/PQL=Minimum Reportable Level DW MCL=Maximum Potability Limit Sec Goal=Recommended Potability Limit NA=Not Applicable

Phyllis Shiller, Lab Director
July 20, 2021

For further interpretation or recommendations on treatment, please contact your local or state health department. Please see last page for additional information.



Environmental Laboratories, Inc.
587 East Middle Turnpike, P.O.Box 370, Manchester, CT 06045



Analysis Report

July 20, 2021

FOR: Attn: Mr. Bob Woodstead
Better Water Well Systems
348 Smith Ridge Rd
South Salem, NY 10590

Sample Information

Matrix: DRINKING WATER
Location Code: BWWS
Rush Request: Standard
P.O.#:

Custody Information

Collected by:
Received by: B
Analyzed by: see "By" below

Date

07/13/21
07/13/21

Time

7:08
15:33

Laboratory Data

SDG ID: GC172882
Phoenix ID: C172984

Project ID: KLSJ JOHN JAY HIGH SCHOOL
Client ID: F+N#244

Parameter	Result	RL/ PQL	DIL	Units	AL	MCL	MCLG	Date/Time	By	Reference
Lead	< 0.0005	0.0005	2	mg/L	0.015			07/19/21	CPP	E200.8
Total Metal Digestion	Completed							07/14/21		E200.8

RL/PQL=Minimum Reportable Level DW MCL=Maximum Potability Limit Sec Goal=Recommended Potability Limit NA=Not Applicable

Phyllis Shiller, Lab Director
July 20, 2021

For further interpretation or recommendations on treatment, please contact your local or state health department. Please see last page for additional information.



Environmental Laboratories, Inc.
587 East Middle Turnpike, P.O.Box 370, Manchester, CT 06045



Analysis Report

July 20, 2021

FOR: Attn: Mr. Bob Woodstead
Better Water Well Systems
348 Smith Ridge Rd
South Salem, NY 10590

Sample Information

Matrix: DRINKING WATER
Location Code: BWWS
Rush Request: Standard
P.O.#:

Custody Information

Collected by:
Received by: B
Analyzed by: see "By" below

Date

07/13/21
07/13/21

Time

7:08
15:33

Laboratory Data

SDG ID: GC172882
Phoenix ID: C172985

Project ID: KLSD JOHN JAY HIGH SCHOOL
Client ID: BF#244A

Parameter	Result	RL/ PQL	DIL	Units	AL	MCL	MCLG	Date/Time	By	Reference
Lead	< 0.0005	0.0005	2	mg/L	0.015			07/19/21	CPP	E200.8
Total Metal Digestion	Completed							07/14/21		E200.8

RL/PQL=Minimum Reportable Level DW MCL=Maximum Potability Limit Sec Goal=Recommended Potability Limit NA=Not Applicable

Phyllis Shiller, Lab Director
July 20, 2021

For further interpretation or recommendations on treatment, please contact your local or state health department. Please see last page for additional information.



PHOENIX
Environmental Laboratories, Inc.

NY/NJ CHAIN OF CUSTODY RECORD

567 East Middle Turnpike, P.O. Box 370, Manchester, CT 06040
Email: info@phoenixlabs.com Fax (860) 645-0823

Client Services (860) 645-8726

Temp 1.0 Pg of

Data Delivery: ☐ Fax #: ☐ Email: ☒ BWWS@online.net

Customer: Better Water Well Systems
Address: 348 Smith Ridge Rd
South Salem, NY 10590

Project: KLSD - John Jay High School
Report to: BWWS
Invoice to: BWWS
60 North Salem Road
Cross River, NY 10518

Project P.O.:
Phone #: 914-533-6814
Fax #: 914-533-6451

Client Sample - Information / Identification

Sampler's Signature: *[Signature]* Date: 7/13/21

Matrix Code: DW=drinking water WW=wastewater S=soil/solid O=oil
GW=groundwater SL=siludge A=air X=other

Phoenix Sample #	Customer Sample Identification	Sample Matrix	Date Sampled	Time Sampled
72882	SK # 1	DW	7/13/21	410
72883	FN # 2	DW	7/13/21	413
72884	BF # 2A	DW	7/13/21	415
72885	FN # 7	DW	7/13/21	422
72886	BF # 7A	DW	7/13/21	423
72887	SK # 89	DW	7/13/21	432
72888	SK # 90	DW	7/13/21	434
72889	SK # 91	DW	7/13/21	435
72890	SK # 92	DW	7/13/21	437
72891	FN # 92A	DW	7/13/21	438
72892	BF # 92B	DW	7/13/21	439
72893	SK # 93	DW	7/13/21	441

Analysis Request

<input checked="" type="checkbox"/>	Westchester Profile
<input checked="" type="checkbox"/>	Total Coliform
<input checked="" type="checkbox"/>	Lead
<input checked="" type="checkbox"/>	Nitrate/Nitrite
<input checked="" type="checkbox"/>	Profile
<input checked="" type="checkbox"/>	Radon
<input checked="" type="checkbox"/>	Sodium
<input checked="" type="checkbox"/>	Chloride
<input checked="" type="checkbox"/>	TOC
<input checked="" type="checkbox"/>	PFOS, PFAS
<input checked="" type="checkbox"/>	Dioxane 14
<input checked="" type="checkbox"/>	40 ml VOA Vial [] As is [] HCl
<input checked="" type="checkbox"/>	GL Amber 1000ml [] As is [] H2SO4
<input checked="" type="checkbox"/>	PL As is [] 250ml [] 500ml [] 1000ml
<input checked="" type="checkbox"/>	PL H2SO4 [] 250ml [] 500ml
<input checked="" type="checkbox"/>	PL HNO3 250ml
<input checked="" type="checkbox"/>	PL NaOH 250ml
<input checked="" type="checkbox"/>	Bacteria Bottle

Relinquished by: *[Signature]*

Accepted by: *[Signature]*

Date: 7.13.21

Time: 1215

Comments, Special Requirements or Regulations: *[Handwritten notes]*

Turnaround:	NU	NY	Data Format:
<input type="checkbox"/> 1 Day*	<input type="checkbox"/> Res. Criteria	<input type="checkbox"/> TAGM 4046 GW	<input type="checkbox"/> Phoenix Std Report
<input type="checkbox"/> 2 Days*	<input type="checkbox"/> Non-Res. Criteria	<input type="checkbox"/> TAGM 4046 SOIL	<input type="checkbox"/> Excel
<input type="checkbox"/> 3 Days*	<input type="checkbox"/> Impact to GW Soil	<input type="checkbox"/> NY375 Unrestricted Soil	<input type="checkbox"/> PDF
<input type="checkbox"/> Standard	<input type="checkbox"/> Cleanup Criteria	<input type="checkbox"/> NY375 Residential Soil	<input type="checkbox"/> GIS/Key
<input type="checkbox"/> Other	<input type="checkbox"/> GW Criteria	<input type="checkbox"/> NY375 Restricted Non-Residential Soil	<input type="checkbox"/> EQUIS
<input type="checkbox"/> SURCHARGE APPLIES			<input type="checkbox"/> NY Hazmat EDD
			<input type="checkbox"/> NY EZ EDD (ASP)
			<input type="checkbox"/> Other

State Where Samples were Collected: _____

Data Package:
☐ NU Reduced Deliv. *
☐ NY Enhanced (ASP B) *
☐ Other



NY/NJ CHAIN OF CUSTODY RECORD
587 East Middle Turnpike, P.O. Box 370, Manchester, CT 06040
Email: info@phoenixlabs.com Fax (860) 645-0823
Client Services (860) 645-8726

Temp 1.0 Pg of
Data Delivery:
☐ Fax #:
☒ Email: BWWS@optonline.net

Customer: **Better Water Well Systems**
Address: **348 Smith Ridge Rd**
South Salem, NY 10590
Project: **KLSD - John Jay High School**
Report to: **BWWS** 60 North Salem Road
Invoice to: **BWWS** Cross River, NY 10518
Project P.O.:
Phone #: **914-533-6814**
Fax #: **914-533-6451**

Sampler's Signature: *[Signature]* Date: **7/13/21**
Client Sample - Information Identification

Matrix Code:
DW=drinking water SL=sludge S=soil/solid O=oil
GW=groundwater A=air X=other

Phoenix Sample #	Customer Sample Identification	Sample Matrix	Date Sampled	Time Sampled	Analysis Request	Westchester Profile	Total Coliform	Lead	Nitrate/Nitrite	Radon	Sodium	Chloride	TOC	PFOS, PFAS	Dioxane 14	40 ml VOA Vial	GL Amber 1000ml	PL As is	PL H2SO4	PL HNO3	PL NaOH	Bacteria Bottle
72894	SK # 94	dw	7/13/21	448	X											X	X	X				
72895	SK # 95	dw	7/13/21	443	X											X	X					
72896	SK # 96	dw	7/13/21	447	X											X	X					
72897	SK # 97	dw	7/13/21	448	X											X	X					
72898	SK # 98	dw	7/13/21	449	X											X	X					
72899	SK # 99	dw	7/13/21	450	X											X	X					
72900	SK # 100	dw	7/13/21	451	X											X	X					
72901	SK # 101	dw	7/13/21	452	X											X	X					
72902	SK # 102	dw	7/13/21	453	X											X	X					
72903	SK # 103	dw	7/13/21	454	X											X	X					
72904	SK # 104	dw	7/13/21	457	X											X	X					
72905	SK # 104A	dw	7/13/21	458	X											X	X					

Refinished by: *[Signature]* Date: **7/13/21** Time: **12:15**
Accepted by: *[Signature]* Date: **7/13/21** Time: **14:00**
[Signature] Date: **7/13/21** Time: **15:33**

Comments, Special Requirements or Regulations:

Turnaround: ☐ 1 Day* ☐ 2 Days* ☐ 3 Days* ☐ Standard ☐ Other

NY ☐ Res. Criteria ☐ Non-Res. Criteria ☐ Impact to GW Soil Cleanup Criteria ☐ GW Criteria

NY ☐ TAGM 4046 GW ☐ TAGM 4046 SOIL ☐ NY375 Unrestricted Soil ☐ NY375 Residential Soil ☐ NY375 Restricted Non-Residential Soil

Data Package: ☐ Phoenix Std Report ☐ Excel ☐ PDF ☐ GIS/Key ☐ EQUIS ☐ NY Hazmat EDD ☐ NY EZ EDD (ASP) ☐ Other

State Where Samples were Collected: _____

Data Package: ☐ NY Reduced Deliv. * ☐ NY Enhanced (ASP B) * ☐ Other



NY/NJ CHAIN OF CUSTODY RECORD
587 East Middle Turnpike, P.O. Box 370, Manchester, CT 06040
Email: info@phoenixlabs.com Fax (860) 645-0823
Client Services (860) 645-8726

Temp 1.0 Pg of
Data Delivery:
☐ Fax #
☒ Email: BWMS@optonline.net

Customer: Better Water Well Systems
Address: 348 Smith Ridge Rd
South Salem, NY 10590
Project: K.L.S.D. - John Jay High School
Report to: BWMS
Invoice to: BWMS
Cross River, NY 10518
Project P.O.:
Phone #: 914-533-6814
Fax #: 914-533-6451

Sampler's Signature: *[Signature]* Date: 7/13/21
Client Sample - Information - Identification

Matrix Code:
DW=drinking water SL=siludge S=soil/solid O=oil
GW=groundwater A=air X=other

Phoenix Sample #	Customer Sample Identification	Sample Matrix	Date Sampled	Time Sampled	Analysis Request
7A900	F+N #105	dw	7/13/21	4:59	X
7A907	SK # 106	dw	7/13/21	5:01	X
7A908	SK # 106 A	dw	7/13/21	5:02	X
7A909	SK # 107	dw	7/13/21	5:05	X
7A910	SK # 114	dw	7/13/21	5:08	X
7A911	SK # 116	dw	7/13/21	5:09	X
7A912	SK # 117	dw	7/13/21	5:15	X
7A913	F+N # 118	dw	7/13/21	5:17	X
7A914	F+N # 122	dw	7/13/21	5:20	X
7A915	F+N # 123	dw	7/13/21	5:21	X
7A916	SK # 124	dw	7/13/21	5:22	X
7A917	SK # 125	dw	7/13/21	5:23	X

Relinquished by: *[Signature]* Accepted by: *[Signature]* Date: 7/13/21 Time: 12:15
7/13/21 14:00
7/13/21 15:33

Comments, Special Requirements or Regulations:
Turnaround: ☐ 1 Day* ☐ 2 Days* ☐ 3 Days* ☐ Standard
Other: ☐ Res. Criteria ☐ Non-Res. Criteria ☐ Impact to GW Soil ☐ Cleanup Criteria ☐ GW Criteria
NY: ☐ TAGM 4046 GW SOIL ☐ TAGM 4046 SOIL ☐ NY375 Unrestricted Soil ☐ NY375 Residential Soil ☐ NY375 Restricted Non-Residential Soil
Data Format: ☐ Phoenix Std Report ☐ Excel ☐ PDF ☐ GIS/Key ☐ EQUIS ☐ NJ HazMat EDD ☐ NY EZ EDD (ASP) ☐ Other

* SURCHARGE APPLIES
State Where Samples were Collected:
Data Package: ☐ NJ Reduced Deliv. * ☐ NY Enhanced (ASP B) * ☐ Other



Phoenix Environmental Laboratories, Inc.

NY/NJ CHAIN OF CUSTODY RECORD
587 East Middle Turnpike, P.O. Box 370, Manchester, CT 06040
Email: info@phoenixlabs.com Fax (860) 645-0823
Client Services (860) 645-8726

Temp 1.0 Pg of
Data Delivery:
☐ Fax #
☒ Email: BWWS@optonline.net

Customer: Better Water Well Systems
Address: 348 Smith Ridge Rd
South Salem, NY 10590

Project: KLSD - John Jay High School
Report to: BWWS
Invoice to: BWWS
60 North Salem Road
Cross River, NY 10518

Project P.O.:
Phone #: 914-533-6814
Fax #: 914-533-6451

Client Sample - Information - Identification
Date: 7/13/21

Matrix Code:
DW=drinking water
GW=groundwater
WW=wastewater
SL=sludge
A=air
S=soil/solid
O=oil
X=other

Analysis Request

Westchester Profile	
Total Coliform	
Lead	
Nitrate/Nitrite	
Profile	
Radon	
Sodium	
Chloride	
TOC	
PFOS, PFAS	
Dioxane 14	
40 ml VOA Vial	
GL Amber 1000ml	
PL As is	
PL H2SO4	
PL HNO3	
PL NaOH	
Bacteria Bottle	

Phoenix Sample #	Customer Sample Identification	Sample Matrix	Date Sampled	Time Sampled	Analysis Request
72918	FTN # 176	dw	7/13/21	5:29	X
72919	SK # 180	dw	7/13/21	5:31	X
72920	SK # 181	dw	7/13/21	5:34	X
72921	SK # 182	dw	7/13/21	5:34	X
72922	SK # 184	dw	7/13/21	5:36	X
72923	SK # 184A	dw	7/13/21	5:37	X
72924	SK # 184B	dw	7/13/21	5:38	X
72925	SK # 184C	dw	7/13/21	5:39	X
72926	SK # 183	dw	7/13/21	5:35	X
72927	SK # 185	dw	7/13/21	5:50	X
72928	SK # 186	dw	7/13/21	5:51	X
72929	SK # 187	dw	7/13/21	5:51	X

Refiniquished by: Accepted by: Date: 7/13/21 Time: 12:15
7/13/21 14:00
7/13/21 15:33

Turnaround: ☐ 1 Day* ☐ 2 Days* ☐ 3 Days* ☐ Standard ☐ Other
NJ ☐ Res. Criteria ☐ Non-Res. Criteria ☐ Impact to GW Soil ☐ Cleanup Criteria ☐ GW Criteria
NY ☐ TAGM 4046 GW ☐ TAGM 4046 SOIL ☐ NY375 Unrestricted Soil ☐ NY375 Residential Soil ☐ NY375 Restricted Non-Residential Soil
Data Format: ☐ Phoenix Std Report ☐ Excel ☐ PDF ☐ GIS/Key ☐ EQUIS ☐ NJ HazMat EDD ☐ NY EZ EDD (ASP) ☐ Other

State Where Samples were Collected:
Data Package: ☐ NJ Reduced Deliv. * ☐ NY Enhanced (ASP B) * ☐ Other



Phoenix Environmental Laboratories, Inc.

NY/NJ CHAIN OF CUSTODY RECORD

587 East Middle Turnpike, P.O. Box 370, Manchester, CT 06040
Email: info@phoenixlabs.com Fax (860) 645-0823

Client Services (860) 645-8726

Temp 1.0 Pg of

Data Delivery:

☐ Fax #:

☒ Email:

BWWS@optonline.net

Customer: Better Water Well Systems

Address: 348 Smith Ridge Rd

South Salem, NY 10590

Project: KLSO - John Jay High School

Report to: BWWS 60 North Salem Road

Invoice to: BWWS Cross River, NY 10518

Project P.O.:

Phone #: 914-533-6814

Fax #: 914-533-6451

Client Sample Information - Identification

Sample's Signature

Date: 7/13/21

Analysis Request

Matrix Code:
DW=drinking water
GW=groundwater
WW=wastewater
SL=silage
S=soil/solid
A=air
O=oil
X=other

Phoenix Sample #	Customer Sample Identification	Sample Matrix	Date Sampled	Time Sampled	Westchester Profile	Total Coliform	Lead	Nitrate/Nitrite	Radon	Sodium	Chloride	TOC	PFOS, PFAS	Dioxane 14	40 ml VOA Vial	GL Amber 100ml	PL As is	PL H2SO4	PL HNO3	PL NaOH	Bacteria Bottle
7A930	SK # 188	dw	7/13/21	5:53		X															
7A931	SK # 189	dw	7/13/21	5:54		X															
7A932	SK # 190	dw	7/13/21	5:54		X															
7A933	SK # 191	dw	7/13/21	5:59		X															
7A934	SK # 192	dw	7/13/21	6:00		X															
7A935	SK # 193	dw	7/13/21	6:01		X															
7A936	FTN # 194	dw	7/13/21	5:55		X															
7A937	SK # 195	dw	7/13/21	6:02		X															
7A938	SK # 196	dw	7/13/21	6:03		X															
7A939	SK # 197	dw	7/13/21	6:04		X															
7A940	SK # 198	dw	7/13/21	6:10		X															
7A941	SK # 199	dw	7/13/21	6:11		X															

Refinanced by:

Accepted by:

Date:

Time:

Turnaround:

NY

NY

Data Format:

Comments, Special Requirements or Regulations:

☐ 1 Day*
☐ 2 Days*
☐ 3 Days*
☐ Standard
☐ Other
☐ Res. Criteria
☐ Non-Res. Criteria
☐ Impact to GW Soil
☐ Cleanup Criteria
☐ GW Criteria
☐ TAGM 4046 GW
☐ TAGM 4046 SOIL
☐ NY375 Unrestricted Soil
☐ NY375 Residential Soil
☐ NY375 Restricted Non-Residential Soil

☐ Phoenix Std Report
☐ Excel
☐ PDF
☐ GIS/Key
☐ EQUIS
☐ NJ Hazmat EDD
☐ NY EZ EDD (ASP)
☐ Other

State Where Samples were Collected:

☐ NJ Reduced Deliv. *
☐ NY Enhanced (ASP B) *
☐ Other



NY/NJ CHAIN OF CUSTODY RECORD
587 East Middle Turnpike, P.O. Box 370, Manchester, CT 06040
Email: info@phoenixlabs.com Fax (860) 645-0823
Client Services (860) 645-8726

Temp 1.0 Pg of
Data Delivery:
☐ Fax #:
☒ Email: BWWS@optonline.net

Customer: Better Water Well Systems
Address: 348 Smith Ridge Rd
South Salem, NY 10590

Project: KLSD - John Jay High School
Report to: BWWS
Invoice to: BWWS
60 North Salem Road
Cross River, NY 10518

Project P.O.:
Phone #: 914-533-6814
Fax #: 914-533-6451

Client Sample Information - Identification
Date: 7/13/21

Matrix Code:
DW=drinking water
GW=groundwater
WW=wastewater
SL=siludge
A=air
S=soil/solid
O=oil
X=other

Analysis Request

Westchester Profile
Total Coliform
Lead
Nitrate/Nitrite
Profile
Radon
Sodium
Chloride
TOC
PFOS, PFAS
Dioxane 14
40 ml VOA Vial [] As is [] HCl
GL Amber 1000ml [] As is [] H2SO4
PL As is [] 1250ml [] 500ml []
PL H2SO4 [] 250ml [] 500ml []
PL HNO3 250ml [] 500ml []
PL NaOH 250ml [] 500ml []
Bacteria Bottle

Phoenix Sample #	Customer Sample Identification	Sample Matrix	Date Sampled	Time Sampled	Analysis Request
72942	FTN # 200	dw	7/13/21	6:13	X
72943	BF # 2008	dw	7/13/21	6:13	X
72944	SK # 201	dw	7/13/21	6:15	X
72945	SK # 202	dw	7/13/21	6:16	X
72946	SK # 203	dw	7/13/21	6:20	X
72947	SK # 205	dw	7/13/21	6:21	X
72948	SK # 206	dw	7/13/21	6:22	X
72949	SK # 207	dw	7/13/21	6:23	X
72950	SK # 208	dw	7/13/21	6:24	X
72951	SK # 209	dw	7/13/21	6:26	X
72952	SK # 209A	dw	7/13/21	6:27	X
72953	SK # 210	dw	7/13/21	6:27	X

Relinquished by: [Signature]
Accepted by: [Signature]
Date: 7.13.21
Time: 12:15
Date: 7.13.21
Time: 14:00
Date: 7.13.21
Time: 13:33

Turnaround:
☐ 1 Day
☐ 2 Days
☐ 3 Days
☐ Standard
☐ Other
NJ
☐ Res. Criteria
☐ Non-Res. Criteria
☐ Impact to GW Soil
☐ Cleanup Criteria
☐ GW Criteria
NY
☐ TAGM 4046 GW
☐ TAGM 4046 SOIL
☐ NY375 Unrestricted Soil
☐ NY375 Residential Soil
☐ NY375 Restricted Non-Residential Soil

* SURCHARGE APPLIES

State Where Samples were Collected:

Data Package
☐ NJ Reduced Deliv. *
☐ NY Enhanced (ASP B) *
☐ Other



NY/NJ CHAIN OF CUSTODY RECORD
587 East Middle Turnpike, P.O. Box 370, Manchester, CT 06040
Email: info@phoenixlabs.com Fax (860) 645-0823
Client Services (860) 645-8726

Temp 10 Pg 1 of 1
Data Delivery: ☐ Fax #
☒ Email: BWWS@optonline.net

Customer: Better Water Well Systems Project: KLSD - John Jay High School
Address: 348 Smith Ridge Rd Report to: BWWS 60 North Salem Road
South Salem, NY 10590 Invoice to: BWWS Cross River, NY 10518
Project P.O.: Phone #: 914-533-6814
Fax #: 914-533-6451

Client Sample - Information - Identification
Samples Signature: [Signature] Date: 7/13/21

Matrix Code:
DW=drinking water SL=siludge S=soil/solid O=oil
GW=groundwater A=air X=other

Phoenix Sample #	Customer Sample Identification	Sample Matrix	Date Sampled	Time Sampled	Analysis Request	Westchester Profile	Total Coliform	Lead	Nitrate/Nitrite Profile	Radon	Sodium Chloride	TOC	PFOS, PFAS	Dioxane 14	40 ml VOA Vial	GL Amber 1000ml	PL As is	PL H2SO4	PL HNO3	PL NaOH	Bacteria Bottle
72954	SL# 211	dw	7/13/21	6:28	X																
72955	SL# 212	dw	7/13/21	6:30	X																
72956	SL# 215	dw	7/13/21	6:34	X																
72957	SL# 216	dw	7/13/21	6:35	X																
72958	SL# 217	dw	7/13/21	6:36	X																
72959	SL# 218	dw	7/13/21	6:37	X																
72960	SL# 219	dw	7/13/21	6:38	X																
72961	SL# 220	dw	7/13/21	6:39	X																
72962	SL# 221	dw	7/13/21	6:41	X																
72963	SL# 222	dw	7/13/21	6:42	X																
72964	SL# 223	dw	7/13/21	6:43	X																
72965	SL# 224	dw	7/13/21	6:45	X																

Refiniquished by: [Signature] Accepted by: [Signature] Date: 7/13/21 Time: 12:15
[Signature] Date: 7/13/21 Time: 14:00
[Signature] Date: 7/13/21 Time: 15:33

Comments, Special Requirements or Regulations:

Turnaround: ☐ 1 Day* ☐ 2 Days* ☐ 3 Days* ☐ Standard ☐ Other

• SURCHARGE APPLIES

State Where Samples were Collected:

NY ☐ Res. Criteria ☐ Non-Res. Criteria ☐ Impact to GW Soil ☐ Cleanup Criteria ☐ GW Criteria

NY ☐ TAGM 4046 GW ☐ TAGM 4046 SOIL ☐ NY375 Unrestricted Soil ☐ NY375 Residential Soil ☐ NY375 Restricted Non-Residential Soil

Data Format: ☐ Phoenix Std Report ☐ Excel ☐ PDF ☐ GIS/Key ☐ EQUIS ☐ NJ HazMat EDD ☐ NY EZ EDD (ASP) ☐ Other

Data Package: ☐ NJ Reduced Deliv. * ☐ NY Enhanced (ASP B) * ☐ Other



Phoenix Environmental Laboratories, Inc.

NY/NJ CHAIN OF CUSTODY RECORD
587 East Middle Turnpike, P.O. Box 370, Manchester, CT 06040
Email: info@phoenixlabs.com Fax (860) 645-0823

Client Services (860) 645-8726

Temp 1.0 Pg of
Data Delivery: ☐ Fax # ☐ Email: ☒ BWWS@optonline.net

Customer: Better Water Well Systems
Address: 348 Smith Ridge Rd
South Salem, NY 10590

Project: KLSD - John Jay High School
Report to: BWWS
Invoice to: BWWS
Cross River, NY 10518

Project P.O.:
Phone #: 914-533-6814
Fax #: 914-533-6451

Sample's Signature: *[Signature]* Date: 7/13/21
Client Sample - Information - Identification

Matrix Code: DW=drinking water SL=siludge S=soil/solid A=air O=oil
GW=groundwater

Phoenix Sample #	Customer Sample Identification	Sample Matrix	Date Sampled	Time Sampled	Analysis Request
72966	SL# 225	dw	7/13/21	646	Westchester Profile Total Coliform Lead Nitrate/Nitrite Profile Radon Sodium Chloride TOC PFOS, PFAS Dioxane 14 40 ml VOA Vial GL Amber 1000ml PL As is PL H2SO4 PL HNO3 250ml PL NaOH 250ml Bacteria Bottle
72967	SL# 226	dw	7/13/21	646	X
72968	SL# 227	dw	7/13/21	647	X
72969	SL# 228	dw	7/13/21	648	X
72970	SL# 229	dw	7/13/21	648	X
72971	SL# 230	dw	7/13/21	649	X
72972	SL# 231	dw	7/13/21	650	X
72973	SL# 232	dw	7/13/21	652	X
72974	SL# 233	dw	7/13/21	653	X
72975	SL# 235	dw	7/13/21	654	X
72976	SL# 236	dw	7/13/21	655	X
72977	SL# 237	dw	7/13/21	658	X

Relinquished by: *[Signature]* Accepted by: *[Signature]* Date: 7/13/21 Time: 1215
7/13/21 14:00
7/13/21 1533

Comments, Special Requirements or Regulations:

Turnaround:	NY	NY	Data Format
<input type="checkbox"/> 1 Day*	<input type="checkbox"/> Res. Criteria	<input type="checkbox"/> TAGM 4046 GW	<input type="checkbox"/> Phoenix Std Report
<input type="checkbox"/> 2 Days*	<input type="checkbox"/> Non-Res. Criteria	<input type="checkbox"/> TAGM 4046 SOIL	<input type="checkbox"/> Excel
<input type="checkbox"/> 3 Days*	<input type="checkbox"/> Impact to GW Soil	<input type="checkbox"/> NY375 Unrestricted Soil	<input type="checkbox"/> PDF
<input type="checkbox"/> Standard	<input type="checkbox"/> Cleanup Criteria	<input type="checkbox"/> NY375 Residential Soil	<input type="checkbox"/> GIS/Key
<input type="checkbox"/> Other	<input type="checkbox"/> GW Criteria	<input type="checkbox"/> NY375 Restricted Non-Residential Soil	<input type="checkbox"/> NY HazMat EDD
			<input type="checkbox"/> NY EZ EDD (ASP)
			<input type="checkbox"/> Other

State Where Samples were Collected: _____

Data Package

☐ NU Reduced Deliv. *

☐ NY Enhanced (ASP B) *

☐ Other



Phoenix Environmental Laboratories, Inc.

NY/NJ CHAIN OF CUSTODY RECORD
587 East Middle Turnpike, P.O. Box 370, Manchester, CT 06040
Email: info@phoenixlabs.com Fax (860) 645-0823

Client Services (860) 645-8726

Temp 10 Pg 01 of 01
Data Delivery:
☐ Fax #:
☒ Email: BWMS@optonline.net

Customer: Better Water Well Systems
Address: 348 Smith Ridge Rd
South Salem, NY 10590

Project: KLSD - John Jay High School
Report to: BWWS
Invoice to: BWWS
60 North Salem Road
Cross River, NY 10518

Project P.O.:
Phone #: 914-533-6814
Fax #: 914-533-6451

Client Sample - Information - Identification
Sample's Signature: [Signature] Date: 7/13/21

Matrix Code:
DW=drinking water
GW=groundwater
WW=wastewater
SL=sludge
S=soil/solid
A=air
O=oil
X=other

Phoenix Sample #	Customer Sample Identification	Sample Matrix	Date Sampled	Time Sampled	Analysis Request	Westchester Profile	Total Coliform	Lead	Nitrate/Nitrite	Radon	Sodium	Chloride	TOC	PFOS, PFAS	Dioxane 1,4	40 ml VOA Vial	GL Amber 1000ml	PL As is	PL H2SO4	PL HNO3 250ml	PL NaOH 250ml	Bacteria Bottle
72978	SK # 238	dw	7/13/21	700	X																	
72979	SK # 239	dw	7/13/21	700	X																	
72980	SK # 240	dw	7/13/21	701	X																	
72981	SK # 241	dw	7/13/21	703	X																	
72982	SK # 242	dw	7/13/21	703	X																	
72983	SK # 243	dw	7/13/21	704	X																	
72984	FN # 244	dw	7/13/21	708	X																	
72985	BF # 244.A	dw	7/13/21	708	X																	

Relinquished by: [Signature] Accepted by: [Signature] Date: 7/13/21 Time: 1211
7/13/21 14:00
11/3/21 1533

Comments, Special Requirements or Regulations:

Turnaround: ☐ 1 Day* ☐ 2 Days* ☐ 3 Days* ☐ Standard ☐ Other
*SURCHARGE APPLIES
NJ ☐ Res. Criteria ☐ Non-Res. Criteria ☐ Impact to GW Soil ☐ Cleanup Criteria ☐ GW Criteria
NY ☐ TAGM 4046 GW ☐ TAGM 4046 SOIL ☐ NY375 Unrestricted Soil ☐ NY375 Residential Soil ☐ NY375 Restricted Non-Residential Soil
Data Format: ☐ Phoenix Std Report ☐ Excel ☐ PDF ☐ GIS/Key ☐ EQUIS ☐ NJ Hazmat EDD ☐ NY EZ EDD (ASP) ☐ Other

State Where Samples were Collected:

Data Package: ☐ NJ Reduced Deliv. * ☐ NY Enhanced (ASP B) * ☐ Other



CLIENT NOTIFICATION MCL / AL Exceedance

7/20/2021 1:19:08 PM

Sample Delivery Group: GCI72882

Location Code: BWWS

Project: KLSJ JOHN JAY HIGH SCHOOL

Phoenix ID	Client Id	Matrix	Rush	Parameter	Result	Units	Analysis Date	MCL	AL
CI72887	SK#89 C boys bath	DW		Lead	0.0194	mg/L	07/16/21 03:42		0.015
CI72903	SK#103 library 5 girls	DW		Lead	0.0178	mg/L	07/16/21 17:15		0.015
CI72904	SK#104 B-Boys bath	DW		Lead	0.0221	mg/L	07/16/21 17:18		0.015
CI72905	SK#104A	DW		Lead	0.0196	mg/L	07/16/21 17:21		0.015
CI72910	SK#114 K basement girls	DW		Lead	0.0389	mg/L	07/16/21 17:50		0.015
CI72911	SK#116 boys bath	DW		Lead	0.0236	mg/L	07/16/21 17:52		0.015
CI72913	F+N#118 Q bsmt Hall	DW		Lead	0.0462	mg/L	07/16/21 20:09		0.015
CI72918	F+N#176 Q 2nd Fl Hall	DW		Lead	0.0406	mg/L	07/16/21 20:35		0.015
CI72919	SK#180 A 204 back rm	DW		Lead	3.04	mg/L	07/16/21 23:22		0.015
CI72920	SK#181 A 203 boys bath	DW		Lead	0.0619	mg/L	07/16/21 20:40		0.015
CI72921	SK#182 A 203 boys bath	DW		Lead	0.0426	mg/L	07/16/21 20:42		0.015
CI72922	SK#184 A 203	DW		Lead	0.0159	mg/L	07/16/21 20:48		0.015
CI72926	SK#183 A 203 boys bath	DW		Lead	0.0395	mg/L	07/16/21 21:11		0.015
CI72930	SK#188 L bsmt-men	DW		Lead	0.0674	mg/L	07/16/21 21:21		0.015
CI72931	SK#189 L bsmt-men	DW		Lead	0.0155	mg/L	07/16/21 21:24		0.015
CI72934	SK#192 L 1st Fl Girls	DW		Lead	0.0272	mg/L	07/16/21 22:33		0.015
CI72939	SK#197 L 1st Fl. boys	DW		Lead	0.0193	mg/L	07/16/21 22:46		0.015
CI72940	SK#198 G mens bath	DW		Lead	0.0154	mg/L	07/16/21 23:02		0.015
CI72946	SK#203 Kitchen Serv.	DW		Lead	0.0227	mg/L	07/16/21 23:25		0.015
CI72948	SK#206 Kitchen Prep	DW		Lead	0.0308	mg/L	07/16/21 23:43		0.015
CI72949	SK#207 Kitchen Prep	DW		Lead	0.0159	mg/L	07/16/21 23:45		0.015
CI72956	SK#215 Nurse Exam	DW		Lead	0.0153	mg/L	07/17/21 00:34		0.015
CI72959	SK#218 main office-men	DW		Lead	0.0247	mg/L	07/17/21 00:42		0.015
CI72961	SK#220 main office boys	DW		Lead	0.0151	mg/L	07/17/21 01:00		0.015
CI72965	SK#224 Girls lke Rm office	DW		Lead	0.0163	mg/L	07/17/21 01:13		0.015
CI72969	SK#228 boy locker bath	DW		Lead	0.0316	mg/L	07/17/21 01:36		0.015

Contact: bwws, jason

Date: 7/20/2021 1:19:00 PM

Comments: emailed

Maximum Contaminant Level (MCL): The highest level of a contaminant that is allowed in drinking water. MCLs are enforceable standards.
Action Level (AL): The concentration of a contaminant which, if exceeded, triggers treatment or other requirements.



CLIENT NOTIFICATION MCL / AL Exceedance

7/20/2021 1:19:08 PM

Sample Delivery Group: GCI72882

Location Code: BWWS

Project: KLSD JOHN JAY HIGH SCHOOL

Phoenix ID	Client Id	Matrix	Rush	Parameter	Result	Units	Analysis Date	MCL	AL
CI72970	SK#229 <i>boys locker bath</i>	DW		Lead	0.0289	mg/L	07/17/21 01:39		0.015
CI72971	SK#230 <i>boys locker bath</i>	DW		Lead	0.0253	mg/L	07/17/21 01:41		0.015
CI72980	SK#240 <i>New Gym lobby mens</i>	DW		Lead	0.0187	mg/L	07/19/21 20:10		0.015

Contact:

Date:

Comments:

Maximum Contaminant Level (MCL): The highest level of a contaminant that is allowed in drinking water. MCLs are enforceable standards.
Action Level (AL): The concentration of a contaminant which, if exceeded, triggers treatment or other requirements.